

REVISIONS							
ZONE	SYM	DESCRIPTION	DATE	E.M.N. NO.	DRAFT	CHKD	APPD
	X1	G F H HOLES ADDED	2-5-65	X1	SLG		
C7	X2	DIM "G" WAS 13 31/64	2-5-65	X2	SLG		
G7	X3	4-19/32 WAS 4-21/32, 5/16 WAS 1/4	4-22-65	X3	SLG	KA	
		ORIGINAL RELEASE FOR PRODUCTION	12/21/65				ALG

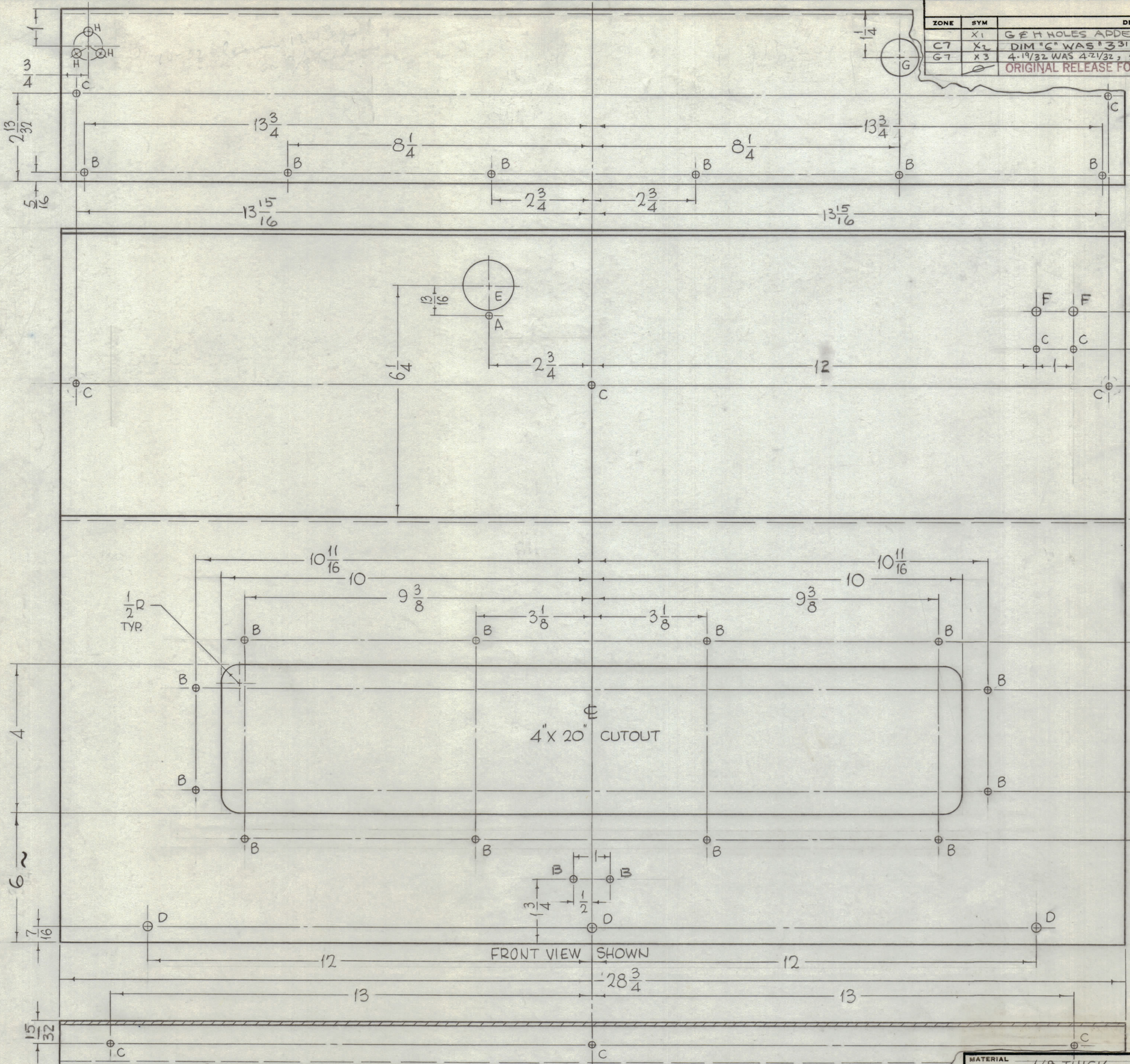

HOLES	REQ
* A - .166 ±.003 DIA.	1
B - 3/16 DIA.	20
C - 13/64 DIA.	10
D - 1/4 DIA.	3
* E - 1-7/16 DIA.	1
* F - 1/2 DIA.	2
G - 1" DIA.	1
H - 15/64 DIA. 120° APART ON A 3/8"-3	

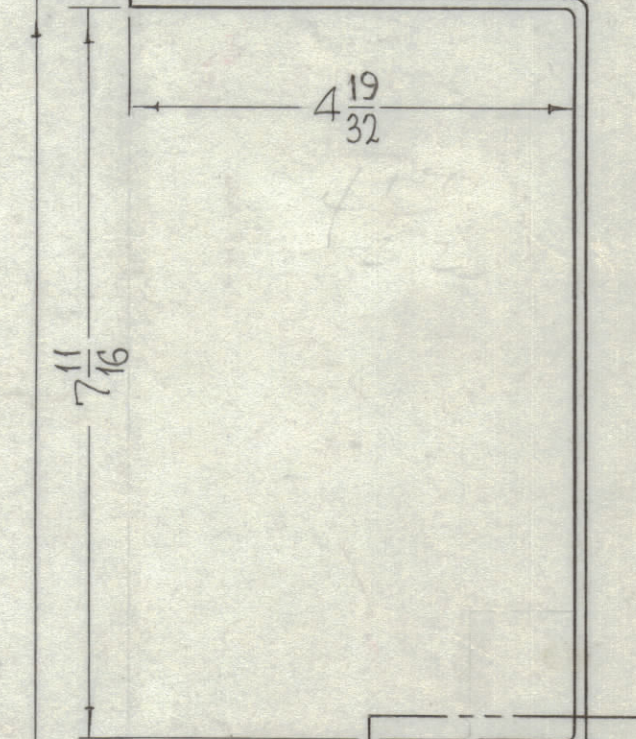

MS4206

METAL STAMP  
TMC PART NO.  
MS4206-  
1/8 HIGH  
GOTHIC WITH  
LATEST REV.  
LETTER ON  
REAR.

MS4206-1 (AS SHOWN)  
MS4206-2 (DELETE HOLES MARKED \*A,E,F)

REF-TMC DWG. NO. LD1689  
(FOR MS4206-1 ONLY)

- MACHINING:**
- MILL ALL EDGES.
  - HOLES MUST BE DRILLED, UNLESS OTHERWISE SPECIFIED.
  - LATERAL BOW OF PANEL MUST BE KEPT TO .031 TOLERANCE.
  - PANEL MUST BE FREE OF ALL MACHINING MARKS, GOUGES AND SCRATCHES. IF NECESSARY, SAND FRONT OF PANEL WITH NO. 120 GRIT SANDPAPER.
- FINISH NOTES:**
- S404 - IRIDITE 14-2 AL-COAT.
  - S114 - ZINC CHROMATE PRIMER) FRONT AND
  - S115 - SMOOTH GRAY ENAMEL ) EDGES ONLY

**NOTES**

THE CONTENTS OF THIS DRAWING ARE THE EXCLUSIVE PROPERTY OF THE TECHNICAL MATERIEL CORP. ITS UNAUTHORIZED USE OR REPRODUCTION IN WHOLE OR IN PART IS STRICTLY FORBIDDEN.

MATERIAL	1/8 THICK, ALUMINIUM, 5052-H32
FINISH	SEE NOTES
UNLESS OTHERWISE SPECIFIED DIMENSIONS ARE IN INCHES AND INCLUDE CHEMICALLY APPLIED OR PLATED FINISHES	
DECIMALS	FRACTIONS
X ± .05	± 1/64
.XX ± .01	ANGLES
.XXX ± .005	± 0° 30'

THE TECHNICAL MATERIEL CORP. MAMARONECK, NEW YORK			
TITLE PANEL, FRONT			
DRAWN John C Biele	DATE 1-19-65	FINAL APPROVAL [Signature]	DATE 12/21/65
CHECKED JCS	DATE 12/20/65	MS4206	
ELECT. DES.	DATE	SHEET	REV. LTR.
MECH. DES.	DATE		