

HOLES

A - .250 MIN., .253 MAX. DIA'S
FOR MTG. NT-129-1032-4

REQ.

3

DRILL .120 DIA.
THRU, C/SK
82° X .230 DIA.
(2 REQ)

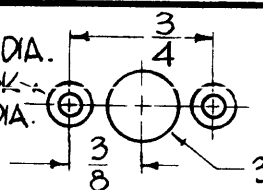

"B" DETAIL
2 REQ.

REVISIONS

SYM	DESCRIPTION	DATE	E.M.N. NO.	DRAFT	CHKD	APPD
○	ORIGINAL RELEASE FOR PRODUCTION	5/7/64				

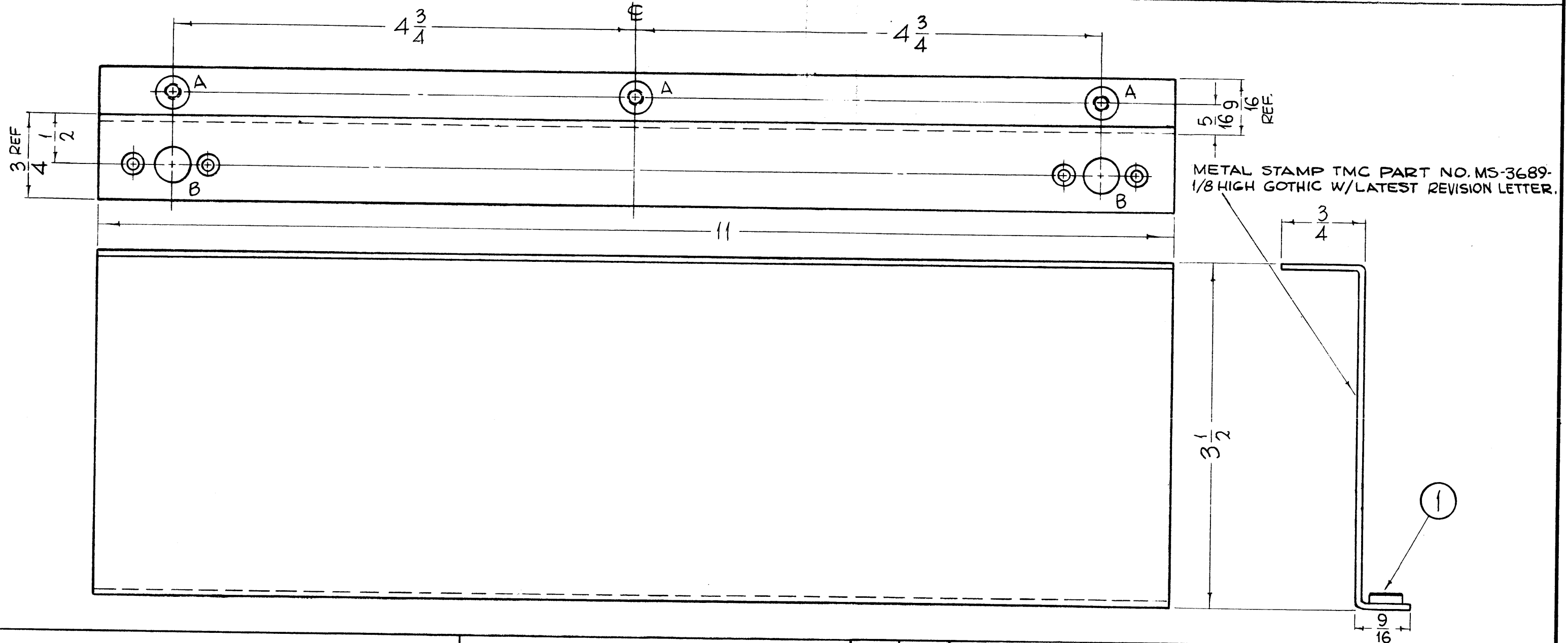

- UNLESS OTHERWISE SPECIFIED:**
1. USE MATERIAL THICKNESS FOR MAXIMUM RADIUS ON ALL BENDS.
 2. ALL ANGULAR BENDS 90°.
 3. REMOVE ALL BURRS AND SHARP EDGES.
 4. MOUNT INSERTS AFTER FINISHING.

NOTES

THE CONTENTS OF THIS DRAWING ARE THE EXCLUSIVE PROPERTY OF THE TECHNICAL MATERIEL CORP. ITS UNAUTHORIZED USE OR REPRODUCTION IN WHOLE OR IN PART IS STRICTLY FORBIDDEN.

REQ'D.	ITEM	PART NUMBER	DESCRIPTION	SYMBOL
3	1	NT-129-1032-4	NUT, ROUND, SWAGE TYPE	

LIST OF MATERIAL

MATERIAL: .064 THICK ALUMINUM, 5052 - H-32
FINISH: S404-IRIDITE, 14-2 AL-COAT
TITLE: BRACKET, SHIELD, MTG.
THE TECHNICAL MATERIEL CORP. MAMARONECK, NEW YORK

Q'TY./UNIT	MODEL USED ON	ASS'Y. NO.	SCALE	CODE	DECIMALS	TOLERANCES	FRACTIONS	DRAWN	DATE	CHECKED	DATE	DATE	DATE	DATE
2	GPT-10K()7(Ax505)		1"=1"	A	.X ± .05	± 1/64		John C. Biele	2-8-64	906	2/27/64			
					.XX ± .01	ANGLES								
					.XXX ± .005	± 0° 30'								

MS-3689-0
SHEET 1
REV. LTR.