

REQ. PER UNIT	USED ON		
	MODEL	ASS'Y. NO.	DATE
2	TER18K600BF		9 - 30 - 63
2	TER25K600BF		1 - 4 - 65

MS-3522 Ø

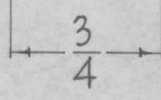
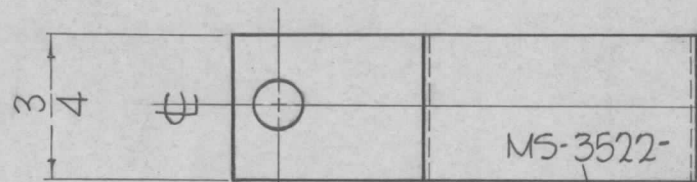

METAL STAMP TMC PART NO.  
1/8 HIGH GOTHIC.  
W/LATEST REV. LETTER

UNLESS OTHERWISE SPECIFIED:

1. USE MATERIAL THICKNESS FOR MAXIMUM RADIUS ON ALL BENDS.
2. ALL ANGULAR BENDS 90°.
3. REMOVE ALL BURRS AND SHARP EDGES.

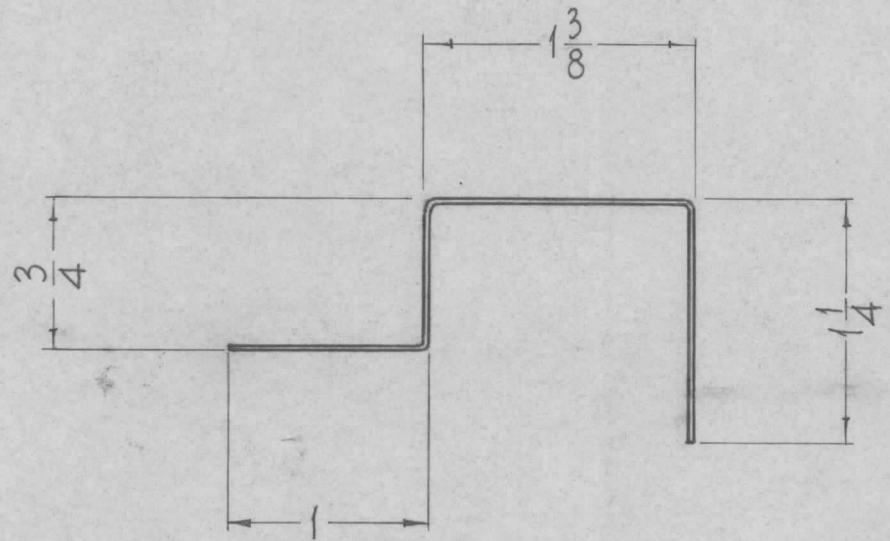

SYM	DESCRIPTION	DATE	CH. NO.	DRAFTS	CHECKER	ENG. APP.	REQ. ITEM	PART NO.	F. BUDETTI	DESCRIPTION	SYMBOL
Ø	ORIGINAL RELEASE FOR PRODUCTION	6-9-65	#	JC						THE TECHNICAL MATERIEL CORP. MAMARONECK, NEW YORK  STRAP, FORMED, COIL MTG.	Ø
X2	FINISH Ø MODEL ADDED	1-4-65		SRG			.030 THICK				
X1	TER18K600BF WAS TER15K600BF	1-13-64		SRG			STOCK SIZE				
							COPPER				
							MATERIAL				
UNLESS OTHERWISE SPECIFIED DIMENSIONS ARE IN INCHES AND INCLUDE CHEMICALLY APPLIED OR PLATED FINISHES		SCALE		1" = 1"			SOFT		John C. Biele	PS.	
DECIMALS .X ± .05 .XX ± .01 .XXX ± .005	TOLERANCES	FRACTIONS ± 1/64 ANGLES ± 0° 30'	CODE				TYPE & TEMPER	HEAT TREAT. SPEC.	DRAWN	CHECKED	FINAL APPROVAL
							S245 SILVER PLATE				
							FINISH & SPEC. NO.		ELEC. DES. APP.	MECH. DES. APP.	MS-3522 Ø