

REVISIONS							
ZONE	SYM	DESCRIPTION	DATE	E.M.N. NO.	DRAFT	CHKD	APPD
	0	ORIGINAL RELEASE FOR PRODUCTION	3-2-64		A.M.		

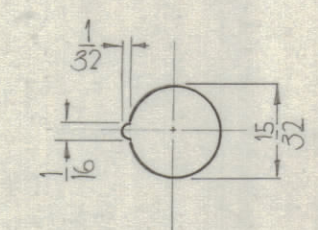
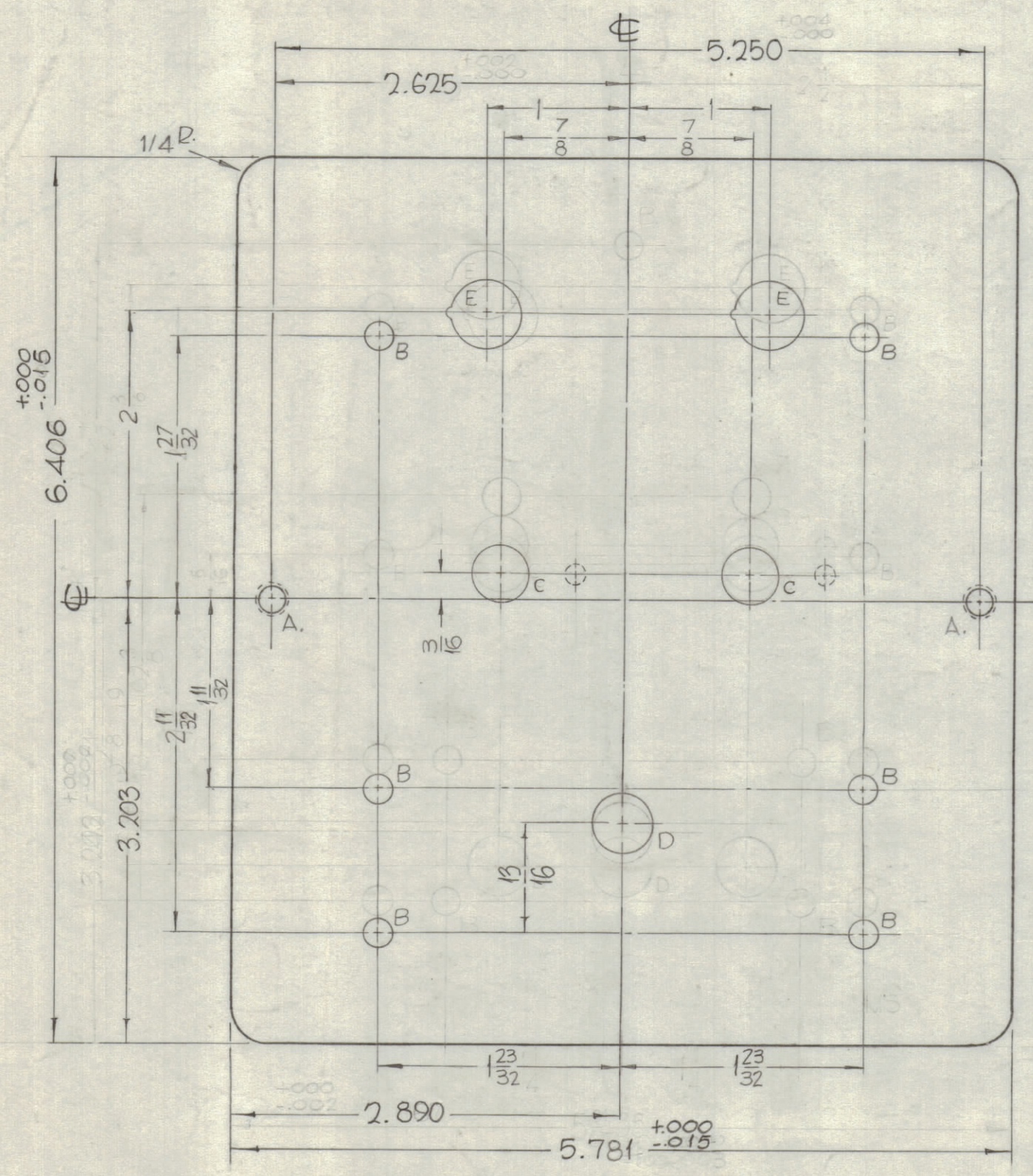

DETAIL-E (2) REQ.

HOLES

- A- DRILL & TAP FOR 8-32 (2) REQ.
- B- 3/16 DIA. (6) REQ.
- C- SEE DETAIL C
- D- 13/32 DIA. (1) REQ.
- E- SEE DETAIL E

METAL STAMP TMC NO. MS-3266-0, 1/8 GOTHIC ON REAR.

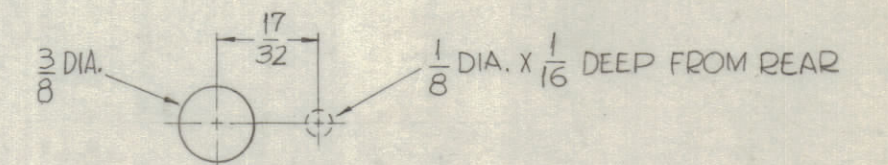

C-DETAIL (2 REQ.)

REF - TMC DWG. LD-1251

NOTES

- 1- LATERAL BOW OF PANEL MUST BE KEPT TO .031 TOL.
- 2- MILL ALL EDGES +0 -.003
- 3- HOLES MUST BE DRILLED
- 4- PANEL MUST BE FREE OF ALL MACHINING MARKS, GOUGES & SCRATCHES. IF NECESSARY SAND FRONT OF PANEL WITH NO. 120 GRIT SANDPAPER

FINISH

- 1- S404 IRIDITE
- 2- S114 ZINC CHROMATE PRIMER FRONT AND EDGES ONLY.
- 3- S115 TMC SMOOTH GRAY ENAMEL

QTY./UNIT	MODEL USED ON	ASSY. NO.
1	GPT-200K	AZ-101
SCALE	CODE	
1:1	A	

THE CONTENTS OF THIS DRAWING ARE THE EXCLUSIVE PROPERTY OF THE TECHNICAL MATERIEL CORP. ITS UNAUTHORIZED USE OR REPRODUCTION IN WHOLE OR IN PART IS STRICTLY FORBIDDEN.

REQ'D.	ITEM	PART NUMBER	DESCRIPTION	SYMBOL
	F. BUDETTI		LIST OF MATERIAL	
MATERIAL		THE TECHNICAL MATERIEL CORP. MAMARONECK, NEW YORK		
1/8 THICK, ALUMINUM		TITLE		
SEE NOTES		PANEL, FRONT (SWD-DETUNE)		
FINISH		DRAWN	DATE	FINAL APPROVAL
		J.F. VITRO	2/11/64	RAC
UNLESS OTHERWISE SPECIFIED DIMENSIONS ARE IN INCHES AND INCLUDE CHEMICALLY APPLIED OR PLATED FINISHES		CHECKED	DATE	
		J.P.	2/11/64	
DECIMALS		ELECT. DES.	DATE	
.X ± .05		J.P.	2/11/64	
.XX ± .01		MECH. DES.	DATE	
.XXX ± .005		J.P.		
FRACTIONS		MS-3266		
± 1/64		SHEET		
ANGLES		REV. LTR.		
± 0° 30'				

NOTES