

MS-3226 Ø

REVISIONS						
SYM	DESCRIPTION	DATE	E.M.N. NO.	DRAFT	CHKD	APFD
Ø	ORIGINAL RELEASE FOR PRODUCTION	5-18-64		SRG		

HOLES —
 A - 11/64 DIA. 3 REQ.
 B - .250 MIN., .253 MAX. 4 REQ.

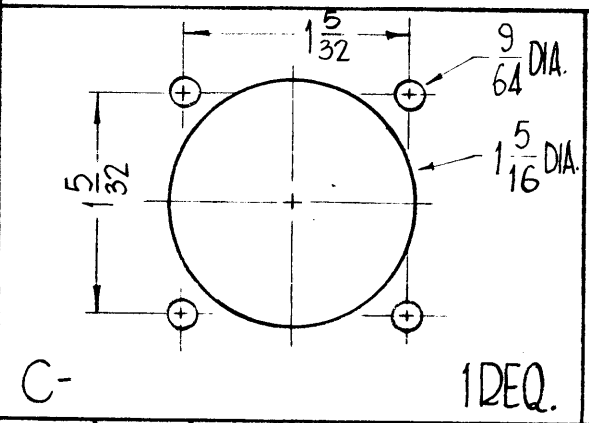

REQ'D.	ITEM	PART NUMBER	DESCRIPTION	SYMBOL
4	1	NT-129-1032-6	NUT, ROUND SWAGE TYPE	

F. BUDETTI		LIST OF MATERIAL	
MATERIAL 1/8 THICK, ALUMINUM, 5052-H-32		THE TECHNICAL MATERIEL CORP. MAMARONECK, NEW YORK	
FINISH S404-IRIDITE		TITLE BRACKET, CONN. MTG.	

UNLESS OTHERWISE SPECIFIED
 USE MAT'L THICKNESS MAX. RADIUS ON ALL BENDS.
 MOUNT INSERTS AFTER FINISHING.
 ALL BENDS 90°.

NOTES

1	GPT-200K	AX-395
QTY./UNIT	MODEL USED ON	ASSY. NO.
SCALE 1"=1"	CODE A	

THE CONTENTS OF THIS DRAWING ARE THE EXCLUSIVE PROPERTY OF THE TECHNICAL MATERIEL CORP. ITS UNAUTHORIZED USE OR REPR. DUCTION IN WHOLE OR IN PART IS STRICTLY FORBIDDEN.

UNLESS OTHERWISE SPECIFIED
 DIMENSIONS ARE IN INCHES AND INCLUDE
 CHEMICALLY APPLIED OR PLATED FINISHES

DECIMALS .X ± .05 .XX ± .01 .XXX ± .005	TOLERANCES	FRACTIONS ± 1/64 AN LES ± 0° 30'
--	------------	---

DRAWN John C. Biele	DATE 1-11-63	FINAL APPROVAL [Signature]	DATE
CHECKED aa	DATE		

ELECT [Signature]	DATE 3/18/63	MS-3226	Ø
MECH [Signature]	DATE	SHEET	REV. LTR.