

REQ. PER. UNIT	USED ON			MS-2552
	MODEL	ASSY. NO.	DATE	
1	ACU		4-18-61	

A ~ $\frac{7}{32}$ DIA. 2 REQ.

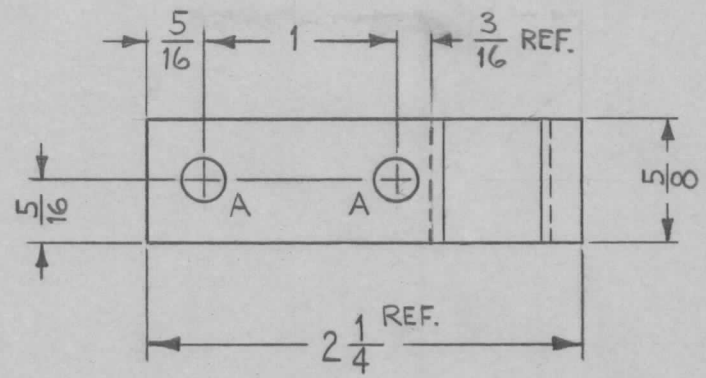
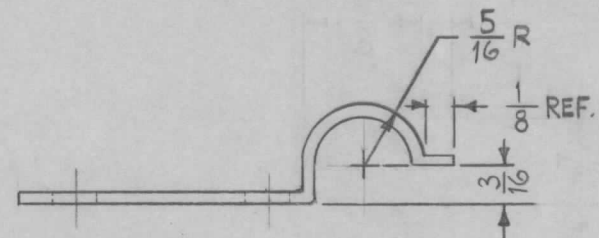

NOTE: (HEAT TREATMENT).
600° F FOR 2 HOURS IN CLOSED OVEN AFTER BENDING & MACHINING.

USE MATERIAL THICKNESS FOR MAX. RADIUS ON ALL BENDS UNLESS OTHERWISE SPECIFIED.

								REQ. ITEM	PART NO.	DESCRIPTION			SYMBOL
								.051		THE TECHNICAL MATERIEL CORP.			
								STOCK SIZE		MAMARONECK, NEW YORK			
								BERYLLIUM COPPER		CONTACT, WIPER			
								MATERIAL					
ISSUE	ITEM	CHANGED FROM	DATE	CH. NO.	DRAFTS	CHECKER	ENG. APP.	$\frac{1}{2}$ H	SEE NOTE	MAF	JL	203	
TOLERANCES			SCALE: FULL (DO NOT SCALE)					TYPE & TEMPER	HEAT TREAT. SPEC.	DRAWN	CHECKED	FINAL APPROVAL	
DEC. DIM. ±			MAXIMUM ALLOWABLE TOLERANCES HAVE BEEN DETERMINED AND ANY DEVIATIONS WILL BE CAUSE FOR REJECTION. REMOVE ALL BURRS AND SHARP EDGES					.000025 RHODIUM PLATE			aa	MS-2552	
FRAC. DIM. ± $\frac{1}{64}$								FINISH & SPEC. NO.		ELEC. DES. APP	MECH. DES. APP		
ANGULAR DIM. ±													