

REQ. PER. UNIT	USED ON			MS-2551	B
	MODEL	ASS'Y. NO.	DATE		
1	AO-100		4-18-61		

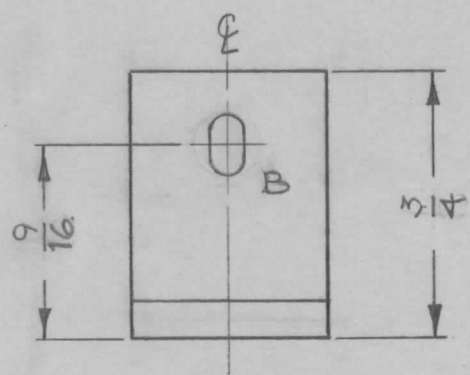

A ~  $\frac{11}{64}$  DIA. 1 REQ'D  
 B ~  $\frac{3}{16} \times \frac{1}{4}$  DIA SLOT 1 REQ'D

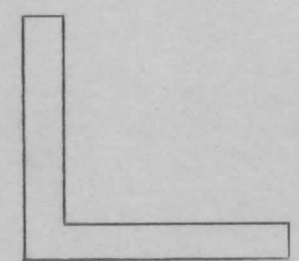
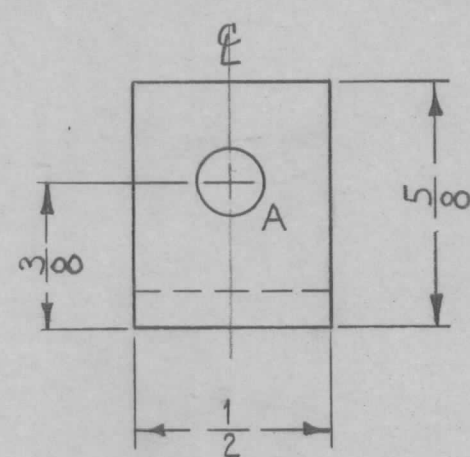

NOTE:  
 USE MATERIAL THICKNESS FOR MAX. RADIUS ON ALL BENDS UNLESS OTHERWISE SPECIFIED.

ISSUE	ITEM	CHANGED FROM	DATE	CH. NO.	DRAFTS	CHECKER	ENG. APP.	REQ.	ITEM	PART NO.	DESCRIPTION	SYMBOL				
B		B SLOT WAS 13/64 X 11/32 CHG'D 1/2 TO 9/16 & 11/16 TO 3/4	12-5-66	17395	RME	<i>[Signature]</i>				.081	THE TECHNICAL MATERIEL CORP.					
A	4	DIM. 19/32 WAS 1/2 - 1/8 WAS 11/16								STOCK SIZE	MAMARONECK, NEW YORK					
	3	CLARIFIED HOLE CHART.								ALUMINUM	CAPACITOR SUPPORT BRACKET					
	2	11/64 X 11/32 SLOT ADDED.								MATERIAL	(A-1000)					
	1	DEL. (1) 'A' HOLE								5052-H32						
TOLERANCES			SCALE: 1:2 (DO NOT SCALE)				TYPE & TEMPER		HEAT TREAT. SPEC.		DRAWN	CHECKED	FINAL APPROVAL			
DEC. DIM. ±			MAXIMUM ALLOWABLE TOLERANCES HAVE BEEN DETERMINED AND ANY DEVIATIONS WILL BE CAUSE FOR REJECTION. REMOVE ALL BURRS AND SHARP EDGES				S404 YELL. IRIDITE						MS-2551	B		
FRAC. DIM. ±							FINISH & SPEC. NO.		ELEC. DES. APP		MECH. DES. APP					
ANGULAR DIM. ±																