

REQ. PER. UNIT	USED ON			MS-2318	C
	MODEL	ASS'Y. NO.	DATE		
12	40K	AX-209	6-30-60		

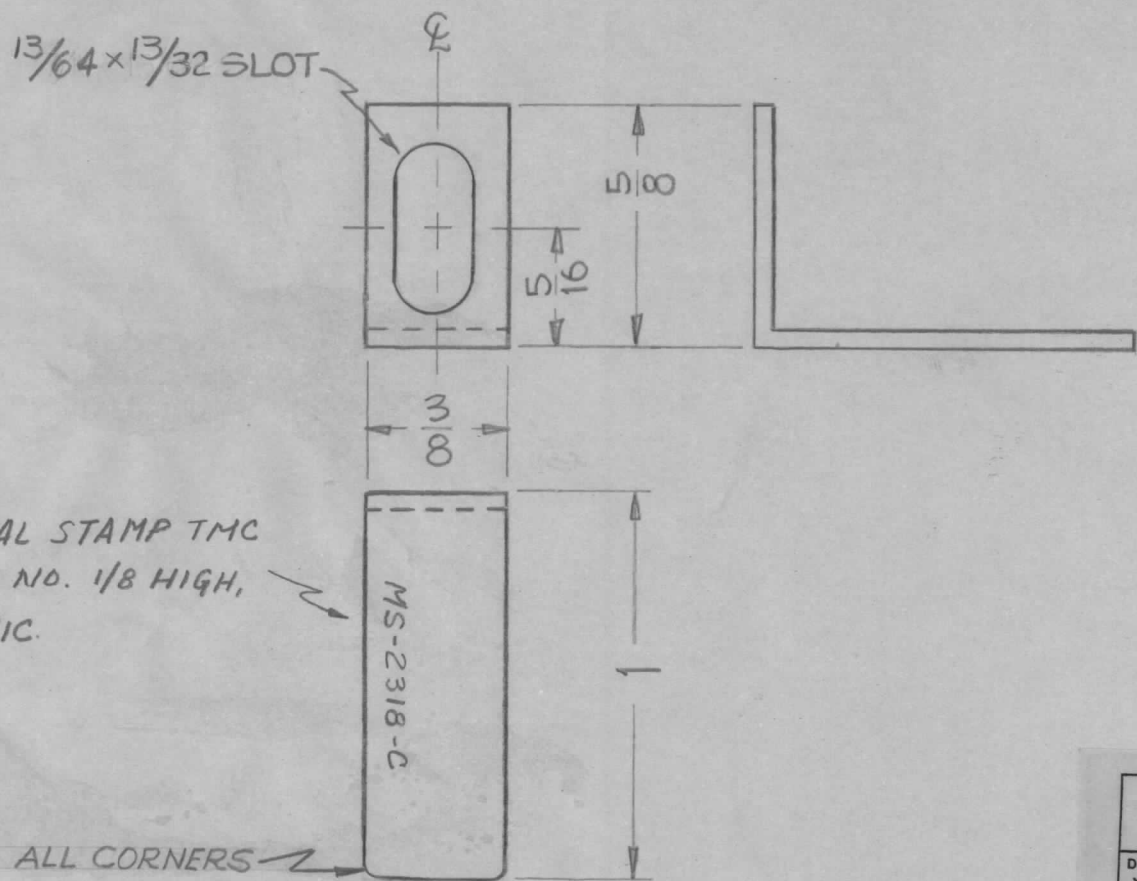

UNLESS OTHERWISE SPECIFIED
DIMENSIONS ARE IN INCHES AND INCLUDE
CHEMICALLY APPLIED OR PLATED FINISHES

DECIMALS	TOLERANCES	FRACTIONS
.X ± .05		± 1/64
.XX ± .01		ANGLES
.XXX ± .005		± 0° 30'

CUT HERE
GUARANTEED
2-66

ISSUE	ITEM	CHANGED FROM	DATE	CH. NO.	DRAFTS	CHECKER	ENG. APP.	REQ. ITEM	PART NO.	DESCRIPTION	SYMBOL			
C	1	FINISH & SPEC WAS GOLD PLATE .000035	10-26-62	7513	GR	W.D.	W.D.		.031	THE TECHNICAL MATERIEL CORP. MAMARONECK, NEW YORK GRID CONNECTOR STRAP (FINAL TUBE)	MS-2318 C			
B	1	STOCK SIZE WAS .051	11-23-60	3507	W.A.F.	JCB	W.D.		STOCK SIZE					
A	2	ROUND CORNERS ADDED	8/22/60	2851	RU	JCB	W.D.		COPPER					
A	1	SLOT WAS 7/16 X 13/64							MATERIAL					
TOLERANCES			SCALE: DOUBLE SIZE											
DEC. DIM. ± FRAC. DIM. ± ANGULAR DIM. ±			MAXIMUM ALLOWABLE TOLERANCES HAVE BEEN DETERMINED AND ANY DEVIATIONS WILL BE CAUSE FOR REJECTION. REMOVE ALL BURRS AND SHARP EDGES							TYPE & TEMPER SILVER, PLATE S243 CLEAR IRIDITE S423	HEAT TREAT. SPEC.	DRAWN	CHECKED	FINAL APPROVAL
										FINISH & SPEC. NO.	ELEC. DES. APP	MECH. DES. APP		