

| | | | | |
|---------------|---------|------------|---------|---------|
| REQ. PER UNIT | USED ON | | | MS-1892 |
| | MODEL | ASS'Y. NO. | DATE | |
| 2 | GPT-10K | AX-138 | 9-17-59 | |

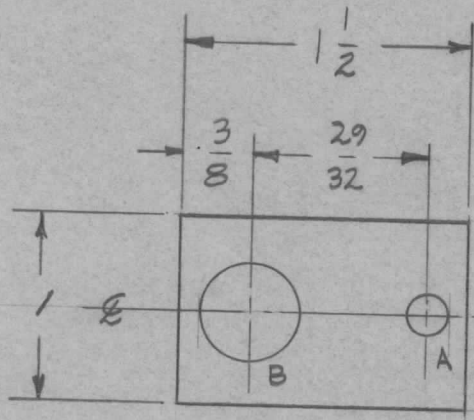

A - 11/64 (.171) DIA,

1 REQ'D.

B - 1/2 (.5) DIA

1 REQ'D.

UNLESS OTHERWISE SPECIFIED
DIMENSIONS ARE IN INCHES AND INCLUDE
CHEMICALLY APPLIED OR PLATED FINISHES

| | |
|-------------|-----------|
| DECIMALS | FRACTIONS |
| .X ± .05 | ± 1/64 |
| .XX ± .01 | ANGLES |
| .XXX ± .005 | ± 0° 30' |

CUT HERE
GUARANTEED
2-66

| ISSUE | ITEM | CHANGED FROM | DATE | CH. NO. | DRAFTS | CHECKER | ENG. APP. | REQ. | ITEM | PART NO. | DESCRIPTION | SYMBOL | | |
|---|------|--------------|---|---------|--------|---------|-----------|--------------------|------|-------------------|---|---------|----------------|--|
| | | | | | | | | | | .081 | THE TECHNICAL MATERIEL CORP. MAMARONECK, NEW YORK LUG, CAPACITOR GPT-10K | | | |
| | | | | | | | | | | STOCK SIZE | | | | |
| | | | | | | | | | | ALUMINUM | | | | |
| | | | | | | | | | | MATERIAL | | | | |
| TOLERANCES | | | SCALE: | | | | | TYPE & TEMPER | | HEAT TREAT. SPEC. | DRAWN | CHECKED | FINAL APPROVAL | |
| DEC. DIM. ± FRAC. DIM. ± ANGULAR DIM. ± | | | MAXIMUM ALLOWABLE TOLERANCES HAVE BEEN DETERMINED AND ANY DEVIATIONS WILL BE CAUSE FOR REJECTION. REMOVE ALL BURRS AND SHARP EDGES | | | | | S404-IRIDITE | | | | | | |
| | | | | | | | | FINISH & SPEC. NO. | | ELEC. DES. APP. | MECH. DES. APP. | MS-1892 | | |