

MS-1527A

A - 3/16 (.187) DIA.

2 REQ'D.

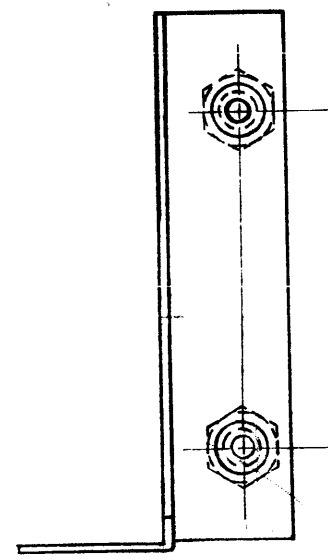
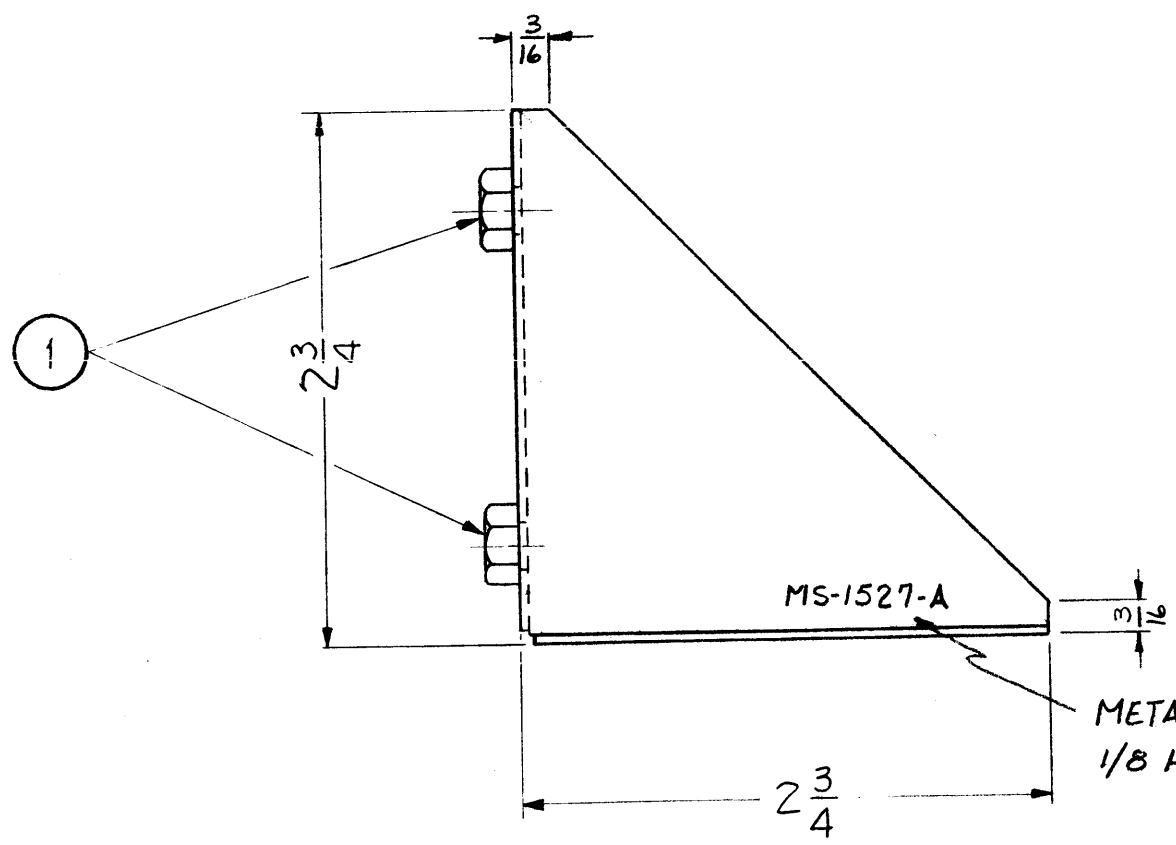
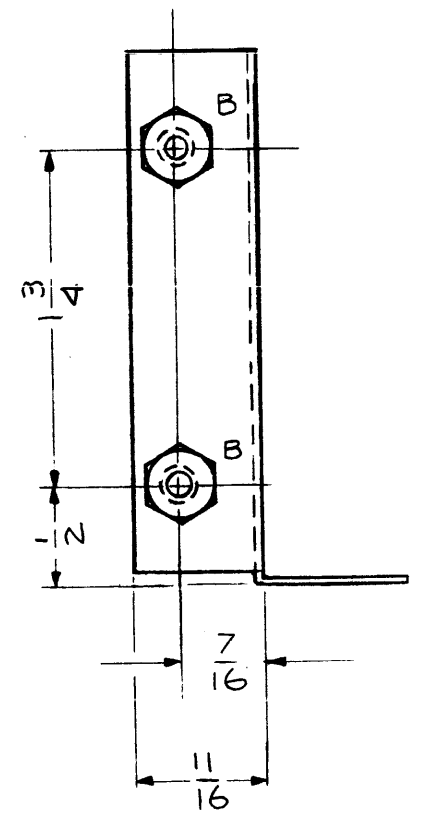
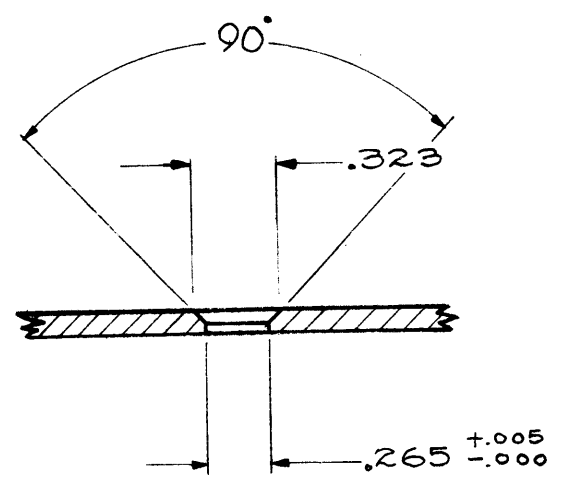
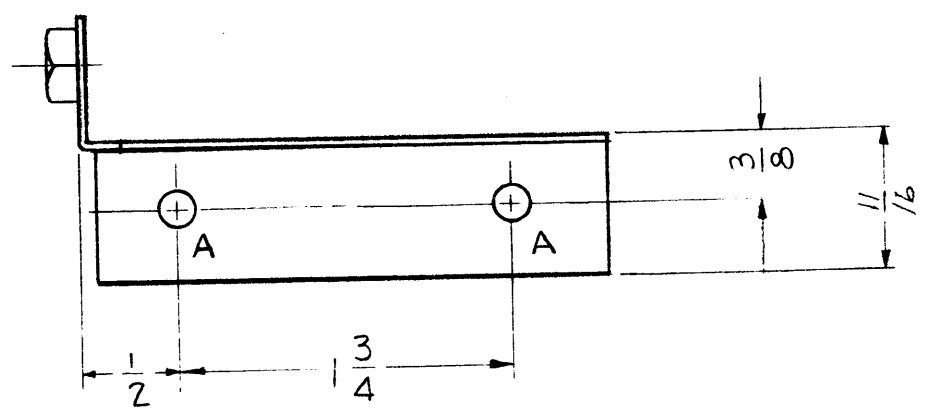

'B' DRILLING PLAN

NOTICE TO PERSONS RECEIVING THIS DRAWING  
 THE TECHNICAL MATERIEL CORPORATION claims proprietary right in the material disclosed hereon. This drawing is issued in confidence for engineering information only and may not be reproduced or used to manufacture anything shown hereon without permission from THE TECHNICAL MATERIEL CORPORATION to the user. This drawing is loaned for mutual assistance and is subject to recall at any time.

Property of:  
 THE TECHNICAL MATERIEL CORPORATION  
 MAMARONECK, NEW YORK

METAL STAMP TMC PART NO.  
 1/8 HIGH, GOTHIC.

ISSUE	ITEM	CHANGED FROM	DATE	CH. NO.	DRAFTS	CHECKER	ENG. APP.
Δ	1	3/16" NOTCH ADDED	10-12-62	7414			

TOLERANCES  
 DEC. DIM. ±  
 FRAC. DIM. ±  
 ANGULAR DIM. ±

SCALE:  
 MAXIMUM ALLOWABLE TOLERANCES HAVE BEEN DETERMINED AND ANY DEVIATIONS WILL BE CAUSE FOR REJECTION. REMOVE ALL BURRS AND SHARP EDGES

REQ. PER UNIT	MODEL	PROJECT NO.	ASSY. NO.	DATE
1	GPT-10K	P.S.		1-30-59

REQ.	ITEM	PART NO.	DESCRIPTION	SYMBOL
2	1	5M107-33	INSERT, HEXAGON	
		.064	THE TECHNICAL MATERIEL CORP. MAMARONECK, NEW YORK	
		ALUMINUM	RIGHT SIDE SUPPORT ZENER TERMINAL BOARD	
		5052-H32	J.C. BIELE	
		S-404 IRIDITE	LP	
			MS-1527A	