

MS-1512 C

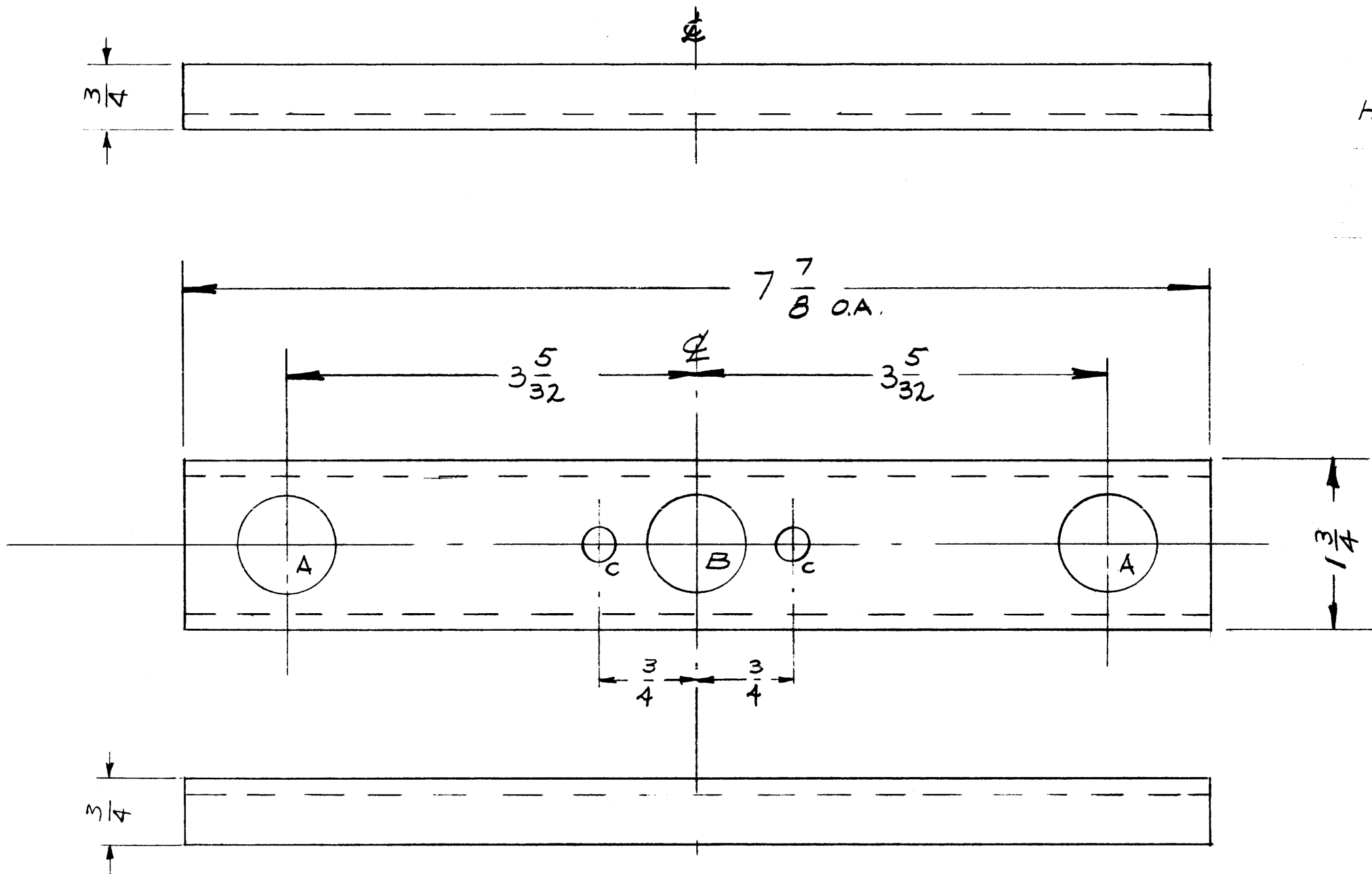

HOLES	REQ'D.
A - 5/8 DIA.	2
B - 3/4 DIA.	3
C - 1/4 DIA.	2

NOTICE TO PERSONS RECEIVING THIS DRAWING

THE TECHNICAL MATERIEL CORPORATION claims proprietary right in the material disclosed hereon. This drawing is issued in confidence for engineering information only and may not be reproduced or used to manufacture anything shown hereon without permission from THE TECHNICAL MATERIEL CORPORATION to the user. This drawing is loaned for mutual assistance and is subject to recall at any time.

Property of:
THE TECHNICAL MATERIEL CORPORATION
MAMARONECK, NEW YORK

ISSUE	ITEM	CHANGED FROM	DATE	CH. NO.	DRAFTS	CHECKER	ENG. APP.
C	1	DIM. 1 3/4 WAS 1 1/2	2/10/64	10881	A.M.	T.R.	ARB
B	1	DIM 7/16 on top & bottom view deleted	7-13-61	5233	GDL	JCB	DB
A	1	"A" Holes were 3/4 DIA Two "C" Holes Added	2/24/59		W.H.L.	Jde	DB

TOLERANCES		SCALE: FULL
DEC. DIM. ±	MAXIMUM ALLOWABLE TOLERANCES HAVE BEEN DETERMINED AND ANY DEVIATIONS WILL BE CAUSE FOR REJECTION.	
FRAC. DIM. ±	REMOVE ALL BURRS AND SHARP EDGES	
ANGULAR DIM. ±		

1	GPT-10K	AT-100		1-30-59
REQ. PER UNIT	MODEL	PROJECT N.	ASS'Y. NO.	DATE
USED ON				

REQ. ITEM	PART NO.	DESCRIPTION	SYMBOL
	1/8 THICK STOCK SIZE	THE TECHNICAL MATERIEL CORP. MAMARONECK, NEW YORK	
	ALUMINUM	CORE, GUIDE	
		ANTENNA, TUNER	
5052-H32		IRIDITE IRIDITE	ARB
		DRAWN	CHECKED
			FINAL APPR VAL
			MS-1512 C
		ELEC. DES. APP.	MECH. DES. APP.