

IF IT IS FOUND DESIRABLE TO CHANGE ANY TOLERANCE OR OTHER DETAIL SPECIFIED ON THIS DRAWING NOTIFY THE PURCHASER PROMPTLY.

MAXIMUM ALLOWABLE TOLERANCES HAVE BEEN DETERMINED AND DEVIATIONS WILL BE CAUSE FOR REJECTION. REMOVE ALL BURRS AND SHARP EDGES

RELEASED

MS-158

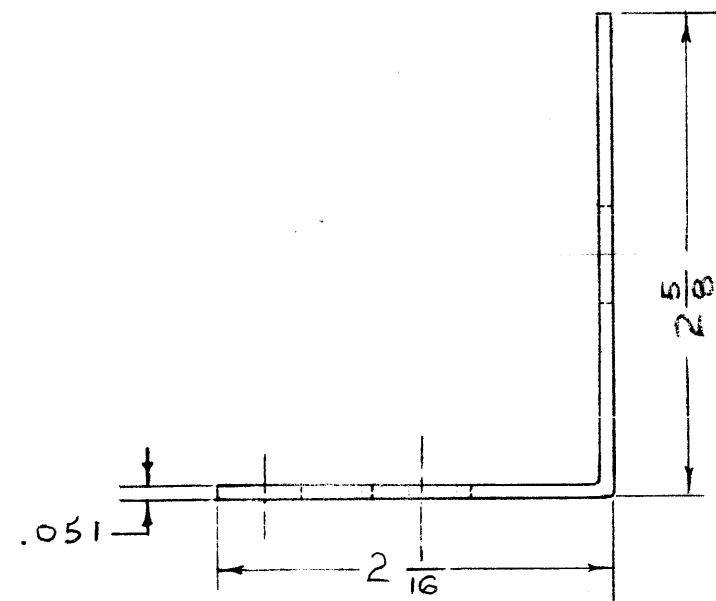
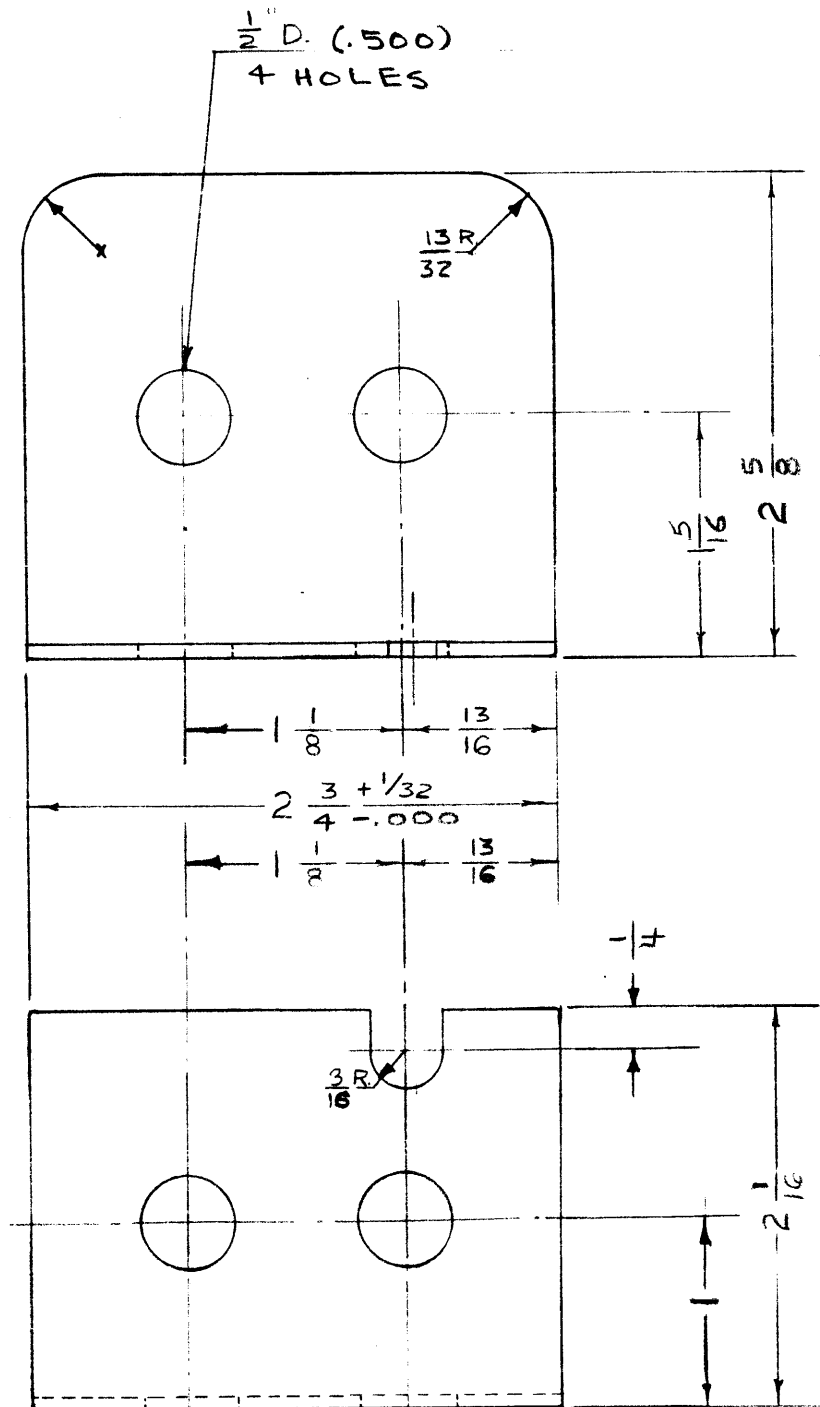

**NOTICE TO PERSONS RECEIVING THIS DRAWING**

THE TECHNICAL MATERIEL CORPORATION claims proprietary right in the material disclosed herein. This drawing is issued in confidence for engineering information only and may not be reproduced or used to manufacture anything shown hereon without permission from THE TECHNICAL MATERIEL CORPORATION to the user. This drawing is loaned for mutual assistance and is subject to recall at any time.

Property of:  
THE TECHNICAL MATERIEL CORPORATION  
MAMARONECK, NEW YORK



REQ.	ITEM	PART NO.	DESCRIPTION	SYMBOL
		.051 THK.	THE TECHNICAL MATERIEL CORP. MAMARONECK, NEW YORK	
		STOCK SIZE		
	ALUMINUM	<i>ff</i>	TOP COVER,	
		MATERIAL	MOTOR HOUSING	
		52S-H32		
		TYPE & TEMPER		
		<i>ff</i>		
		HEAT TREAT. SPEC.		
		<i>ff</i>		
		FINISH & SPEC. NO.		
			CHECKED	FINAL APPROVAL
				MS-158

ISSUE	ITEM	CHANGED FROM	DATE	CN. NO.	DRAFTS	CHECKER	ENG. APP.
TOLERANCES							
DEC. DIM. ± .005				SCALE: FULL SIZE			
FRAC. DIM. ± 1/64				DRILL, PUNCH, COMMERCIAL STOCK			
ANGULAR DIM. ±				SIZES AND MANUFACTURERS			
				TOLERANCES ARE NOT INCLUDED.			

TWR-115	151	A-214	9-23-52
MODEL	PROJECT NO.	ASS'Y. NO.	DATE
USED ON			