

IF IT IS FOUND DESIRABLE TO CHANGE ANY TOLERANCE OR OTHER DETAIL SPECIFIED ON THIS DRAWING NOTIFY THE PURCHASER PROMPTLY.

RELEASED

MS-145 A

MAXIMUM ALLOWABLE TOLERANCES HAVE BEEN DETERMINED AND DEVIATIONS WILL BE CAUSE FOR REJECTION. REMOVE ALL BURRS AND SHARP EDGES

REQ. PER UNIT	USED ON			
	MODEL	PROJECT NO.	ASS'Y. NO.	DATE
2	FFR	104	A-226	10-1-52
4	FFR-DP		A-334	1-21-53
4	FFR-DPH	333	A-854	10-19-54
2	FFR-2			5-22-58

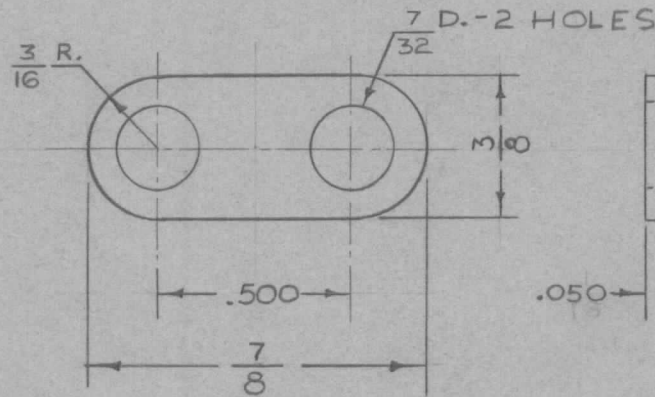

NOTICE TO PERSONS RECEIVING THIS DRAWING

THE TECHNICAL MATERIEL CORPORATION claims proprietary right in the material disclosed hereon. This drawing is issued in confidence for engineering information only and may not be reproduced or used to manufacture anything shown hereon without permission from THE TECHNICAL MATERIEL CORPORATION to the user. This drawing is loaned for mutual assistance and is subject to recall at any time.

Property of:
THE TECHNICAL MATERIEL CORPORATION
MAMARONECK, NEW YORK

REQ.	ITEM	PART NO.	DESCRIPTION	SYMBOL
		NO. 16 GAUGE - .050	THE TECHNICAL MATERIEL CORP. MAMARONECK, NEW YORK	
		STOCK SIZE		
		BRASS	LOCK LINK	
		MATERIAL		
		1/2 HARD		
		TYPE & TEMPER		
		HEAT TREAT. SPEC.		
		S-135 NICKEL PLATE		
		FINISH & SPEC. NO.		

A	1	FINISH # SPEC WAS S-105 BRIGHT CAD. PLATE	3-1-63	8325	SP	Jde	RB
ISSUE	ITEM	CHANGED FROM	DATE	CN. NO.	DRAFTS	CHECKER	ENG. APP.
TOLERANCES			SCALE 2" TO 1"				
ALL OTHERS	DEC. DIM. ± .005 FRAC. DIM. ± 1/64 ANGULAR DIM. ±		DRILL, PUNCH, COMMERCIAL STOCK SIZES AND MANUFACTURERS TOLERANCES ARE NOT INCLUDED.				

DRAWN: J.G. 9-30-52
 ELEC. DES. APP.: [Signature]
 MECH. DES. APP.: [Signature]
 CHECKED: WDC 10-10-52
 FINAL APPROVAL: MS-145 A