

# STANDARD DRAWING

## SPECIFICATIONS

### MOTOR CONTROL :

FREQUENCY, C.P.S. \_\_\_\_\_ 50/60  
 STALL TORQUE, OZ. IN. \_\_\_\_\_ 1.5  
 NO LOAD SPEED, R.P.M. \_\_\_\_\_ 3200  
 MAX. POWER OUTPUT, WATTS \_\_\_\_\_ 1.1  
 TORQUE AT MAX. POWER  
 OUTPUT, OZ. IN. \_\_\_\_\_ 0.9  
 SPEED AT MAX. POWER OUTPUT, R.P.M. \_\_\_\_\_ 1600  
 WEIGHT, OZ. \_\_\_\_\_ 7

** TYPICAL ELECTRICAL CHARACTERISTICS		
	FIXED PHASE	CONTROL *PHASE
VOLTAGE, VOLTS	115	40
CURRENT, AMPS	.063	.182
POWER INPUT, WATTS	6.4	6.4

OPERATING TEMPERATURE RANGE -0°C TO + 55°C

- \* SERIES CONNECTED
- \*\* FREQUENCY 60 CY
- \*\* MEASURED AT STALL AT A WINDING TEMPERATURE OF 25°C

### SHAFT GEAR DATA

NO. OF TEETH \_\_\_\_\_ 37  
 DIAMETRAL PITCH \_\_\_\_\_ 120  
 AGMA QUALITY CLASS \_\_\_\_\_ PRE ID  
 PITCH DIAMETER \_\_\_\_\_ .3083  
 OUTSIDE DIAMETER \_\_\_\_\_ .3250  
 PRESSURE ANGLE \_\_\_\_\_ 20°  
 MATERIAL \_\_\_\_\_ ST STL  
 HARDNESS \_\_\_\_\_ RC 26-32

### NOTE:

WHEN FIXED PHASE IS ENERGIZED WITH 115VAC, 60 CYCLE; THE GEAR ASSY. TO MOVE WITH 8 VAC MAX., APPLIED ACROSS CONTROL PHASE."

SHAFT END PLAY- .002 - .005 UNDER 1 POUND ± 1 OZ.  
 REVERSING GAUGE LOAD  
 1.3120±.0000 DIA. TO BE CONCENTRIC TO  $\phi$  WITHIN .001 T.I.R.

### NOTES

1	HFRR-2	
Q'TY./UNIT	MODEL USED ON	ASS'Y. NO.
SCALE 1:1	CODE C	S401-116 (BT1407-12)

THE CONTENTS OF THIS DRAWING ARE THE EXCLUSIVE PROPERTY OF THE TECHNICAL MATERIEL CORP. ITS UNAUTHORIZED USE OR REPRODUCTION IN WHOLE OR IN PART IS STRICTLY FORBIDDEN.

MO123 B

### REVISIONS

SYM	DESCRIPTION	DATE	E.M.N. NO.	DRAFT	CHKD	APFD
	EXPERIMENTAL RELEASE	9-10-64	-	G.D.L		
Ø	ORIGINAL RELEASE FOR PRODUCTION	9-15-64	Ø	92		
A	NOTE ADDED ELEC CHART DELETE POWER FAC. R, X, Z OHMS EFF - P. UNITY PF. CAP. ON SPEC. DELETE ROTOR INERTIA THEOR. ACCEL.	9/19/65	14467	2V.V	JCB	MM
B	FINISH WAS ANODIZE (BLK)	6.20.66	16441	W.W	JCB	92

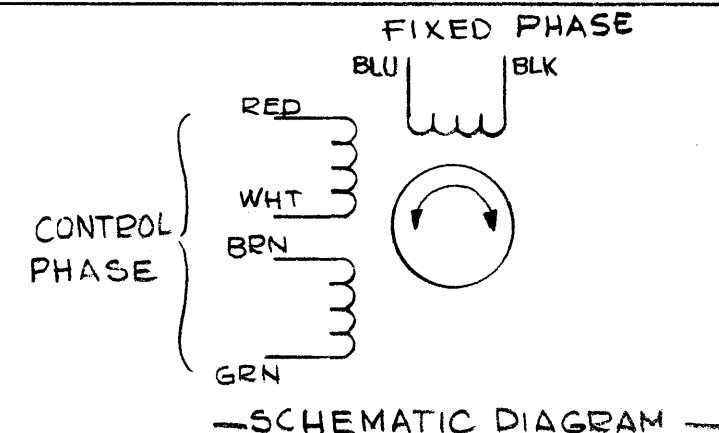
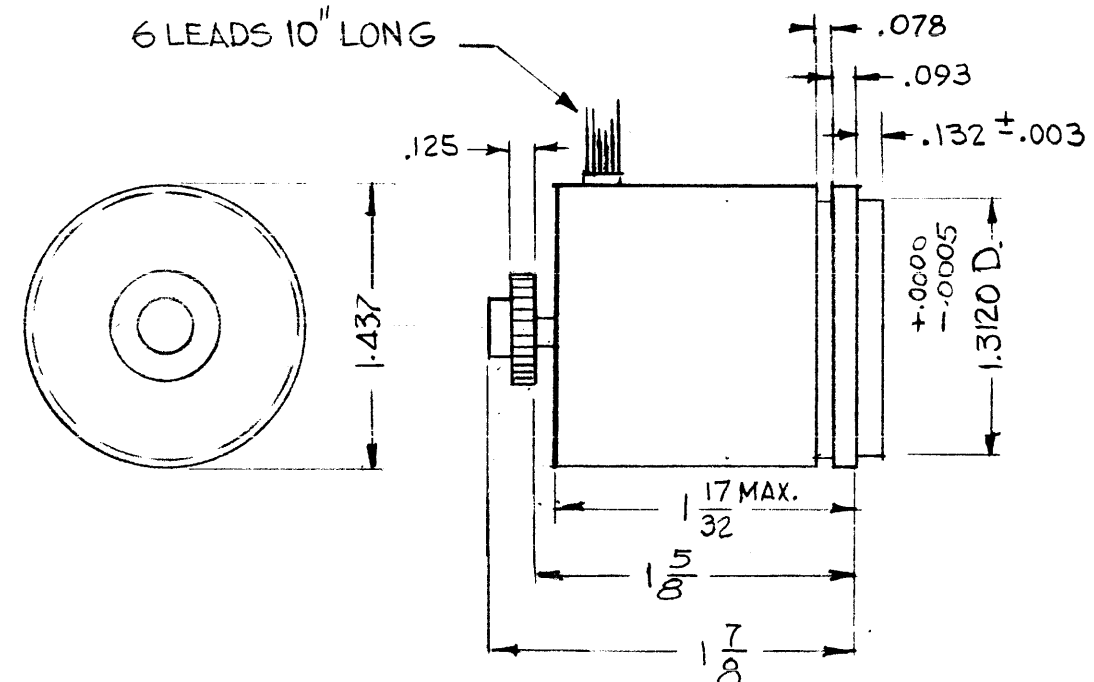

REQ'D.	ITEM	PART NUMBER	DESCRIPTION	SYMBOL
--------	------	-------------	-------------	--------

### LIST OF MATERIAL

MATERIAL	STAINLESS STEEL TYPE 303	THE TECHNICAL MATERIEL CORP. MAMARONECK, NEW YORK
FINISH	S104-PASSIVATE	
TITLE		MOTOR, CONTROL, SERVO

UNLESS OTHERWISE SPECIFIED DIMENSIONS ARE IN INCHES AND INCLUDE CHEMICALLY APPLIED OR PLATED FINISHES		DRAWN <i>J. Davis</i>	DATE 9-11-64	FINAL APPROVAL <i>RAC</i>	DATE
DECIMALS .X ± .05 .XX ± .01 .XXX ± .005		TOLERANCES	ELECT. DES. <i>J</i>		DATE 9/14/64
FRACTIONS ± 1/64 ANGLES ± 0° 30'			MECH. DES. <i>T. Kelly</i>		
			SHEET		REV. LTR.

MO123 B