



IF IT IS FOUND DESIRABLE TO CHANGE ANY TOLERANCE OR OTHER DETAIL SPECIFIED ON THIS DRAWING NOTIFY THE PURCHASER PROMPTLY.

MAXIMUM ALLOWABLE TOLERANCES HAVE BEEN DETERMINED AND DEVIATIONS WILL BE CAUSE FOR REJECTION. REMOVE ALL BURRS AND SHARP EDGES

LS-101 F

**SPECIFICATIONS**

- 1~ MAGNET TYPE - DP ALNICO 5
- 2~ VOICE COIL SPECS:
  - A~ IMPEDANCE: 3.4 Ω (OHMS)
  - B~ POWER: 4 WATTS PROG.
  - C~ DIAMETER: 9/16"

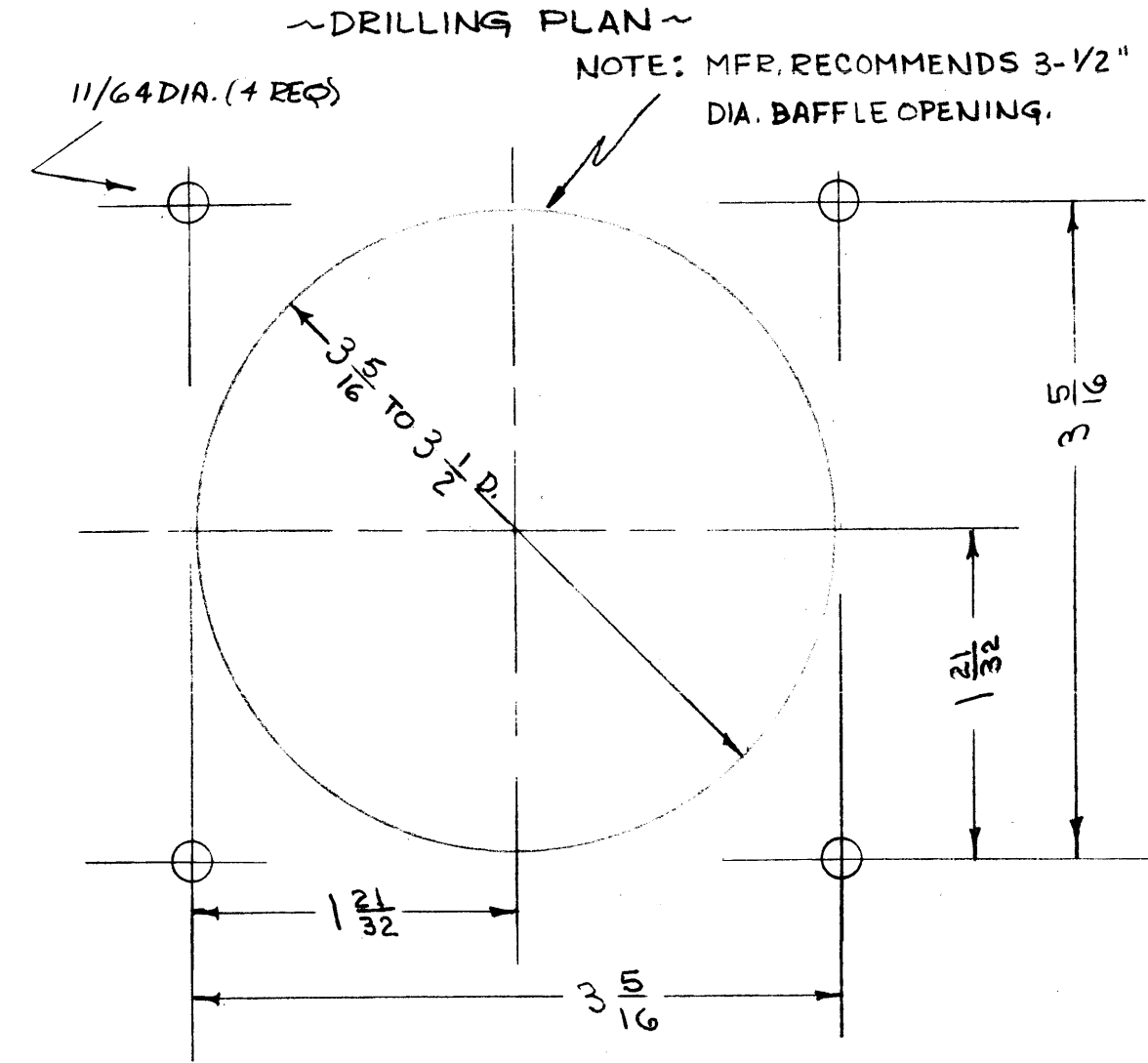
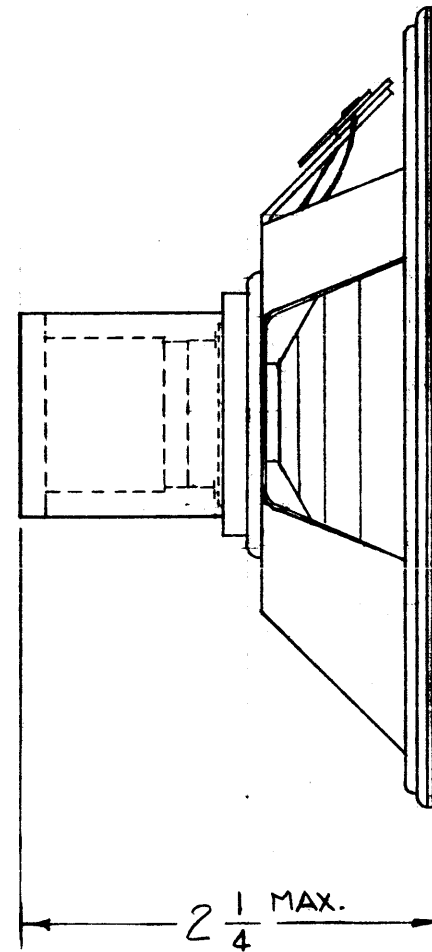
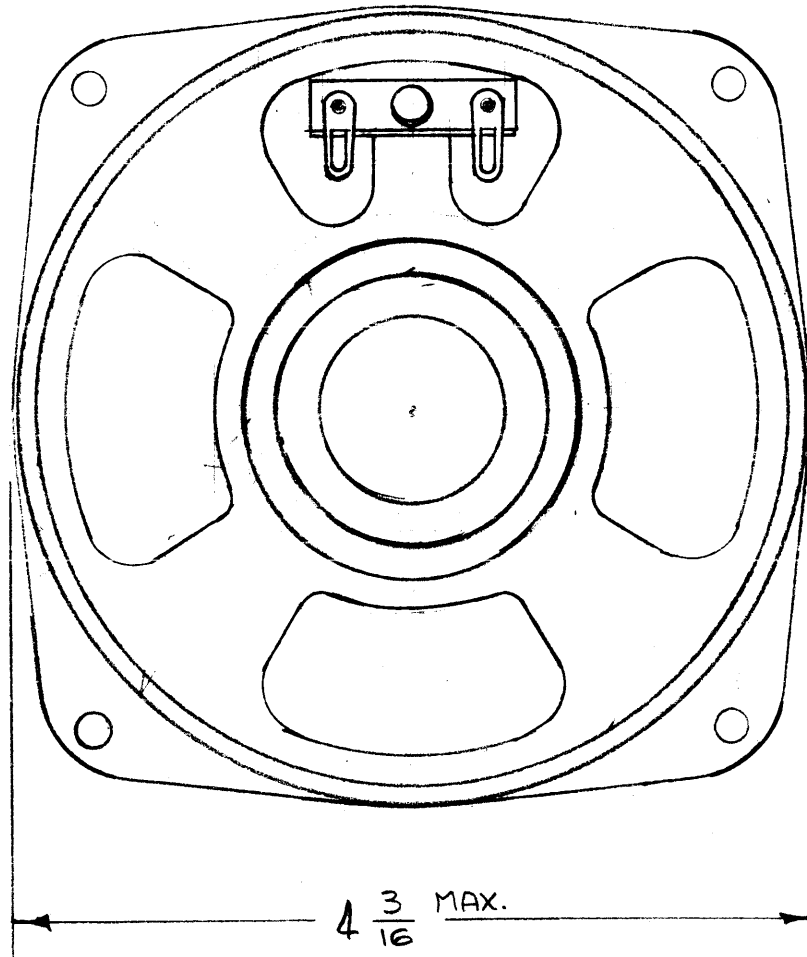

**NOTICE TO PERSONS RECEIVING THIS DRAWING**

THE TECHNICAL MATERIEL CORPORATION claims proprietary right in the material disclosed hereon. This drawing is issued in confidence for engineering information only and may not be reproduced or used to manufacture anything shown hereon without permission from THE TECHNICAL MATERIEL CORPORATION to the user. This drawing is loaned for mutual assistance and is subject to recall at any time.

Property of:

THE TECHNICAL MATERIEL CORPORATION  
MAMARONECK, NEW YORK

REF: UTAH MFG. CO. PART # \$ P 4 Y

F	IMP. WAS 3.2 Ω, POWER WAS 4.5 W. REF WAS JENSEN MFG	14-75	21185	GDL	CL	CL	
E	PART # WAS PLW	6-22-72	20754	GE	EL	EL	
D	1 COMPLETEY REVISED	11-26-62	7710	EG	JCB	JCB	
C	1 PART # WAS PAX-ST113	8-19-60	2756	RU	JCB	JCB	
B	2 9/16 WAS 3 5/8 1 2" WAS 2 1/4	7-24-54	2	COB	MHS	MHS	
A	1 REDRAWN - DRILLING PLAN ADDED	1/18/54	14	COB	MHS	MHS	
ISSUE	ITEM	CHANGED FROM	DATE	CN. NO.	DRAFTS	CHECKER	ENG. APP.
TOLERANCES			SCALE: #				
ALL OTHERS	DEC. DIM. ± FRAC. DIM. ± 1/64 ANGULAR DIM. ±		DRILL, PUNCH, COMMERCIAL STOCK SIZES AND MANUFACTURERS TOLERANCES ARE NOT INCLUDED.				

LSP-1	202	1-18-54
MODEL	PROJECT NO.	ASS'Y. NO.
USED ON		

REQ.	ITEM	PART NO.	DESCRIPTION	SYMBOL
	#		THE TECHNICAL MATERIEL CORP.	
			MAMARONECK, NEW YORK	
	#	#	SPEAKER, P.M.	
			MATERIAL	WEIGHT PER PC.
			TYPE & TEMPER	
			HEAT TREAT. SPEC.	
			FINI H & SPEC. NO.	

CTD: 1-18-54	A. J. J.	W
DRAWN	ELEC. DES. APP.	MECH. DES.
JCB	A. J. J.	W
CHECKED	FINAL APPROVAL	
	LS-101	F

IF IT IS FOUND DESIRABLE TO CHANGE ANY TOLERANCE OR OTHER DETAIL SPECIFIED ON THIS DRAWING NOTIFY THE PURCHASER PROMPTLY.

MAXIMUM ALLOWABLE TOLERANCES HAVE BEEN DETERMINED AND DEVIATIONS WILL BE CAUSE FOR REJECTION. REMOVE ALL BURRS AND SHARP EDGES

LS-102 C

V.C. IMPEDANCE - 45-50 Ω  
 POWER - 2.0 WATTS  
 FIELD MAGNET .65 TO .70 OZ.

DRILLING PLAN

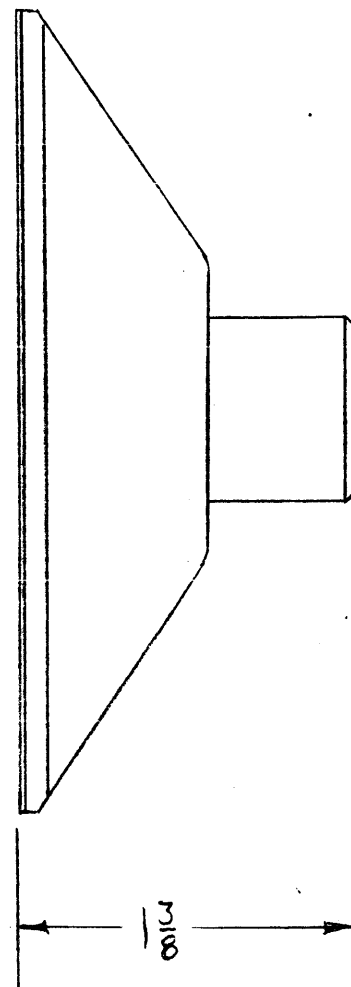
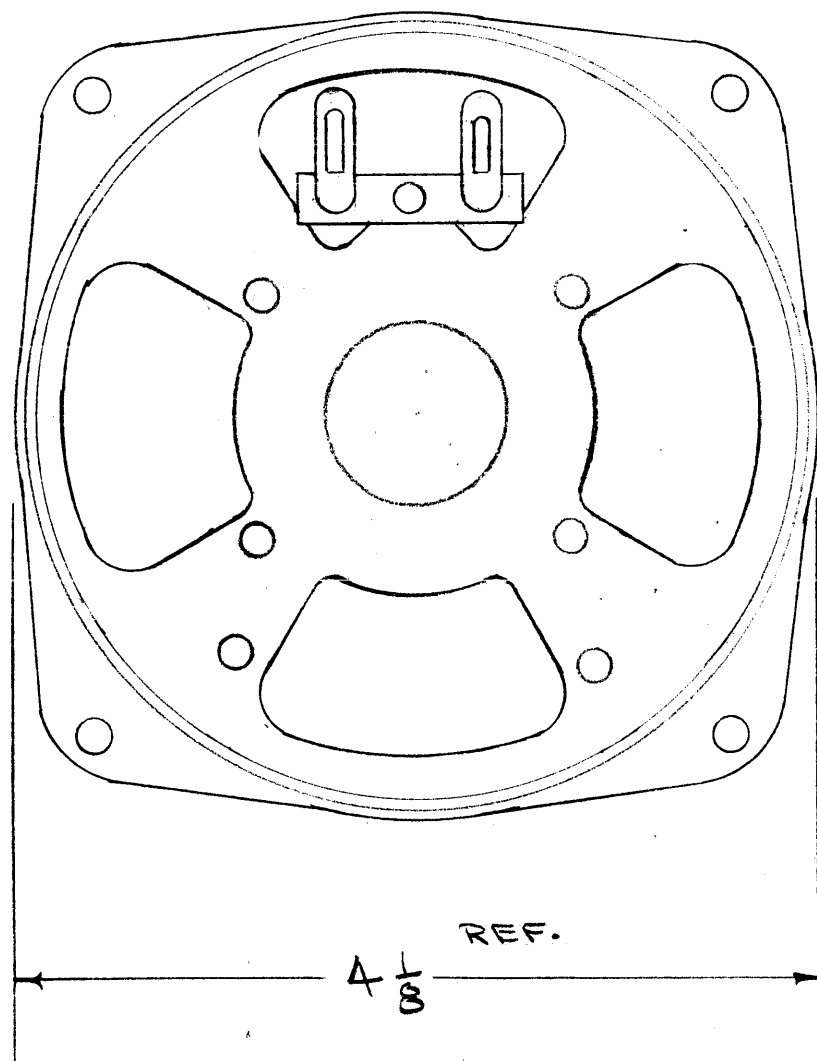

11/64 (.171) D. 4 REQ

TYPICAL APPEARANCE

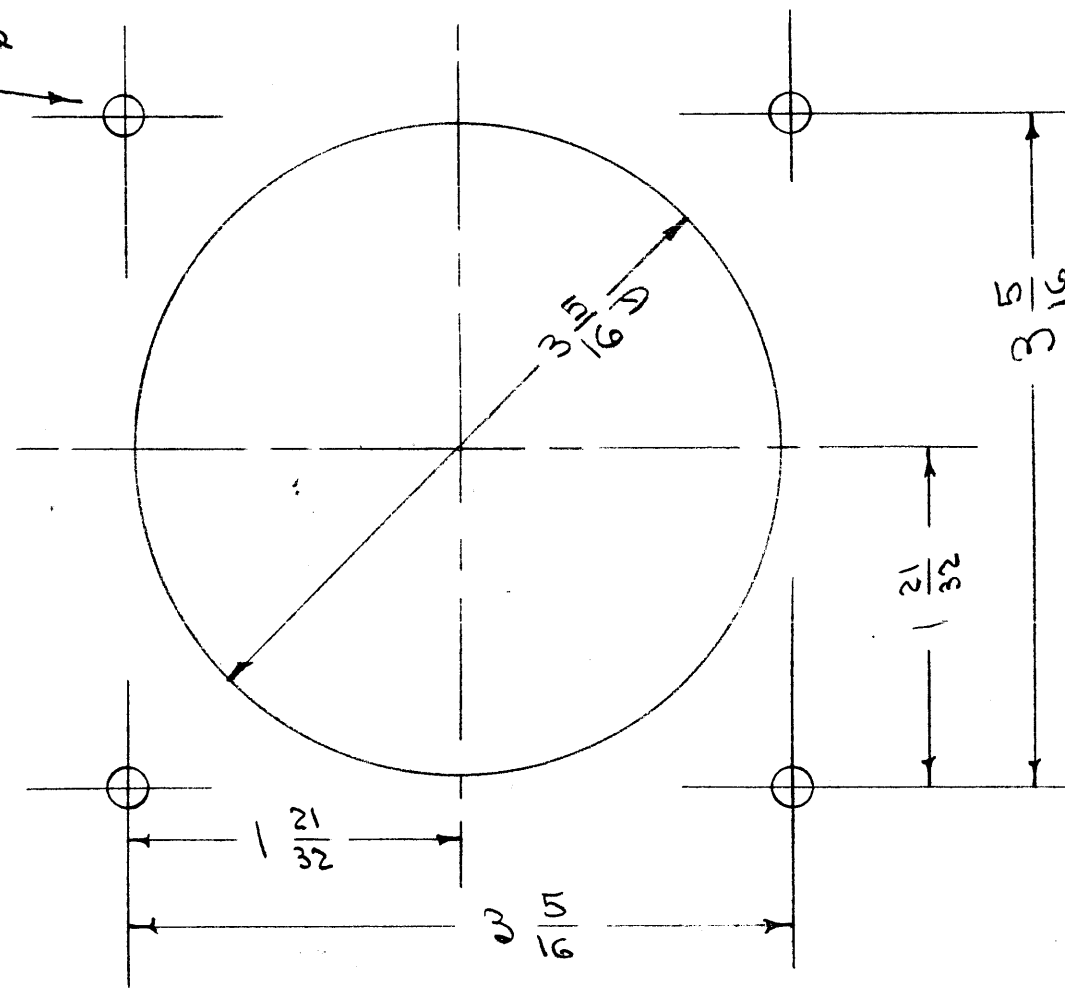

C	1	BSP1D, 2D, 3D WAS 18, 28, 38	5/29/65	CC	CJC	JCH
B	3	INSPECS: FIELD MAGNET ADD.	11/12/64	12602	RF	CC
	2	ON SPECS: GAP ENERGY DELE.				
	1	PICT. & TITLE REVISED				
A	2	UTAH MFG. # ADDED	1/2/58	1	JCH	ATT
	1	Jensen Mfg # P4X-ST739 DELETED				

ISSUE	ITEM	CHANGED FROM	DATE	CN. NO.	DRAFTS	CHECKER	ENG. APP.
TOLERANCES		SCALE: 5401-323 (SP4A1) 5401-311 (4A07Z45)					
ALL OTHERS	DEC. DIM. ±	DRILL, PUNCH, COMMERCIAL STOCK					
	FRAC. DIM. ±	SIZES AND MANUFACTURERS					
	ANGULAR DIM. ±	TOLERANCES ARE NOT INCLUDED.					

3	BSP3D				
2	BSP2D				
1	BSP1D				
1	RSC-2			10-27-54	
REQ PER UNIT	MODEL	PROJECT NO.	ASS'Y. NO.	DATE	
		USED ON			

REQ. ITEM	PART NO.	DESCRIPTION	SYMBOL
		THE TECHNICAL MATERIEL CORP.	
STOCK SIZE		MAMARONECK. NEW YORK	
		LOUDSPEAKER, PM, 4 IN.	
MATERIAL	WEIGHT PER PC.		
TYPE & TEMPER		CDD. 10-27-54	KZ
HEAT TREAT. SPEC.		11/27/54	A.J.T.
FINI H & SPEC. NO.			

LS-104

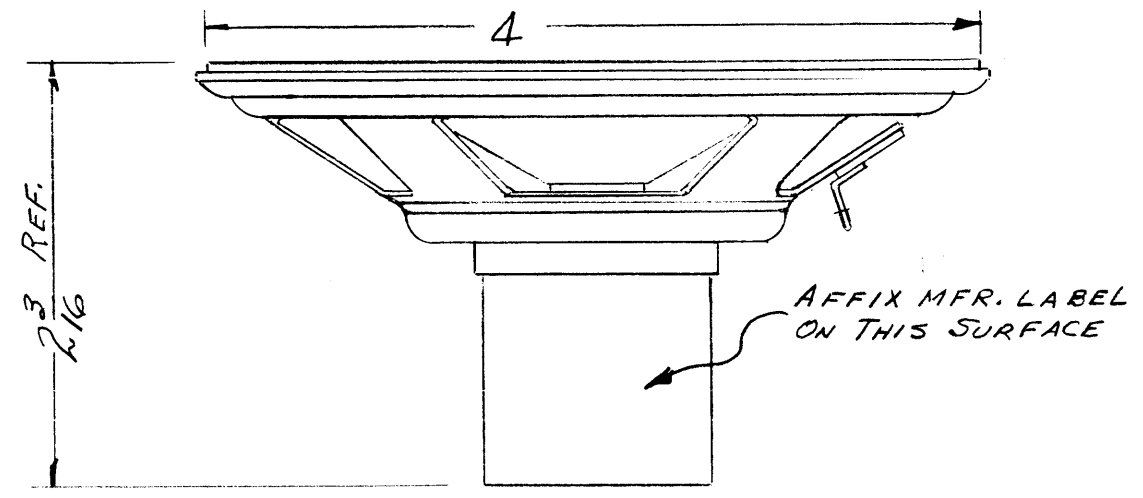

V.C. IMPEDANCE - 45 Ω Nom. AT 400 CPS  
 POWER - 4 WATTS  
 MAGNET - 1.47 OZ.  
 WIRE GAUGE - 4706-3  
 FIN. RESONANCE - 159 CPS

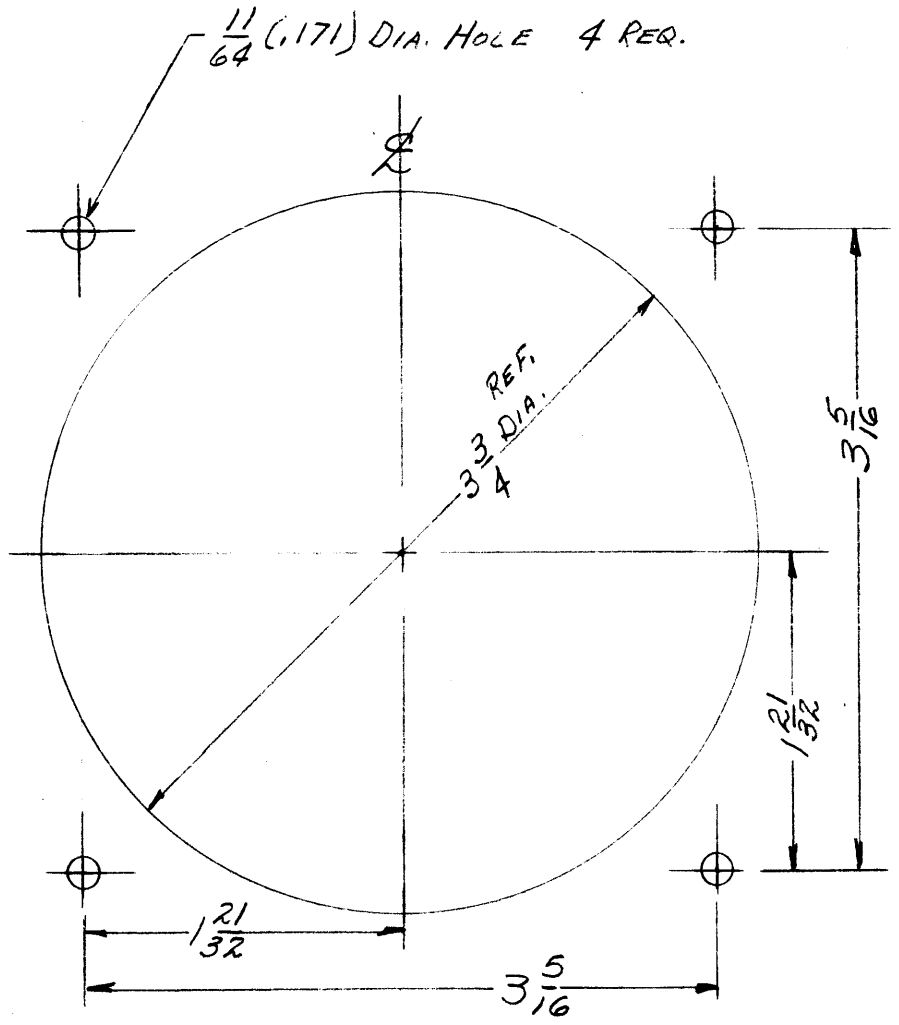
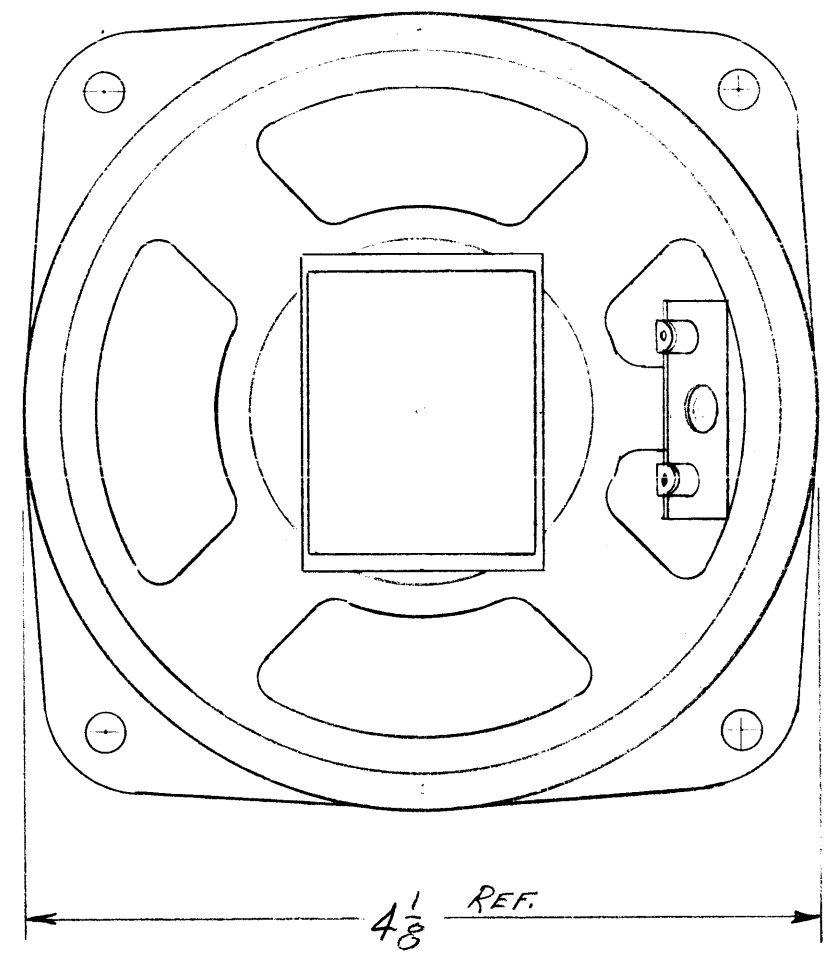

DRILLING PLAN

**NOTICE TO PERSONS RECEIVING THIS DRAWING**  
 THE TECHNICAL MATERIEL CORPORATION claims proprietary right in the material disclosed hereon. This drawing is issued in confidence for engineering information only and may not be reproduced or used to manufacture anything shown hereon without permission from THE TECHNICAL MATERIEL CORPORATION to the user. This drawing is loaned for mutual assistance and is subject to recall at any time.

Property of:  
 THE TECHNICAL MATERIEL CORPORATION  
 MAMARONECK, NEW YORK

REF.: JENSEN MODEL PA-VA-SP9266

ISSUE	ITEM	CHANGED FROM	DATE	CH. NO.	DRAFTS	CHECKER	ENG. APP.
TOLERANCES							
SCALE: <i>CFO</i>							
DEC. DIM. ±							
FRAC. DIM. ± <i>1/64</i>							
ANGULAR DIM. ±							
MAXIMUM ALLOWABLE TOLERANCES HAVE BEEN DETERMINED AND ANY DEVIATIONS WILL BE CAUSE FOR REJECTION. REMOVE ALL BURRS AND SHARP EDGES							

1	RSC-3				
REQ. PER UNIT	MODEL	PROJECT NO.	ASS'Y. NO.	DATE	
USED ON					

REQ. ITEM	PART NO.	DESCRIPTION	SYMBOL
<i>CFO</i>		THE TECHNICAL MATERIEL CORP. MAMARONECK, NEW YORK	
	STOCK SIZE	LOUDSPEAKER	
	MATERIAL	PERMANENT MAGNET 4"	
<i>CFO</i>	<i>CFO</i>	10-16-58 <i>AMC</i>	<i>JSR</i>
	TYPE & TEMPER	DRAWN	CHECKED
		<i>P.L.K.</i>	<i>Mo</i>
	FINISH & SPEC. NO.	ELEC. DES. APP.	MECH. DES. APP.
			LS-104

LS-105

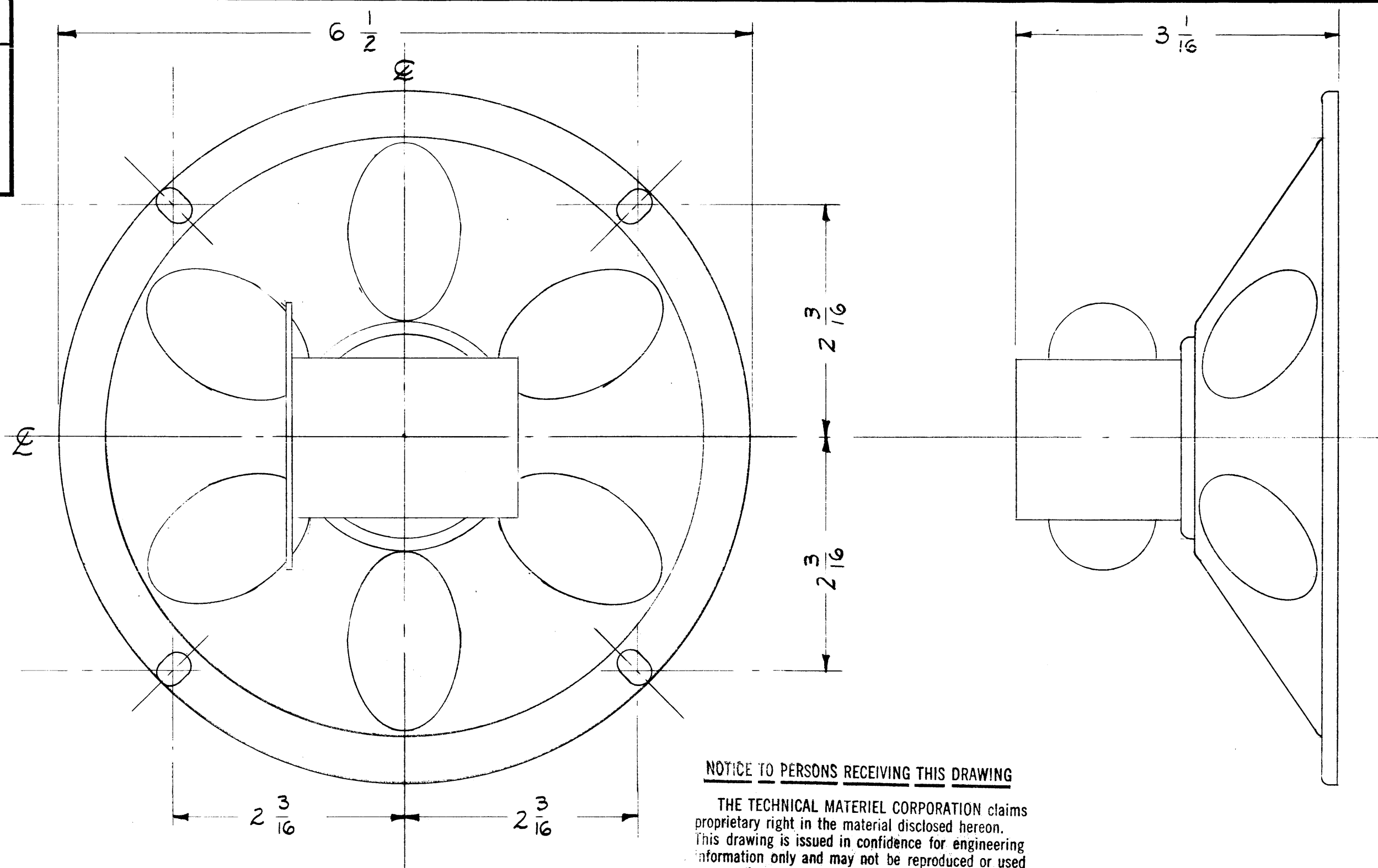

**NOTICE TO PERSONS RECEIVING THIS DRAWING**

THE TECHNICAL MATERIEL CORPORATION claims proprietary right in the material disclosed hereon. This drawing is issued in confidence for engineering information only and may not be reproduced or used to manufacture anything shown hereon without permission from THE TECHNICAL MATERIEL CORPORATION to the user. This drawing is loaned for mutual assistance and is subject to recall at any time.

Property of:  
THE TECHNICAL MATERIEL CORPORATION  
MAMARONECK, NEW YORK

REF: UTAH PAGED (82 VC)

ISSUE	ITEM	CHANGED FROM	DATE	CH. NO.	DRAFTS	CHECKER	ENG. APP.
TOLERANCES		SCALE:					
DEC. DIM. ±		MAXIMUM ALLOWABLE TOLERANCES HAVE BEEN DETERMINED AND ANY DEVIATIONS WILL BE CAUSE FOR REJECTION.					
FRAC. DIM. ±		REMOVE ALL BURRS AND SHARP EDGES					
ANGULAR DIM. ±							

1	UTD-2			5-4-59
REQ. PER UNIT	MODEL	PROJECT NO.	ASS'Y. NO.	DATE
USED ON				

REQ. ITEM	PART NO.	DESCRIPTION	SYMBOL
		THE TECHNICAL MATERIEL CORP. MAMARONECK, NEW YORK	
STOCK SIZE		SPEAKER	
MATERIAL			
TYPE & TEMPER	HEAT TREAT. SPEC.	DRAWN	CHECKED
FINISH & SPEC. NO.		ELEC. DES. APP.	MECH. DES. APP.
		LS-105	

C  
LS-106

REVISIONS

SYM	DESCRIPTION	DATE	E.M.N. NO.	DRAFT	CHKD	APPD
A	DIM. 2 WAS 2.062 (2 PL.) , S401-338 ADDED MFR. REF. DELETED	11.3.64	12842	HTB	[Signature]	[Signature]
B	DIM 2 1/16 WAS 2 (2 PL.) NOTE: "THIS HOLE TO BE PUNCHED 9/32 DIA BY TMC" ADD.	11/3/69	19634	KH	[Signature]	OP [Signature]
C	DIM 2 1/2 WAS 2 17/32 . 1 7/32 WAS 1 19/32, 11/16 WAS 61/64 7/8 WAS 1 1/8 & 2 7/32 WAS 2 1/4	1-27-76	21352	SOL	[Signature]	[Signature]

THIS HOLE TO BE PUNCHED  
TO 9/32 DIA. BY TMC.

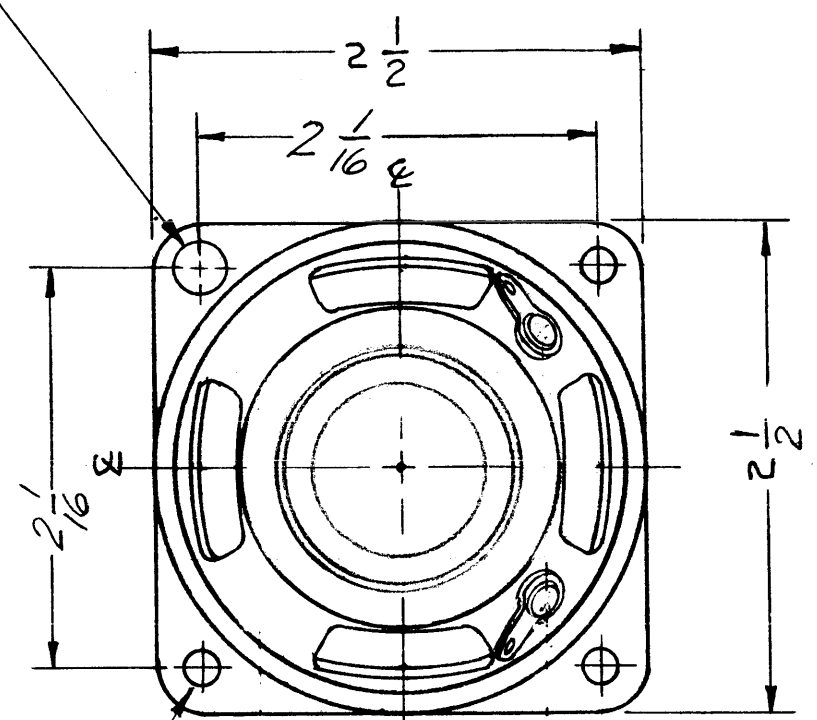

.173 DIA. 4 HOLES

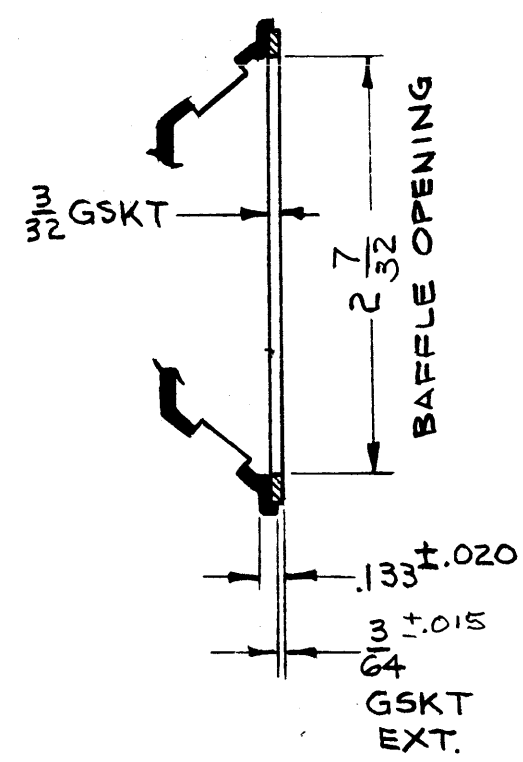
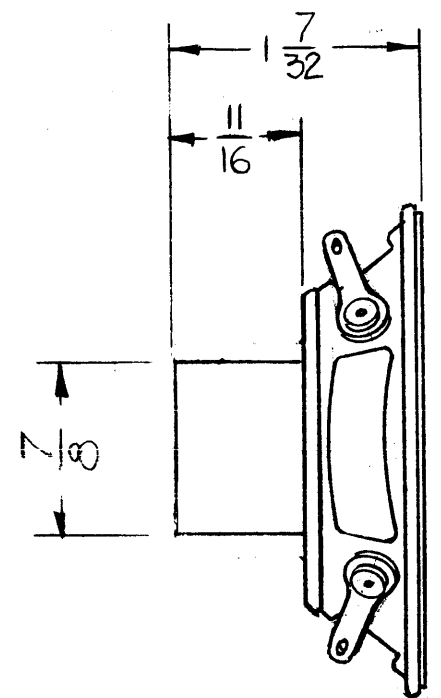

\* SP25A; SP25Y

SPECIFICATIONS

**MECHANICAL:**  
 FRAME MATERIAL - COLD ROLLED STEEL  
 FRAME FINISH - CADMIUM PLATE  
 CONE SIZE - 2" DIA

**ELECTRICAL:**  
 FREQUENCY RESPONSE -  
 NORMAL OPER. FREQ. RANGE: 200 - 5000 CPS

MATCHING IMPEDANCE OF VOICE COIL 3-4 Ω  
 VOICE COIL NOM. DIA. = 9/16  
 INPUT WATTAGE DATA:  
 NORMAL = 1W PEAK = 2W

STANDARD DRAWING

REQ'D.	ITEM	PART NUMBER	DESCRIPTION	SYMBOL
KOHN LIST OF MATERIAL				
MATERIAL			THE TECHNICAL MATERIEL CORP. MAMARONECK, NEW YORK	
FINISH			TITLE LOUDSPEAKER, PERMANENT MAGNET	
UNLESS OTHERWISE SPECIFIED DIMENSIONS ARE IN INCHES AND INCLUDE CHEMICALLY APPLIED OR PLATED FINISHES		DRAWN [Signature]	DATE 5-15-63	FINAL APPROVAL [Signature]
		CHECKED [Signature]	DATE 5-15-63	
		ELECT. DES. [Signature]	DATE 5-15-63	LS-106
		MECH. DES. W. JORDAN	DATE 5-15-63	C
			SHEET	REV. LTR.

1	TTR-10	
Q'TY./UNIT	MODEL USED ON	ASS'Y. NO.
SCALE	CODE C	*S401-323
THE CONTENTS OF THIS DRAWING ARE THE EXCLUSIVE PROPERTY OF THE TECHNICAL MATERIEL CORP. ITS UNAUTHORIZED USE OR REPRODUCTION IN WHOLE OR IN PART IS STRICTLY FORBIDDEN.		

NOTES