

REQ. PER UNIT	USED ON			LD 2027	Ø
	MODEL	ASS'Y. NO.	DATE		
1	VLLA-1		12-3-65		

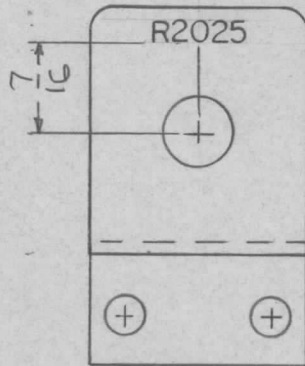

MARKING PROCESS: AS PER TMC SPECIFICATION S-727.  
 LETTERING: 1/8 HIGH BLACK GOTHIC, LOCATED AS SHOWN.

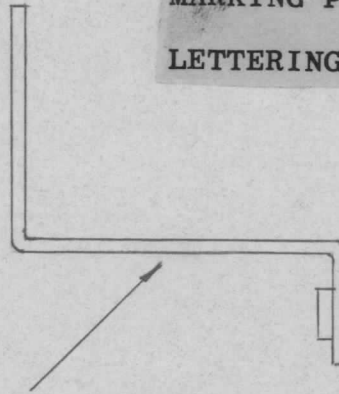

MARK TMC P/N (LD2027- /MS4829-  
 1/8 HIGH GOTHIC W/LATEST  
 REV. LETTERS.

REF: MS 4829

REQ.	ITEM	PART NO.	F. BUDETTI	DESCRIPTION	SYMBOL			
				THE TECHNICAL MATERIEL CORP. MAMARONECK. NEW YORK				
				MARKING, BRACKET MTG. POT				
				MARKING PROCESS: AS PER TMC SPEC S727				
Ø	ORIGINAL RELEASE	12/8/65						
SYM	DESCRIPTION	DATE	CH. NO.	DRAFTS	CHECKER	ENG. APP.		
UNLESS OTHERWISE SPECIFIED DIMENSIONS ARE IN INCHES AND INCLUDE CHEMICALLY APPLIED OR PLATED FINISHES		SCALE	1:1					
DECIMALS .X ± .05 .XX ± .01 .XXX ± .005	TOLERANCES	FRACTIONS ± 1/64 ANGLES ± 0° 30'	CODE A					
				TYPE & TEMPER	HEAT TREAT. SPEC.	DRAWN	CHECKED	FINAL APPROVAL
				FINISH & SPEC. NO.	ELEC. DES. APP.	MECH. DES. APP.	LD 2027	Ø