

|               |         |            |         |         |   |
|---------------|---------|------------|---------|---------|---|
| REQ. PER UNIT | USED ON |            |         | LD 1808 | ⊘ |
|               | MODEL   | ASS'Y. NO. | DATE    |         |   |
| 1             | HFIR-1  |            | 6-19-65 |         |   |

MARKING PROCESS: AS PER TMC SPECIFICATION S-727.

LETTERING: 1/8 HIGH BLACK GOTHIC, LOCATED AS SHOWN.

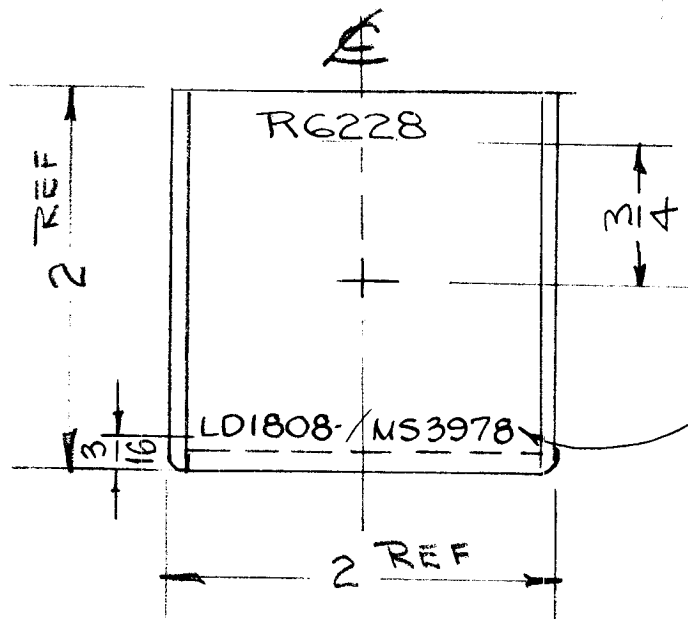

MARK TMC PART NO.  
1/8 HIGH BLACK GOTHIC  
W/LATEST REVISION  
LETTERS.

REF! MS3978

| REQ.  | ITEM                            | PART NO.                                  | EATDN         | DESCRIPTION  | SYMBOL  |                   |          |                 |  |         |  |                |  |
|---|---------------------------------|---|---------------|--|---------|-------------------|----------|-----------------|--|---------|--|----------------|--|
|   |                                 |   |               | THE TECHNICAL MATERIEL CORP.<br>MAMARONECK, NEW YORK |         |                   |          |                 |  |         |  |                |  |
|   |                                 |   |               | MARKING, BKT, MTG.                                   |         |                   |          |                 |  |         |  |                |  |
|   |                                 |   |               | RF GAIN LEDEX  |         |                   |          |                 |  |         |  |                |  |
| ⊘   | ORIGINAL RELEASE FOR PRODUCTION | 6-18-65                                   | <del>AA</del> | JC   |         |                   |          |                 |  |         |  |                |  |
| SYM   | DESCRIPTION                     | DATE                                      | CH. NO.       | DRAFTS   | CHECKER | ENG. APP.         | MATERIAL |                 |  |         |  |                |  |
| UNLESS OTHERWISE SPECIFIED DIMENSIONS ARE IN INCHES AND INCLUDE CHEMICALLY APPLIED OR PLATED FINISHES |                                 | SCALE                                     |               | TYPE & TEMPER  |         | HEAT TREAT. SPEC. |          | DRAWN           |  | CHECKED |  | FINAL APPROVAL |  |
| DECIMALS<br>.X ± .05<br>.XX ± .01<br>.XXX ± .005  | TOLERANCES                      | FRACTIONS<br>± 1/64<br>ANGLES<br>± 0° 30' | CODE          | FINISH & SPEC. NO.                                   |         | ELEC. DES. APP.   |          | MECH. DES. APP. |  | LD 1808 |  | ⊘              |  |