

REQ. PER UNIT	USED ON			LD1511	⊗
	MODEL	ASS'Y. NO.	DATE		
1	SWCA-3K	BMA 129	11-21-66		

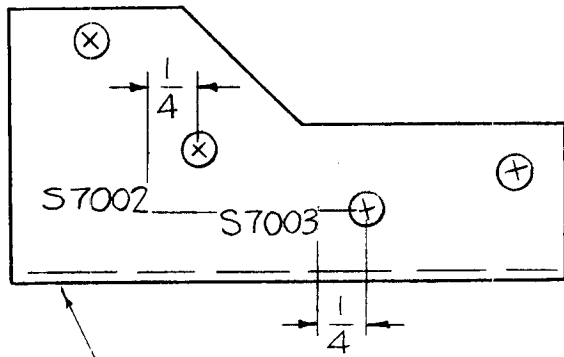

MARKING PROCESS: AS PER TMC SPECIFICATION S-727.
 LETTERING: 1/8 HIGH BLACK GOTHIC, LOCATED AS SHOWN.

MARK TMC P/N (LD1511)
 1/8 HIGH GOTHIC W/LATEST
 REV. LETTER.
 (ON BOTTOM)

REF MS 3774-

REQ. ITEM	PART NO.	F. BUDETTI DESCRIPTION			SYMBOL	
		THE TECHNICAL MATERIEL CORP. MAMARONECK, NEW YORK				
Ø	ORIGINAL RELEASE FOR PRODUCTION	12-16-66	Ø	RME	MARKING BRACKET, MTG SWITCHES AS PER TMC SPEC. S-727	
X	EXP. RELEASE	11-21-66				
SYM	DESCRIPTION	DATE	CH. NO.	DRAFTS	CHECKER	ENG. APP.
UNLESS OTHERWISE SPECIFIED DIMENSIONS ARE IN INCHES AND INCLUDE CHEMICALLY APPLIED OR PLATED FINISHES		SCALE		1:1		
DECIMALS .X ± .05 .XX ± .01 .XXX ± .005	TOLERANCES	FRACTIONS ± 1/64 ANGLES ± 0° 30'	CODE A			
FINISH & SPEC. NO.		ELEC. DES. APP.	MECH. DES. APP.	LD1511 ⊗		