

TMC PART NO.
W/ LATEST REV.
LETTERS
SEE NOTE 2

REVISIONS						
ZONE	SYM	DESCRIPTION	DATE	E.M.N. NO.	DRAFT	CHKD
~	C	REVISED & REDRAWN	7-3-63	9463		
~	D	T122, T125 THRU T128 & T130 WERE T1147 THRU T1152	9-26-63	10,024	G-D-L	
~	E	T127, T102, T125, T126, FL101, XY102, LD-153-MS-2970-C	7-14-64	11739	SRG	
~	F	V117, 12AT7, V118, 6AB4, V119, 6AU6, V118, 6AQ5, V118, 6AB4, RELOCATED	11-1-66	13674	NLA	

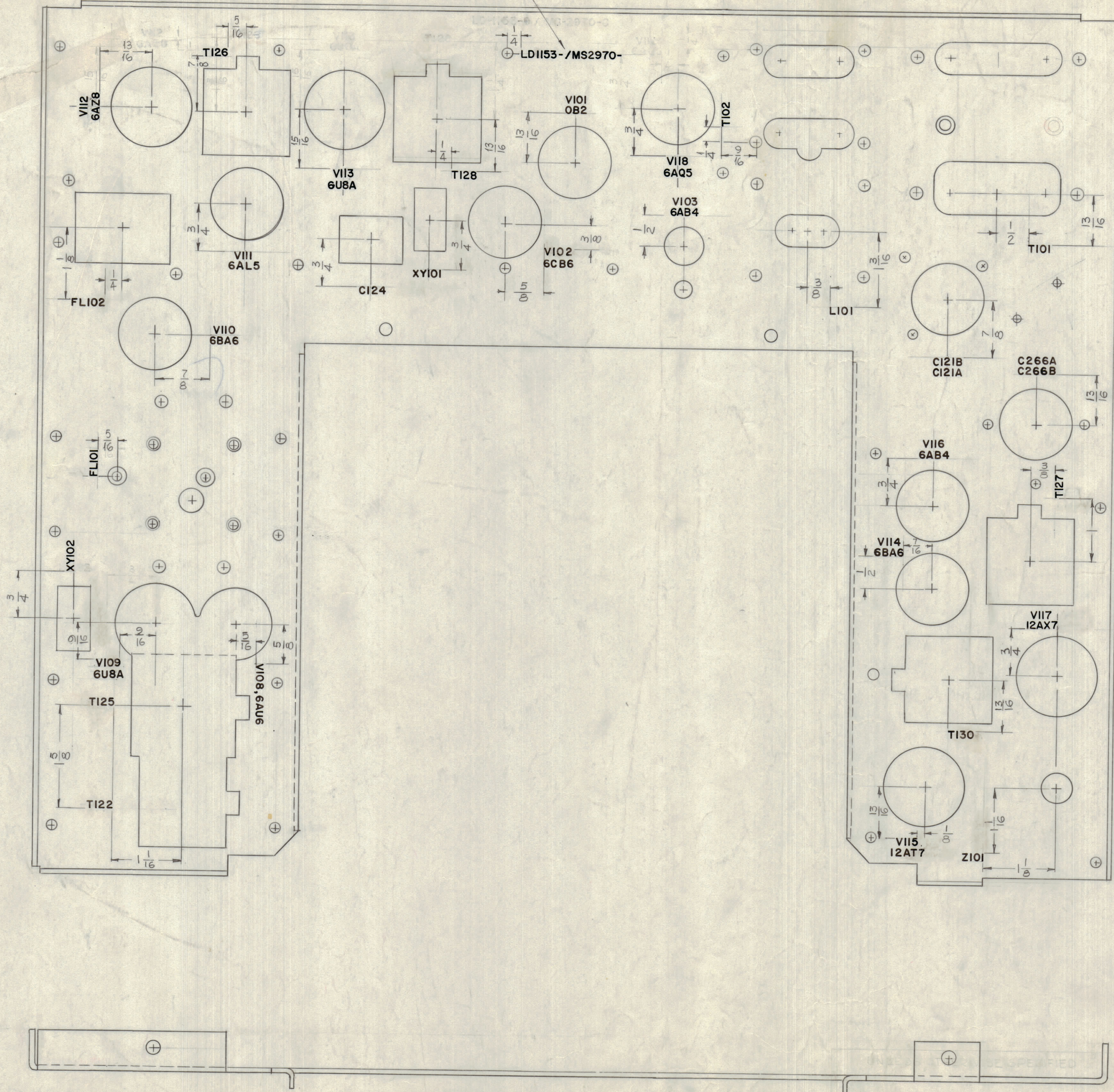

- NOTES: —
UNLESS OTHERWISE SPECIFIED
- 1) MARKING PROCESS - AS PER TMC SPECIFICATION S-727.
 - 2) LETTERING - 1/8" HIGH BLACK, GOTHIC LOCATED AS SHOWN.
 - 3) SPACING WILL BE 1/16" BETWEEN LETTER GROUPS

LD-1153 F

REF: MS-2970-C (2)

REQ'D.	ITEM	PART NUMBER	DESCRIPTION	SYMBOL
STRUMER LIST OF MATERIAL				
MATERIAL THE TECHNICAL MATERIEL CORP. MAMARONECK, NEW YORK				
FINISH TITLE LETTERING, MAIN CHASSIS (TOP)				
QUANTITY	UNIT	MODEL USED ON	DATE	FINAL APPROVAL
1		GPR-92A	6-19-63	TFH
SCALE	1:1	CODE	DATE	DATE
			7-2-63	7-8-63
UNLESS OTHERWISE SPECIFIED DIMENSIONS ARE IN INCHES AND INCLUDE CHEMICALLY APPLIED OR PLATED FINISHES			DRAWN	G.D.L.
THE CONTENTS OF THIS DRAWING ARE THE EXCLUSIVE PROPERTY OF THE TECHNICAL MATERIEL CORP. ITS UNAUTHORIZED USE OR REPRODUCTION IN WHOLE OR IN PART IS STRICTLY FORBIDDEN.			CHECKED	SRG
DECIMALS	± .05	FRACTIONS	± 1/64	DATE
.XX ± .01		ANGLES	± 0° 30'	DATE
.XXX ± .005				DATE
			DATE	7-8-63
			SHEET	OF 2
			REV.	F

