

TMC PART NO.
W/ LATEST REV.
LETTERS
SEE NOTE 2

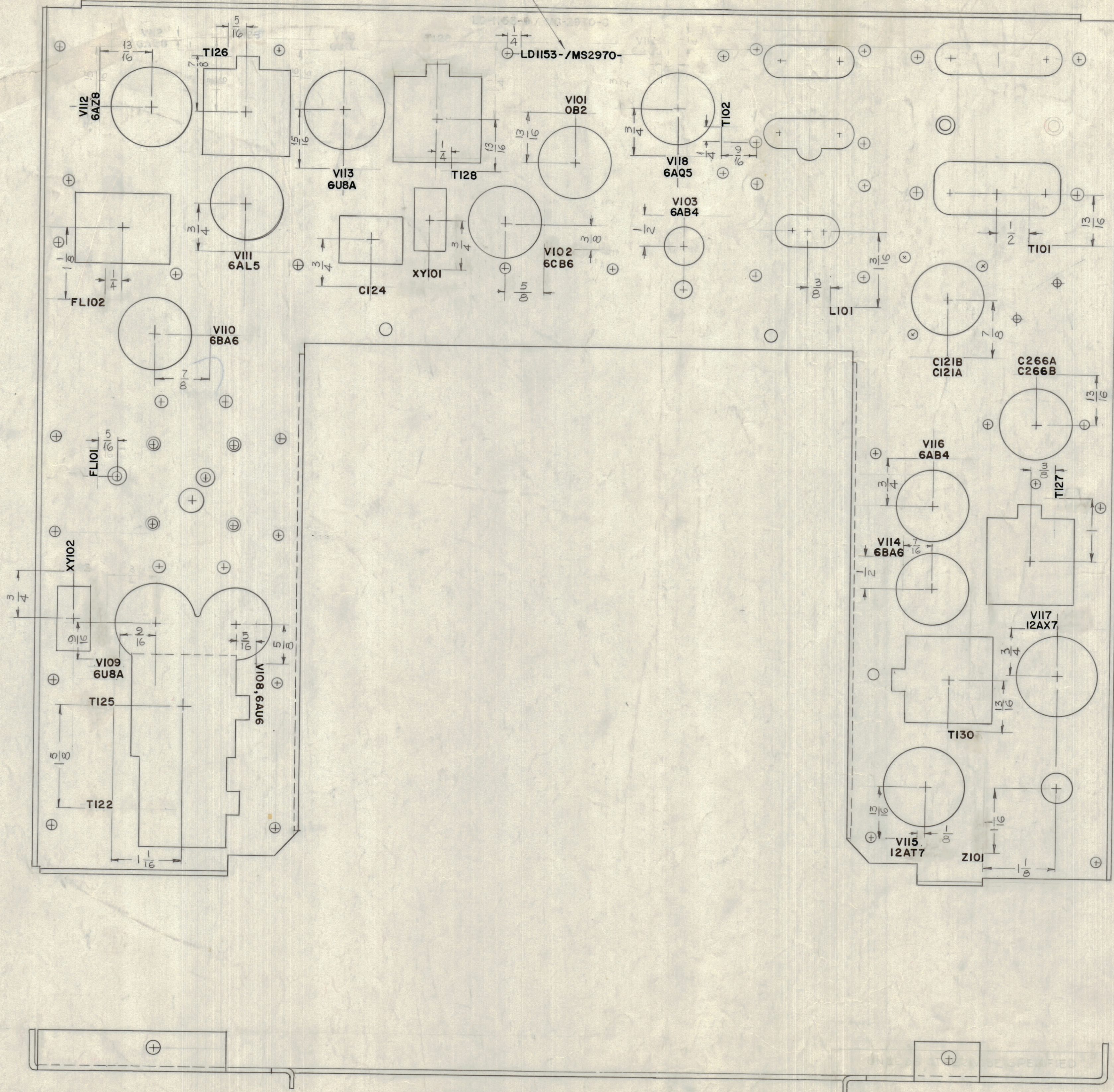

REVISIONS						
ZONE	SYM	DESCRIPTION	DATE	E.M.N. NO.	DRAFT	CHKD
~	C	REVISED & REDRAWN	7-3-63	9463		
~	D	T122, T125 THRU T128 & T130 WERE T1147 THRU T1152	9-26-63	10,024	G-D-L	
~	E	T127, T102, T125, T126, FL101, XY102, LD-1382-MS 2970C	7-14-64	11739	SRG	
~	F	V117, 12AT7, V118, 6AB4, V119, 6AU6, V118, 6AG5, RELOCATED	11-1-66	13674	NLA	

- NOTES: —
UNLESS OTHERWISE SPECIFIED
- 1) MARKING PROCESS - AS PER TMC SPECIFICATION S-727.
 - 2) LETTERING - 1/8" HIGH BLACK, GOTHIC LOCATED AS SHOWN.
 - 3) SPACING WILL BE 1/16" BETWEEN LETTER GROUPS

LD-1153 F

REF: MS-2970-C (2)

REQ'D.	ITEM	PART NUMBER	DESCRIPTION	SYMBOL
STRUMER				
LIST OF MATERIAL				
MATERIAL				
THE TECHNICAL MATERIEL CORP. MAMARONECK, NEW YORK				
FINISH				
TITLE				
LETTERING, MAIN CHASSIS (TOP)				
UNLESS OTHERWISE SPECIFIED	DRAWN	DATE	FINAL APPROVAL	DATE
DIMENSIONS ARE IN INCHES AND INCLUDE CHEMICALLY APPLIED OR PLATED FINISHES	G.D.L.	6-19-63	TFH	7-8-63
DECIMALS X ± .05 .XX ± .01 .XXX ± .005	CHECKED	DATE	DATE	
FRACTIONS ± 1/64 ANGLES ± 0° 30'	ELECT. DES.	DATE	DATE	
MECH. DES.	DATE	DATE	DATE	
LD-1153				F
SHEET 1 OF 2				REV. LTR.

QTY./UNIT	CODE	MODEL USED ON	ASSY. NO.
1		GPR-92A	

THE CONTENTS OF THIS DRAWING ARE THE EXCLUSIVE PROPERTY OF THE TECHNICAL MATERIEL CORP. ITS UNAUTHORIZED USE OR REPRODUCTION IN WHOLE OR IN PART IS STRICTLY FORBIDDEN.