

ISSUE	ITEM	CHANGED FROM	DATE	CN. NO.	DRAFTS	CHECKER	ENG. APP.	REQ.	ITEM	PART NO.	DESCRIPTION	SYMBOL
-------	------	--------------	------	---------	--------	---------	-----------	------	------	----------	-------------	--------

0 PROD RELEASE 2 JAN 74 JM

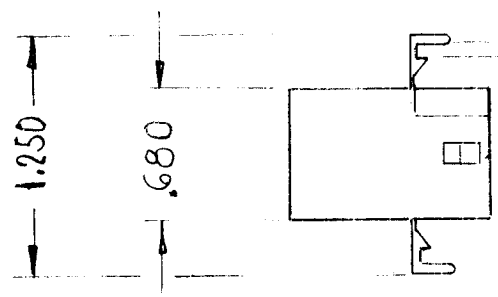

.081 MAX PNL THICKNESS

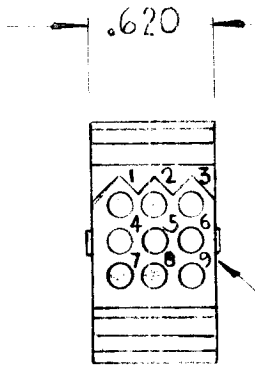

TERM. REF NOS.

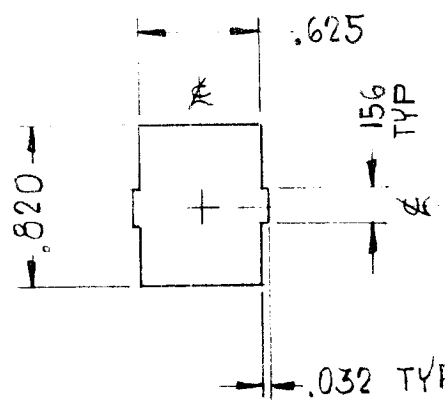

.032 TYP RECOMMENDED PANEL CUTOUT

NOTES

1. THIS CONNECTOR MATES WITH JJ10033.

MFR - MOLEX #1292R
E/W SOCKETS #1433 TL

STOCK NO'S
250133

MODEL		PROJECT NO.		ASSY. NO.		DATE		STOCK SIZE		TMC (Canada) LIMITED OTTAWA ONTARIO					
040001		A11111		JAN 2, 1974											
USED ON								MATERIAL		WEIGHT PER PC		CONNECTOR			
MAXIMUM ALLOWABLE TOLERANCES HAVE BEEN DETERMINED AND DEVIATIONS WILL BE CAUSE FOR REJECTION REMOVE ALL BURRS AND SHARP EDGES				IF IT IS FOUND DESIRABLE TO CHANGE ANY TOLERANCE OR OTHER DETAIL SPECIFIED ON THIS DRAWING NOTIFY THE PURCHASER PROMPTLY.				TYPE & TEMPER		DRAWN		ELEC. DES. APP.		MECH. DES. APP.	
												SCALE		HEAT TREAT. SPEC.	
TOLERANCES				SCALE				FINISH & SPEC. NO.		CHECKED		FINAL APPROVAL			
DEC. DIM. ± .05		.X = .05		DIMENSIONS IN INCHES UNLESS OTHERWISE SPECIFIED						JJ10034		∅			
FRAC. DIM. ± 1/64		.XX = .01		DRILL; PUNCH. COMMERCIAL STOCK SIZES AND MANUFACTURERS TOLERANCES ARE NOT INCLUDED.											
ANGULAR DIM. ± 0° 30'		.XXX = .005													