

IF IT IS FOUND DESIRABLE TO CHANGE ANY TOLERANCE OR OTHER DETAIL SPECIFIED ON THIS DRAWING NOTIFY THE PURCHASER PROMPTLY.

MAXIMUM ALLOWABLE TOLERANCES HAVE BEEN DETERMINED AND DEVIATIONS WILL BE CAUSE FOR REJECTION. REMOVE ALL BURRS AND SHARP EDGES

IM-10002

USED ON

MODEL PROJECT NO. ASSY. NO. DATE

6.8.58

NOTE: METAL PARTS TO BE NICKEL PLATED

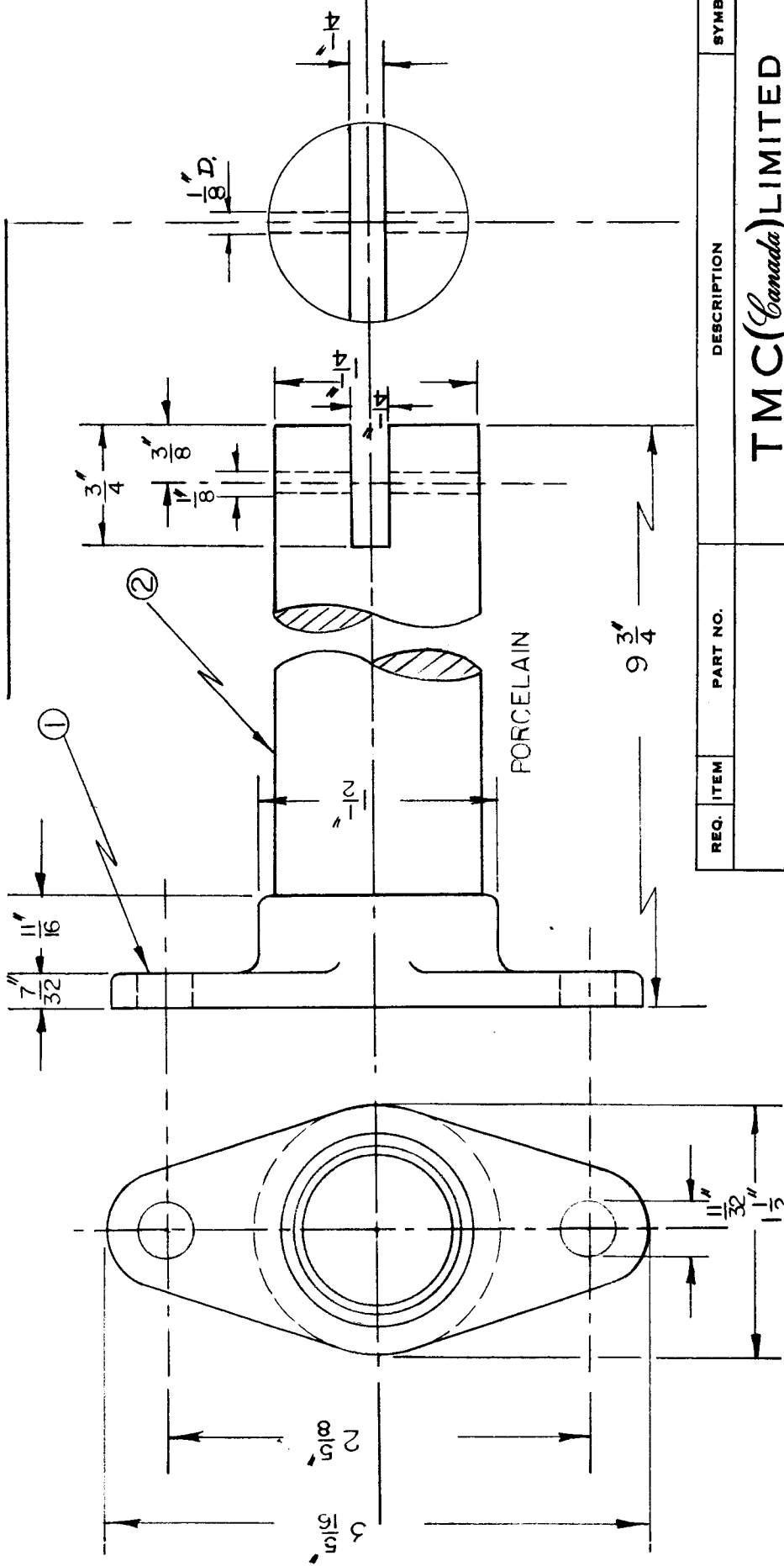

REQ. ITEM	PART NO.	DESCRIPTION	SYMBOL
		TMC (Canada) LIMITED OTTAWA ONTARIO	
		INSULATOR	
STOCK SIZE			
MATERIAL			
TYPE & TEMPER			
HEAT TREAT. SPEC.			
FINISH & SPEC. NO.			
ISSUE ITEM	CHANGED FROM	DATE	CN. NO. DRAFTS
2	MATERIAL - STEATITE		
1	BRONZE		
TOLERANCES		SCALE	CHECKER
DEC. DIM. ±			ENG. APP.
FRAC. DIM. ±			
ANGULAR DIM. ±			
DRILL, PUNCH, COMMERCIAL STOCK SIZES AND MANUFACTURERS TOLERANCES ARE NOT INCLUDED.			
DRAWN		ELEC. DES. APP.	MECH. DES. APP.
CHECKED			
FINAL APPROVAL			
IM-10002			