

TMC PART NO.	PITCH	NO OF TEETH	A	B	PRESSURE ANGLE	C	D	E	F	G	H	J	K	STYLE
GR-206-1	120	208	1.7333	1.7500	20°	.1873 ^{+0.003} _{-.0000}	.312	.062	.250	6-32			.093	1
GR-206-2		37	.3083	.3250		.1873 ^{+0.003} _{-.0000}	.312	.062	.250	6-32			.093	2
-3		298	2.4833	2.5000		.0935 ^{+0.003} _{-.0000}	.312	.062	.250	4-40			.093	1

REVISIONS						
ZONE	SYM	DESCRIPTION	DATE	E.M.N. NO.	DRAFT	CHKD
X		EXPERIMENTAL RELEASE	4-11-64			
		ORIGINAL RELEASE FOR PRODUCTION	9-14-64			
A		CLERICAL CHANGE	11-17-64			
B		ADDED STYLE "2". ADD "G" TAP TO STYLE "1". ADD COL'S "G", "K" & STYLE.	12-6-66	17397	RME	

NOTE 3
 THIS CHART TO LIST 120 PITCH
 GEARS ONLY. PRESSURE ANGLES 20°

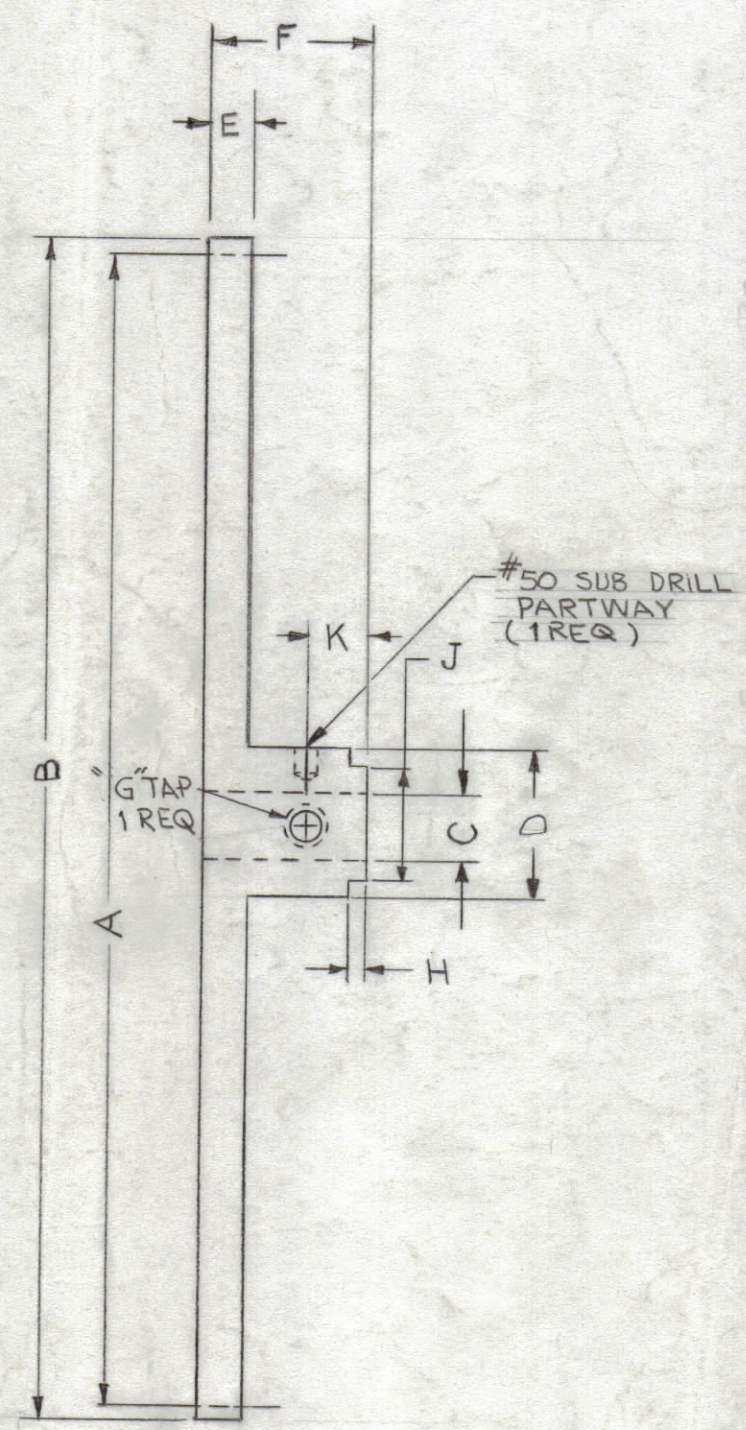

STYLE-2

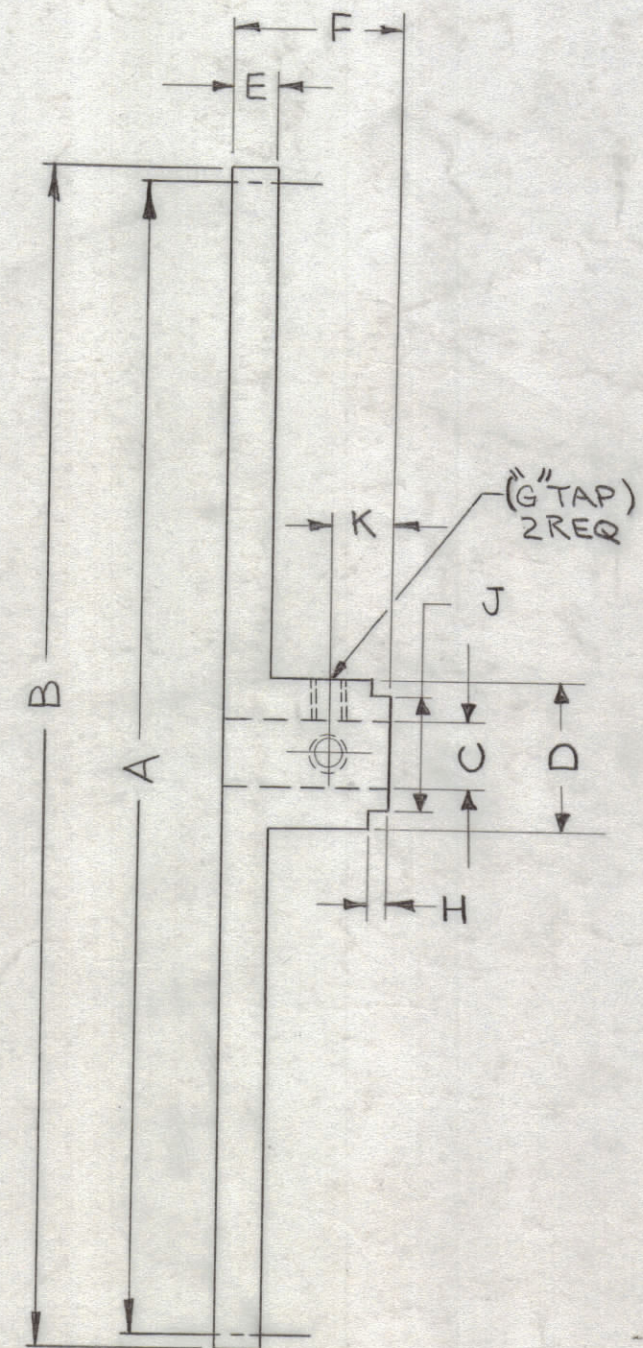

STYLE-1

GR-206 B

REQ'D.	ITEM	PART NUMBER	DESCRIPTION	SYMBOL
	T. KRUY	E3112B	LIST OF MATERIAL	
MATERIAL		# 303 STAINLESS STEEL	THE TECHNICAL MATERIEL CORP. MAMARONECK, NEW YORK	
FINISH		S104 PASSIVATE	TITLE GEAR, SPUR, HUB	
SCALE	QTY./UNIT	MODEL USED ON	ASS'Y. NO.	
		STD.	A	
UNLESS OTHERWISE SPECIFIED DIMENSIONS ARE IN INCHES AND INCLUDE CHEMICALLY APPLIED OR PLATED FINISHES		DRAWN <i>H. Krueger</i> DATE 4-11-64		FINAL APPROVAL <i>KJC</i> DATE
DECIMALS .X ± .05 .XX ± .01 .XXX ± .005	TOLERANCES	FRACTIONS ± 1/64 ANGLES ± 0° 30'	CHECKED <i>@</i> DATE	ELECT. DES. DATE
		MECH. DES. <i>T. Krueger</i> DATE		GR-206 B
			SHEET	REV. LTR.

STANDARD DRAWING

NOTES

THE CONTENTS OF THIS DRAWING ARE THE EXCLUSIVE PROPERTY OF THE TECHNICAL MATERIEL CORP. ITS UNAUTHORIZED USE OR REPRODUCTION IN WHOLE OR IN PART IS STRICTLY FORBIDDEN.