

REQ. PER UNIT	MODEL	USED ON	DATE
1	HFR-2	ASSY. NO. A3624	2-11-64
1	HFR-2	ASSY. NO. A3625	9-11-64

GR 204 A

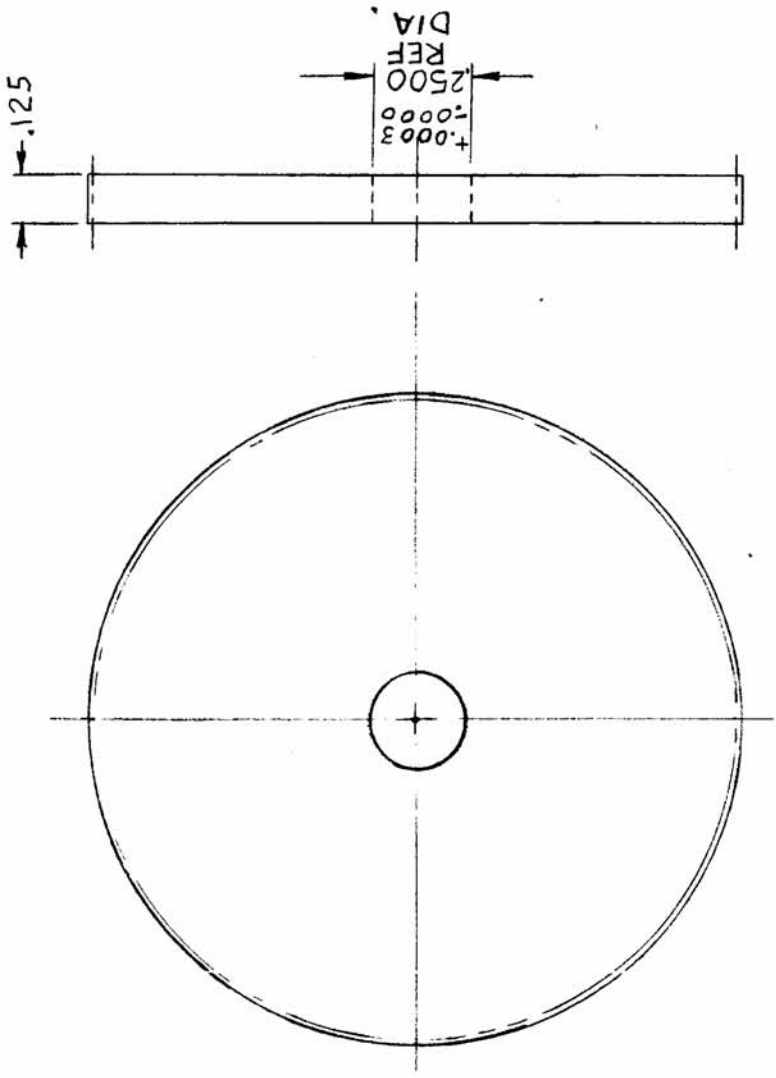

GEAR DATA	
PITCH	48
NO OF TEETH	80
P. D.	1.6666
O. D.	1.7083
PRESSURE ANGLE	20°

NOTE: REMOVE ALL BURRS & SHARP EDGES

A	DIM. .125 ADDED. EXP. RELEASE FOR PRODUCTION	2-2-65	13304	J.L.	J.L.	J.L.	9-11-64	9-11-64	2:1	SCALE	DATE	CH. NO.	DRAFTS	CHECKER	ENG. APP.
X1	3 A HOLES = .062-.1065 DIA. & 3 B HOLES = .187 DIA DELETED	7-31-64	#	G.D.L.	#	#	7-31-64	7-31-64	2:1	SCALE	DATE	CH. NO.	DRAFTS	CHECKER	ENG. APP.
X	EXP. RELEASE	3/1/68	#	#	#	#	3/1/68	3/1/68	2:1	SCALE	DATE	CH. NO.	DRAFTS	CHECKER	ENG. APP.
SYM	DESCRIPTION														
	UNLESS OTHERWISE SPECIFIED DIMENSIONS ARE IN INCHES AND INCLUDE CHEMICALLY APPLIED OR PLATED FINISHES														
	TOLERANCES														
	DECIMALS														
	FRACTIONS														
	ANGLES														
	± .005														
	± .01														
	± .30'														
	CODE														
	S401-232														
	FINISH & SPEC. NO.														
	S104 PASSIVATE														
	TYPE & TEMPER														
	# 303														
	HEAT TREAT. SPEC.														
	—														
	MATERIAL														
	STAINLESS STEEL														
	STOCK SIZE														
	—														
	PART NO.														
	—														
	DESCRIPTION														
	THE TECHNICAL MATERIEL CORP. MAMARONECK. NEW YORK														
	GEAR, SPUR														
	DRAWN														
	—														
	CHECKED														
	—														
	FINAL APPROVAL														
	—														
	ELEC. DES. APP. MECH. DES. APP.														
	—														
	GR 204 A														