

C	TMC NO.	MFG. NO.	PITCH	PITCH DIA.	FACE	HOLE	HUB DIA.	HUB PROJ.		LEAD	LEAD ANGLE	PRESSURE ANGLE	NO. OF THREADS	THREAD TYPE	FINISH See chart	RE TMC MATING GEAR
								Proj	A							
	GR-143-1	QVH	16	.625	1"	1/4	.46	1/4	1/8	.7854	21° 48'	20°	4	RIGHT HAND	A	GR-142,144
	GR-143-2	HQVH	16	.625	1"	5/16	.46	1/4	1/8	.7854	21° 48'	20°	4	RIGHT HAND	B	GR-142,144
	GR-143-3	GQVH	16	.625	1"	5/16	.46	1/4	1/8	.7854	21° 48'	20°	4	RIGHT HAND	C	GR-142,144
	GR-143-4	HQVH	17	.670	1"	5/16	.46	1/4	1/8	.787	68° 12'	20°	4	RIGHT HAND	B	GR-216

GR-143

A	NO FINISH
B	THREADS POLISHED BUT NOT GROUND
C	THREADS POLISHED AND GROUND

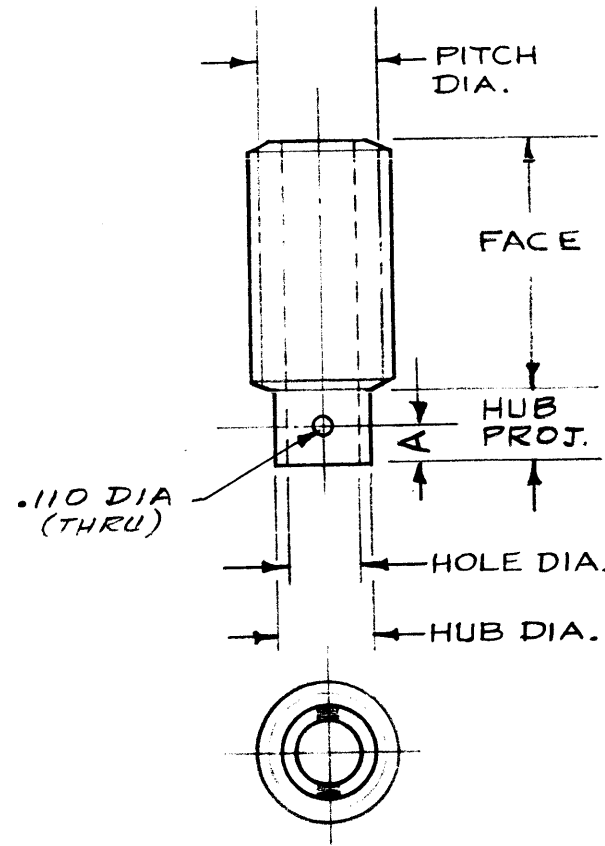

DO NOT TO PERSONS REPRODUCE THIS DRAWING

THE TECHNICAL MATERIEL CORPORATION claims proprietary right in the material disclosed hereon. This drawing is issued in confidence for engineering information only and may not be reproduced or used to manufacture anything shown hereon without permission from THE TECHNICAL MATERIEL CORPORATION to the user. This drawing is loaned for mutual assistance and is subject to recall at any time.

Property of:

THE TECHNICAL MATERIEL CORPORATION
MAMARONECK, NEW YORK

STANDARD DRAWING

ISSUE	ITEM	CHANGED FROM	DATE	CH. NO.	DRAFTS	CHECKER	ENG. APP.
C	2	ON FIN. CHART LETT. C & B ADD. GR-143-4 ADDED	9.29.64	12482	hbs	@	
B	1	HUB PROJ. CLARIFIED	6/5/59		hde		
A	1	REDRAWN - CHARTS ADDED. GR-143-2 WAS GR-143	5/18/59	1046	16	hde	

TOLERANCES: DEC. DIM. ±, FRAC. DIM. ±, ANGULAR DIM. ±

SCALE: 5-401-15

MAXIMUM ALLOWABLE TOLERANCES HAVE BEEN DETERMINED AND ANY DEVIATIONS WILL BE CAUSE FOR REJECTION. REMOVE ALL BURRS AND SHARP EDGES

REQ. PER UNIT	MODEL	PROJECT NO.	ASS'Y. NO.	DATE
				5-18-59

USED ON

REQ. ITEM	PART NO.	DESCRIPTION	SYMBOL
		THE TECHNICAL MATERIEL CORP. MAMARONECK, NEW YORK	
	STAINLESS STEEL	GEAR, WORM	
		5/18/59	
		GR-143	C