

IF IT IS FOUND DESIRABLE TO CHANGE ANY TOLERANCE OR OTHER DETAIL SPECIFIED ON THIS DRAWING NOTIFY THE PURCHASER PROMPTLY.

MAXIMUM ALLOWABLE TOLERANCES HAVE BEEN DETERMINED AND DEVIATIONS WILL BE CAUSE FOR REJECTION. REMOVE ALL BURRS AND SHARP EDGES

GA-128

$\frac{1}{4}$ (.250) D. 6 HOLES REQ.

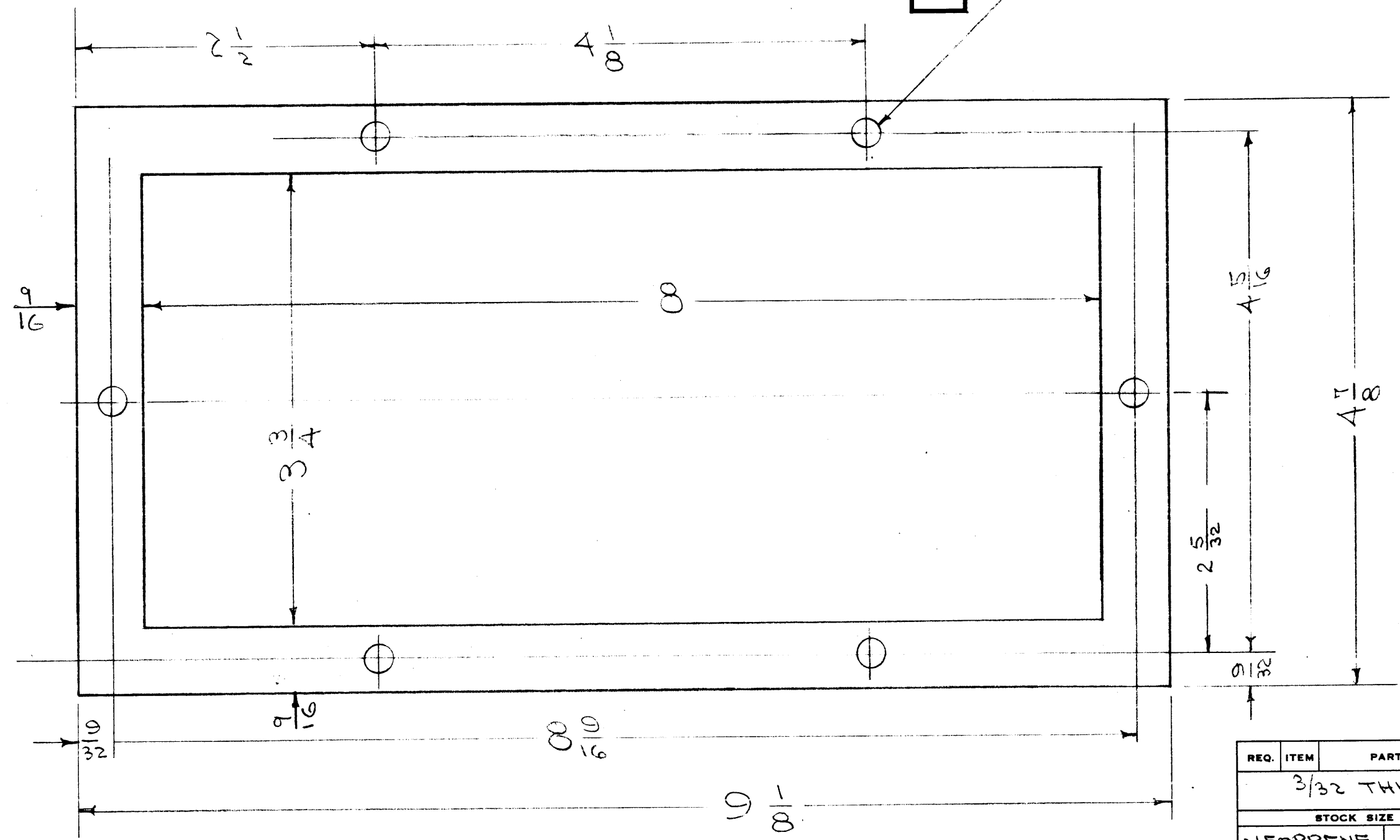

REQ.	ITEM	PART NO.	DESCRIPTION	SYMBOL
		3/32 THK.	THE TECHNICAL MATERIEL CORP. MAMARONECK. NEW YORK	
		NEOPRENE	GASKET, REAR DOOR	
			C. P. M. O.	
			CS2 9/21/54	
			DRAWN	ELEC. DES. APP.
			MECH. DES. APP.	
			CHECKED	FINAL APPROVAL
				GA-128

ISSUE	ITEM	CHANGED FROM	DATE	CN. NO.	DRAFTS	CHECKER	ENG. APP.

UNIT	MODEL	PROJECT NO.	ASS'Y. NO.	DATE
1	CPMO			9-21-54

SCALE:
DRILL, PUNCH, COMMERCIAL STOCK
SIZES AND MANUFACTURERS
TOLERANCES ARE NOT INCLUDED.

TOLERANCES
DEC. DIM. ±
FRAC. DIM. ± 1/64
ANGULAR DIM. ±

C	TMC NO.	"A" (I.D.)	"B" (O.D.)	"C"	BURR METER	USED ON	QUAN	MFG.	MFG.#
	GA-138 - 1	1/2"	1"	1/16		TER-500	4		
- 2	13/64	1 1/2	1/16	55	ALL CAB. MOUNT. GPP'S	4			
- 3	1 1/4	2 3/8	1/16		VRA-5,6	1	S-401-135	RA-940	
- 4	2 1/8	3 1/2	1/16		VRA-5,6	1	S-401-135	RA-135	
- 5	1 7/8	2 1/2	1/16		VRA-5,6	1	S-401-135		
- 6	1/2	3/4	1/16	6	TR-151				
GA-138									

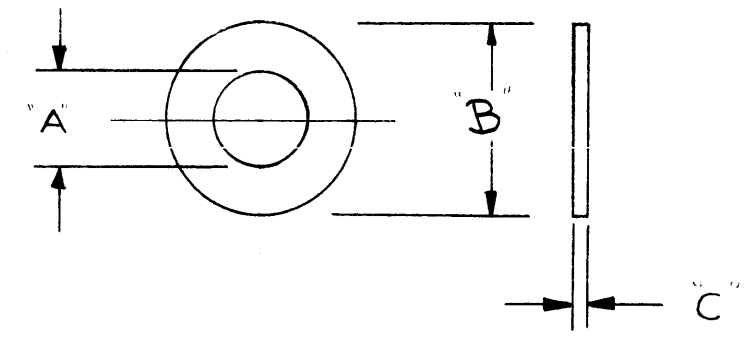

NOT TO BE LOANED TO PERSONS RECEIVING THIS DRAWING

THE TECHNICAL MATERIEL CORPORATION claims proprietary right in the material disclosed hereon. This drawing is issued in confidence for engineering information only and may not be reproduced or used in manufacture anything shown hereon without permission from THE TECHNICAL MATERIEL CORPORATION to the user. This drawing is loaned for mutual assistance and is subject to recall at any time.

Property of:

THE TECHNICAL MATERIEL CORPORATION
MAMARONECK, NEW YORK

SYM	DESCRIPTION	DATE	CH. NO.	DRAFTS	CHECKER	ENG. APP.
C	GA-138-6 ADDED	4-4-62	6584	AE	AS	AK
B	REDRAWN; MFG. NO., MFG. NO., COL. ADDED	9-22-61	5590	AE	al	AK
	GA-138-3,4,5 ADDED					

UNLESS OTHERWISE SPECIFIED:
DIMENSIONS ARE IN INCHES
TOLERANCES ON
FRACTIONS ± 1/64 DECIMALS ± .005 ANGLES ± 1/2°

SCALE:
MAXIMUM ALLOWABLE TOLERANCES HAVE BEEN DETERMINED AND ANY DEVIATIONS WILL BE CAUSE FOR REJECTION.
REMOVE ALL BURRS AND SHARP EDGES

REQ. PER UNIT	MODEL	SECTION	ASS'Y. NO.	DATE
				9-22-61

REQ. ITEM	PART NO.	DESCRIPTION	SYMBOL
		THE TECHNICAL MATERIEL CORP. MAMARONECK, NEW YORK	
		STOCK SIZE	
		NEOPRENE	GASKET
		MATERIAL	
		TYPE & TEMPER	
		HEAT TREAT. SPEC.	
		FINISH & SPEC. NO.	
		ELEC. DES. APP.	
		MECH. DES. APP.	
		GA-138	C

TMC No.	A	B	C	D	E	F	T	N(Corners)	Material	Duro	Formerly Was	FINISH & SPEC. NO.
GA-149-1	1- $\frac{9}{32}$	1- $\frac{3}{32}$	1- $\frac{1}{32}$	1- $\frac{3}{32}$	1- $\frac{3}{32}$	1- $\frac{1}{8}$	1- $\frac{3}{32}$	$\frac{1}{16} \times \frac{1}{16}$	Neoprene	45	—	
GA-149-2	3	3	1- $\frac{3}{4}$	2- $\frac{1}{8}$	2- $\frac{1}{8}$	5- $\frac{1}{16}$	1- $\frac{1}{8}$	$\frac{1}{16} \times \frac{1}{16}$	Neoprene	45	—	
GA-149-3	1- $\frac{1}{16}$	1- $\frac{1}{16}$	3- $\frac{3}{8}$	1- $\frac{1}{2}$	1- $\frac{1}{2}$	1- $\frac{1}{64}$	3- $\frac{3}{32}$	$\frac{1}{16} \times \frac{1}{16}$	Neoprene	45	GA-119	
GA-149-4	1	1	2- $\frac{1}{32}$	2- $\frac{3}{32}$	2- $\frac{3}{32}$	1- $\frac{1}{8}$	3- $\frac{3}{32}$	$\frac{1}{16} \times \frac{1}{16}$	Neoprene	45	GA-111	
GA-149-5	1- $\frac{1}{16}$	1- $\frac{1}{16}$	5- $\frac{1}{8}$	2- $\frac{3}{32}$	2- $\frac{3}{32}$	1- $\frac{1}{8}$	3- $\frac{3}{32}$	$\frac{1}{16} \times \frac{1}{16}$	Neoprene	45	GA-106	
GA-149-6	1- $\frac{3}{16}$	1- $\frac{3}{16}$	3- $\frac{1}{4}$	2- $\frac{3}{32}$	2- $\frac{3}{32}$	1- $\frac{1}{8}$	3- $\frac{3}{32}$	$\frac{1}{16} \times \frac{1}{16}$	Neoprene	45	GA-116	
GA-149-7	2	2	1	1- $\frac{1}{16}$	1- $\frac{1}{16}$	1- $\frac{1}{4}$	3- $\frac{3}{32}$	$\frac{1}{8} \times \frac{1}{8}$	Neoprene	45	GA-136-1	
GA-149-8	2	2	1- $\frac{1}{4}$	1- $\frac{1}{16}$	1- $\frac{1}{16}$	1- $\frac{1}{4}$	3- $\frac{3}{32}$	$\frac{1}{8} \times \frac{1}{8}$	Neoprene	45	GA-136-2	
GA-149-9	3	3	1- $\frac{5}{16}$	2- $\frac{1}{8}$	2- $\frac{1}{8}$	5- $\frac{1}{16}$	1- $\frac{1}{16}$	—	Neoprene	35-45	—	BLACK NATURAL
GA-149-10	3- $\frac{1}{2}$	3- $\frac{1}{2}$	2- $\frac{1}{2}$	2- $\frac{1}{8}$	2- $\frac{1}{8}$	1- $\frac{1}{4}$	3- $\frac{3}{32}$	$\frac{1}{8} \times \frac{1}{8}$	NEOPRENE	45	—	BLACK NATURAL
GA-149-11	1- $\frac{3}{4}$	1- $\frac{3}{4}$	1- $\frac{1}{2}$	1- $\frac{3}{8}$	1- $\frac{3}{8}$	1- $\frac{1}{64}$	3- $\frac{3}{32}$	$\frac{1}{8} \times \frac{1}{8}$	Neoprene	45	—	BLACK NATURAL
GA-149-12	1- $\frac{5}{8}$	1- $\frac{1}{2}$	1- $\frac{3}{16}$	1- $\frac{1}{8}$	1- $\frac{1}{8}$	9- $\frac{1}{64}$	3- $\frac{3}{32}$	—	NEOPRENE	45	—	BLACK NATURAL

GA-149

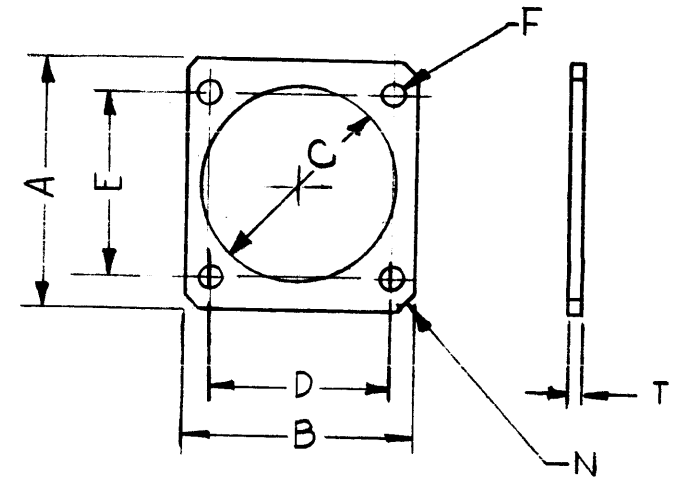

THE TECHNICAL MATERIAL CORPORATION claims copyright in the design of the gasket shown in this drawing. This drawing is loaned to you for your own use as information only and may not be copied, sold or used to manufacture anything shown herein without permission from THE TECHNICAL MATERIAL CORPORATION to the user. This drawing is loaned for mutual assistance and is subject to recall at any time.

Property of: _____

THE TECHNICAL MATERIAL CORPORATION
MAMARONECK, NEW YORK

F	GA149-12 ADDED	6-23-89	21813	GDL			
E	GA149-11 ADDED	11-23-77	21592	YRB	K.P.	R.P.	
D	GA 149-10 ADDED TO CHART	10.6.64	12541	W.B.			
C	FINISH & SPEC ADDED TO CHART	2-4-63	8143				
B	GA-149-9 ADDED TO CHART						
A	GA-149-3,4,5,6,7,8 ADDED DRAWN OVER FROM 1-SIZE	10-17-61	5724	EG	EG	EG	
SYM	DESCRIPTION	DATE	CH. NO.	DRAFTS	CHECKER	ENG. APP.	

UNLESS OTHERWISE SPECIFIED:

DIMENSIONS ARE IN INCHES
TOLERANCES ON
FRACTIONS $\pm 1/64$ DECIMALS $\pm .005$ ANGLES $\pm 1/2^\circ$

SCALE:

MAXIMUM ALLOWABLE TOLERANCES HAVE BEEN DETERMINED AND ANY DEVIATIONS WILL BE CAUSE FOR REJECTION. REMOVE ALL BURRS AND SHARP EDGES

STANDARD DRAWING

REQ. PER UNIT	RAC SERIES	MODEL	SECTION	ASS'Y. NO.	DATE
				P/A-2092	10-17-61
USED ON					

NOTE: Durometer Rating Tol. = ± 5

REQ.	ITEM	PART NO.	DESCRIPTION	SYMBOL
THE TECHNICAL MATERIAL CORP. MAMARONECK, NEW YORK				
GASKET				
MATERIAL				
		EG	W.B.	16
TYPE & TEMPER		HEAT TREAT. SPEC.	DRAWN	CHECKER
				FINAL APPROVAL
				GA-149
FINISH & SPEC. NO.		ELEC. DES. APP.	MECH. DES. APP.	F

REVISIONS

SYM	DESCRIPTION	DATE	E.M.N. NO.	DRAFT	CHKD	APPD
-----	-------------	------	------------	-------	------	------

GA-152

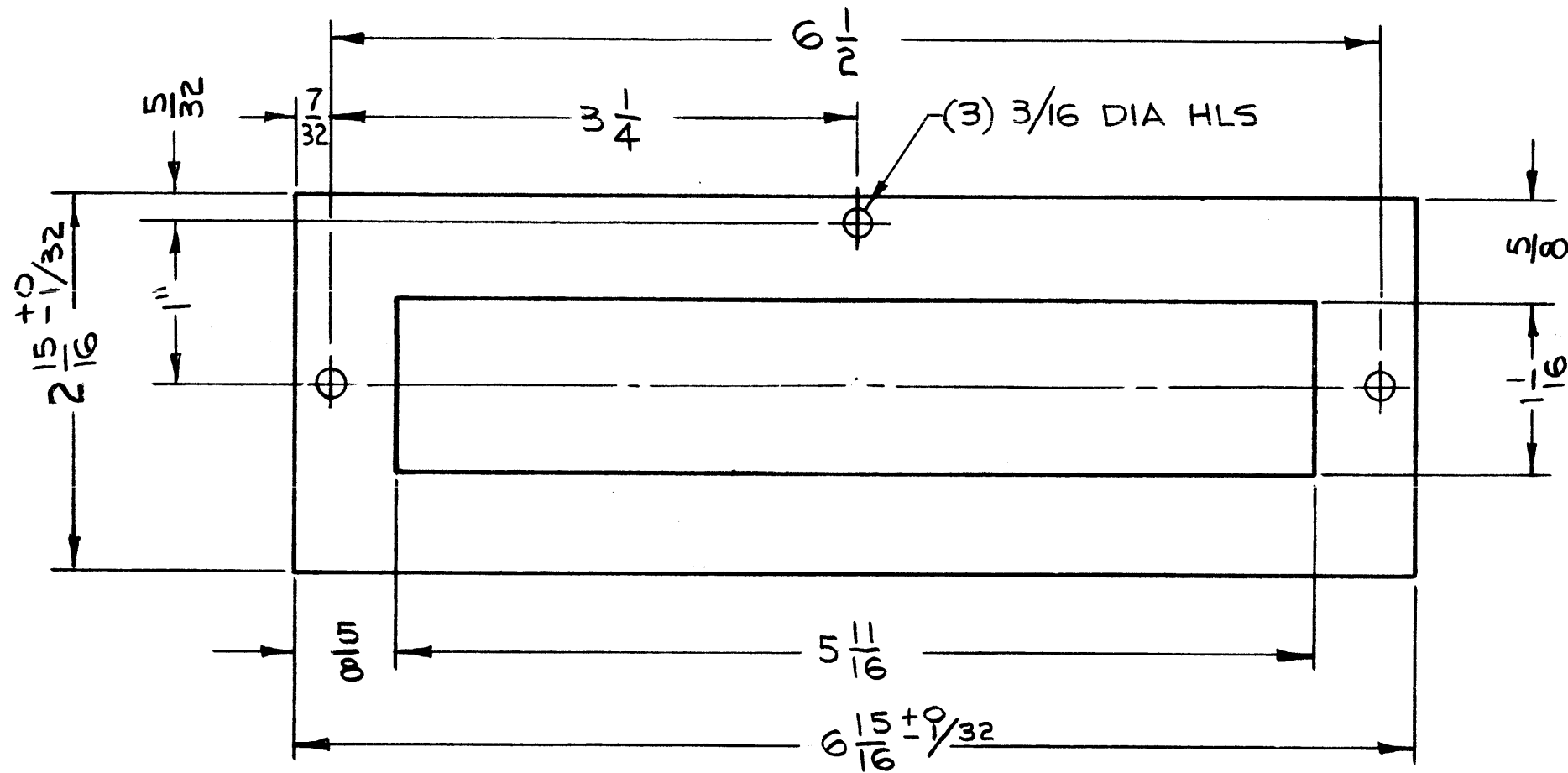

NOTE:

- 30 DUROMETER BLACK NEOPRENE SHEET $1/16$ THK.

REQ'D.	ITEM	PART NUMBER	DESCRIPTION	SYMBOL
LIST OF MATERIAL				
MATERIAL			THE TECHNICAL MATERIEL CORP. MAMARONECK, NEW YORK	
FINISH			TITLE	
SEE NOTE			GASKET, PRESSURE TANK	
UNLESS OTHERWISE SPECIFIED DIMENSIONS ARE IN INCHES AND INCLUDE CHEMICALLY APPLIED OR PLATED FINISHES			DRAWN <i>JWZ</i>	DATE 9/27/62
DECIMALS .X ± .05 .XX ± .01 .XXX ± .005			CHECKED <i>file</i>	DATE 2/23/63
FRACTIONS ± 1/64 ANGLES ± 0° 30'			ELECT. DES. <i>TAK</i>	DATE 1/3/63
TOLERANCES			MECH. DES. <i>TAK</i>	DATE 1/3/63
THE CONTENTS OF THIS DRAWING ARE THE EXCLUSIVE PROPERTY OF THE TECHNICAL MATERIEL CORP. ITS UNAUTHORIZED USE OR REPRODUCTION IN WHOLE OR IN PART IS STRICTLY FORBIDDEN.			FINAL APPROVAL <i>BP</i>	DATE
NOTES			GA-152	REV. LTR.

2	RAK-21	A-3125
Q'TY./UNIT	MODEL USED ON	ASS'Y. NO.
SCALE NO SCALE	CODE A	

REVISIONS						
SYM	DESCRIPTION	DATE	E.M.N. NO.	DRAFT	CHKD	APPD
A	DWG UPDATED PER EMN. 10193	10/16/69	10193	LRD	MYT	WBE

TMC PART NO.	MFG PART NO.	MIL. STD. NO.	DIMENSIONS		MATERIAL	DUROMETER READING	NOMINAL SIZE	STYLE
			"A"	"B"				
GA-158-1								P
GA-158-2	GRC27-31		1.850±.001	.210±.005	1183 BUNA-N	70	3/16X1-7/8X2/1/4	P
GA-158-3	GRC27-43		3.350±.015	.210±.005	1183 BUNA-N	70	3/16X3-3/8X3/3/4	P
GA-158-4								P
GA-158-5		MS29513-21	0.926±.006	0.070±.003	BUNA-N	72		R

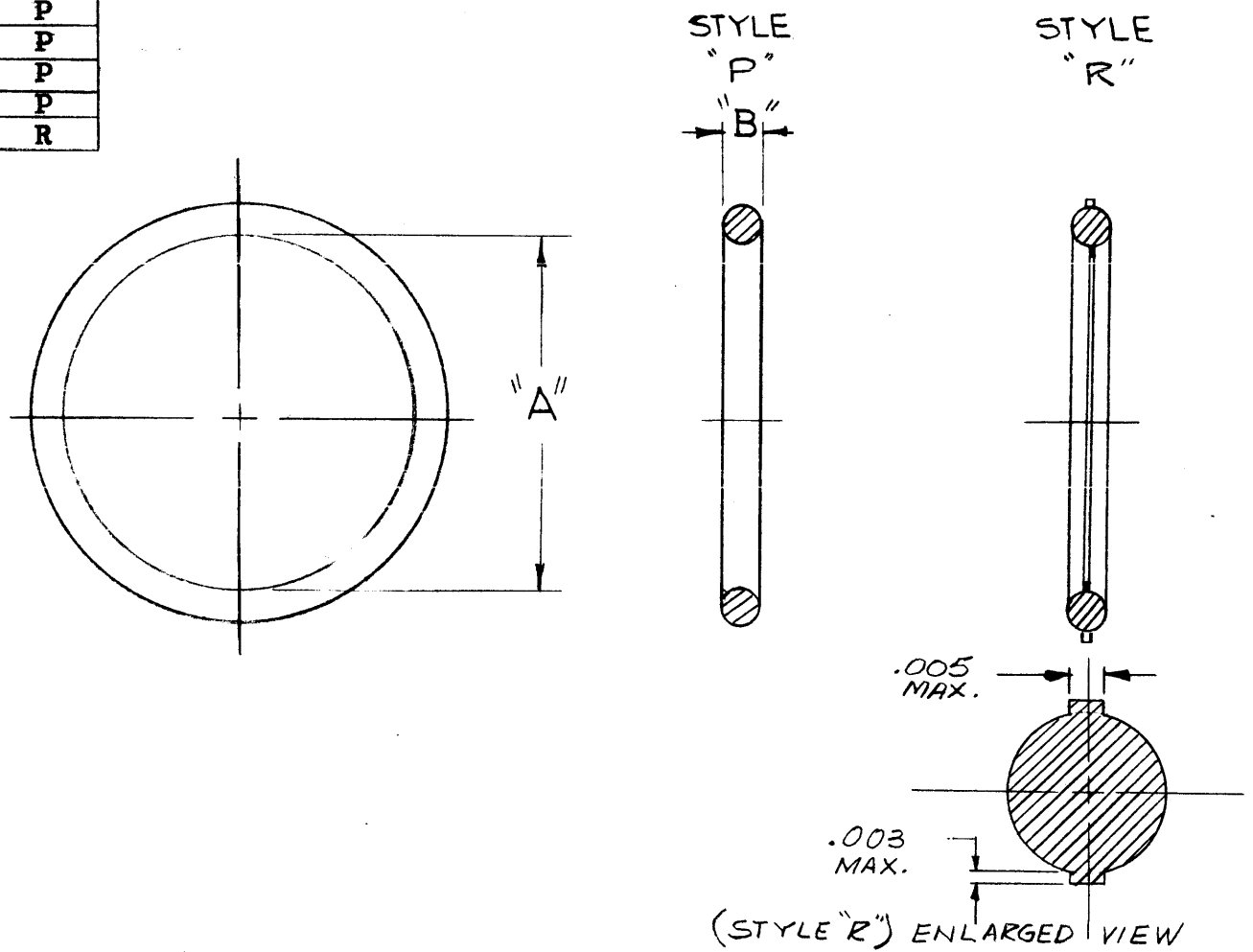

* NOTE: CONFORMS WITH MIL-P-5315

INSPECTION NOTE: GASKET MUST BE ABLE TO RECOVER WHEN DEFORMED AT -30°F. TEST FIVE SAMPLES FROM EACH SHIPMENT.

PURCHASING NOTE: 1225 BUNA-N MATERIAL MAY BE SUBSTITUTED ON DETAILS CALLING FOR 1183 BUNA-N MATERIAL.

REQ'D.	ITEM	PART NUMBER	DESCRIPTION	SYMBOL
A. MARTINENGLO LIST OF MATERIAL				
MATERIAL		THE TECHNICAL MATERIEL CORP. MAMARONECK, NEW YORK		
FINISH		TITLE "O" RING		
UNLESS OTHERWISE SPECIFIED DIMENSIONS ARE IN INCHES AND INCLUDE CHEMICALLY APPLIED OR PLATED FINISHES				
DECIMALS	TOLERANCES		FRACTIONS	
.X ± .05			± 1/64	
.XX ± .01			ANGLES	
.XXX ± .005			± 0° 30'	
DRAWN	G.D.L.	DATE	8-7-63	FINAL APPROVAL
CHECKED	<i>[Signature]</i>	DATE	9/10/63	<i>BP</i>
ELECT. DES.	<i>[Signature]</i>	DATE	9/12/63	GA-158
MECH. DES.		DATE		A
SHEET				REV. LTR.

1	TCA-85/EIA-51625	ASS'Y. NO.
QTY./UNIT	MODEL USED ON	CODE
SCALE	DO NOT SCALE	SAOI-242

THE CONTENTS OF THIS DRAWING ARE THE EXCLUSIVE PROPERTY OF THE TECHNICAL MATERIEL CORP. ITS UNAUTHORIZED USE OR REPRODUCTION IN WHOLE OR IN PART IS STRICTLY FORBIDDEN.

NOTES

GA160

REVISIONS					
SYM	DESCRIPTION	DATE	E.M.N. NO.	DRAFT	CHKD
Ø	ORIGINAL RELEASE FOR PRODUCTION	1/14/66	Ø		1/10

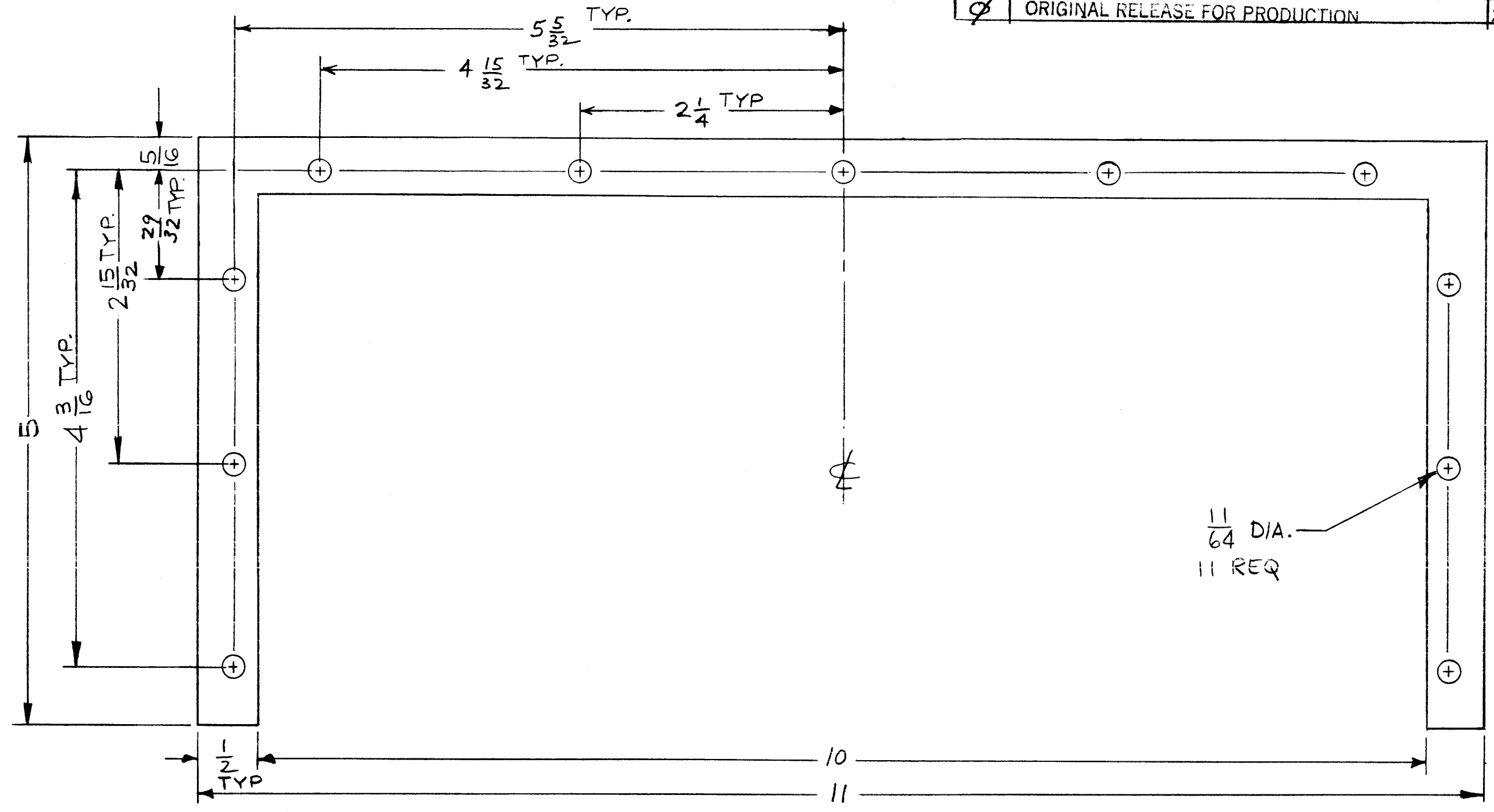

11/64 DIA.
11 REQ

REQ'D.	ITEM	PART NUMBER	DESCRIPTION	SYMBOL
LIST OF MATERIAL XGA-102				
MATERIAL		THE TECHNICAL MATERIEL CORP. MAMARONECK, NEW YORK		
1/16" NEOPRENE		TITLE GASKET, HOOD		
FINISH		DRAWN E.D. DATE 10-6-65		
UNLESS OTHERWISE SPECIFIED DIMENSIONS ARE IN INCHES AND INCLUDE CHEMICALLY APPLIED OR PLATED FINISHES		CHECKED J.D. DATE 1-14-66		FINAL APPROVAL [Signature] DATE 1/14/66
DECIMALS .X ± .05 .XX ± .01 .XXX ± .005		ELECT. DES. A. Suddles DATE 1-10-66		GA160
FRACTIONS ± 1/64 ANGLES ± 0° 30'		MECH. DES. DATE		Ø
TOLERANCES		SHEET		REV. LTR.

2	TOC-5	
Q'TY./UNIT	MODEL USED ON	ASS'Y. NO.
SCALE FULL	CODE	
THE CONTENTS OF THIS DRAWING ARE THE EXCLUSIVE PROPERTY OF THE TECHNICAL MATERIEL CORP. ITS UNAUTHORIZED USE OR REPRODUCTION IN WHOLE OR IN PART IS STRICTLY FORBIDDEN.		

NOTES

TMC PART NO.	MFG. PART NO.	MATERIAL	W	T	STYLE
GA 163-1	20-40211	SN/CU/FE	3/16	1/16	I
GA 163-2	20-40226	SN/CU/FE	3/8	1/16	I
GA 163-3	20-42215	SN/CU/FE	3/8	3/32	II
GA 163-4	20-40223	SN/CU/FE	5/16	3/16	I

REVISIONS						
ZONE	LTR	DESCRIPTION	DATE	E.M.N.NO	DRAFT	CHKD APPD
	X	EXP. RELEASE	10/9/69		✓	
	Ø	ORIGINAL RELEASE	10/11/69		Ⓢ	

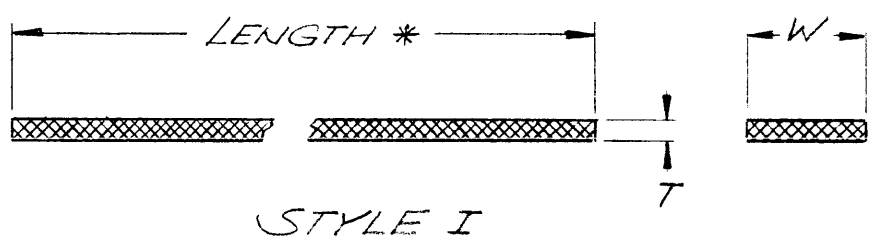

STYLE I

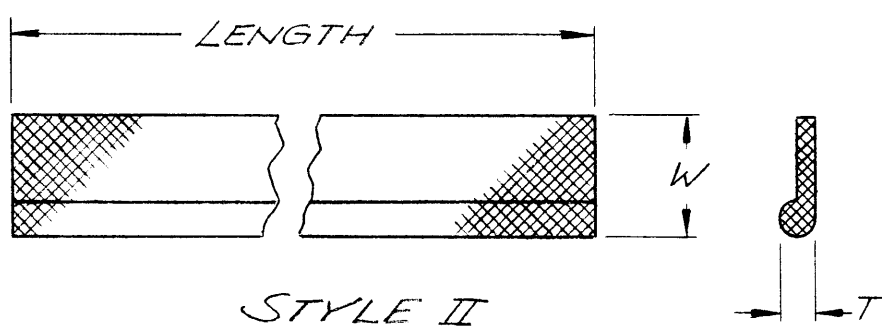

STYLE II

* NOTE:
PURCHASED IN BULK ROLLS
AND CUT TO LENGTH AS REQ'D.

QTY / UNIT	MODEL USED ON	ASS'Y NO.
	DDRR - 10K	RAK 127
	DDR - 10K	RAK 127
APPLICATION		
CODE	S 401 - 503	

NOTICE TO PERSONS RECEIVING THIS DRAWING
THE TECHNICAL MATERIEL CORPORATION claims proprietary right in the material disclosed hereon. This drawing is issued in confidence for engineering information only and may not be reproduced or used to manufacture anything shown hereon without permission from THE TECHNICAL MATERIEL CORPORATION to the user. This drawing is loaned for mutual assistance and is subject to recall at any time.

UNLESS OTHERWISE SPECIFIED
DIMENSIONS ARE IN INCHES
AND INCLUDE CHEMICALLY APPLIED
OR PLATED FINISHES

DECIMALS	FRACTIONS
.X ± .05	1/64
.XX ± .01	TOLS. ANGLES
.XXX ± .005	0° .30'

MATERIAL

FINISH

REQ'D	ITEM	PART NUMBER	DESCRIPTION	SYM.
LIST OF MATERIAL				
THE TECHNICAL MATERIEL CORP. MAMARONECK, NEW YORK				
GASKET SHIELDING, R.F. I				
SIZE	CODE IDENT. NO.	DWG NO.	ISSUE	
B	82679	GA 163	Ø	
SCALE			SHEET	OF