

# STANDARD DRAWING

THE CONTENTS OF THIS DRAWING ARE THE EXCLUSIVE PROPERTY OF THE TECHNICAL MATERIEL CORP. ITS UNAUTHORIZED USE OR REPRODUCTION IN WHOLE OR IN PART IS STRICTLY FORBIDDEN.

TMC PART NO.	MFR'S PART NO.	A	B	C	USE WITH SCREW SIZE	REQ. PER UNIT
FW 101-1	972402(6)	5/16	.140	3/64	6	
FW 101-2	972701	9/16	.260	1/16	1/4	
FW 101-3	972301	.281	.115	.047	4	
FW 101-4	972501	.375	.170	.062	8	
FW 101-5	972601	.437	.200	.062	10	

MODEL	DATE
STANDARD	2-6-62

USED ON  
ASSY. NO. FW-101  
D

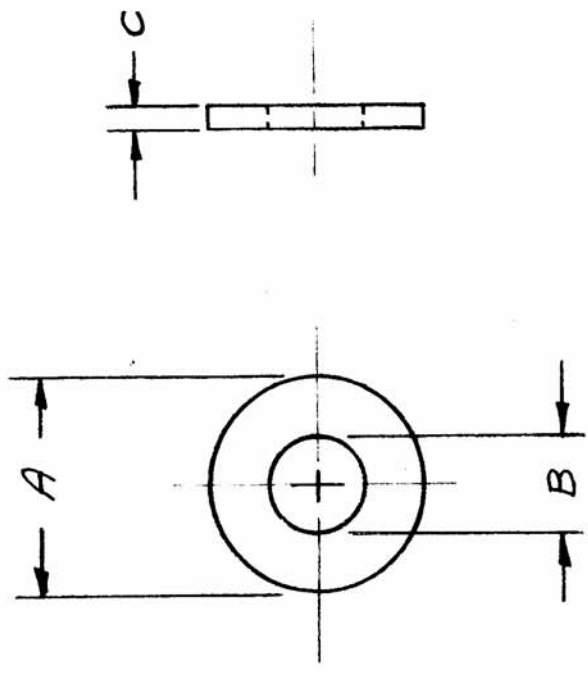

## STANDARD DRAWING

REQ. ITEM	PART NO.	DESCRIPTION	SYMBOL
	ANGER	THE TECHNICAL MATERIEL CORP. MAMARONECK, NEW YORK	
STOCK SIZE		WASHER, FLAT, NYLON	
MATERIAL		NYLON	
TYPE & TEMPER	HEAT TREAT. SPEC.	CHECKED	FINAL APPROVAL
		W. ANGER	FW-101
FINISH & SPEC. NO.		ELEC. DES. APP. MECH. DES. APP.	

ON CHART: IT (2) MFG PIN WAS #1/4" ITS. 3, 4 & 5 ADD. DEC. ±.500 TOL. DELE.	12-11-64	13105	92	92	
DWG CLARIFIED	10/7/63	10221	102	102	
ADDED CODE # 9401-180	7-26-63	9667	AR	SAW	
ON FW-101-1, DIMS. WAS 9/16" CL. 1/32. MFR'S PART NO. WAS "TMC CODE NO."	7-3-63	9447	92	M.C.	
DESCRIPTION	DATE	CH. NO.	DRAFTS	CHECKER	ENG. APP.
UNLESS OTHERWISE SPECIFIED: DIMENSIONS ARE IN INCHES TOLERANCES ON FRAC. ± 1/64 DEC. ± ANGLES ± 1/20	SCALE: 5401-180				

MAXIMUM ALLOWABLE TOLERANCES HAVE BEEN DETERMINED AND ANY DEVIATIONS WILL BE CAUSE FOR REJECTION. REMOVE ALL BURRS AND SHARP EDGES