

STANDARD DRAWING

APPLICATION DATA								
TMC PART NUMBER	MFR. PART NUMBER	(A) OUTSIDE BARREL DIAMETER	(B) HEAD DIAMETER	(C) INSIDE DIAMETER	(D) OVERALL LENGTH	RECOMMENDED BOARD THICKNESS	DRILL SIZE	INSTLG. TOOL NUMBER
EY-106-1	CE 22F	0.030	0.059	0.020	1/16	1/32	0.031 (#68)	CET-2F
EY-106-2	CE 23F	0.030	0.059	0.020	3/32	1/16	0.031 (#68)	CET-2F
EY-106-3*	CE 32F	0.047	0.075	0.035	5/64	1/32	0.052 (#55)	CET-3F
EY-106-4*	CE 33F	0.047	0.075	0.035	7/64	1/16	0.052 (#55)	CET-3F
EY-106-5*	CE 34F	0.047	0.075	0.035	5/32	3/32	0.052 (#55)	CET-3F
EY-106-6*	CE 35F	0.047	0.075	0.035	11/64	1/8	0.052 (#55)	CET-3F
EY-106-7	CE 42F	0.060	0.100	0.042	5/64	1/32	0.063 (#52)	CET-4F
EY-106-8*	CE 43F	0.060	0.100	0.042	7/64	1/16	0.063 (#52)	CET-4F
EY-106-9	CE 44F	0.060	0.100	0.042	9/64	3/32	0.063 (#52)	CET-4F
EY-106-10	CE 45F	0.060	0.100	0.042	11/64	1/8	0.063 (#52)	CET-4F
EY-106-11	CE 46F	0.060	0.100	0.042	13/64	5/32	0.063 (#52)	CET-4F
EY-106-12	CE 63F	0.090	0.150	0.067	1/8	1/16	0.096 (#41)	CET-6F
EY-106-13	CE 64F	0.090	0.150	0.067	5/32	3/32	0.096 (#41)	CET-6F
EY-106-14	CE 65F	0.090	0.150	0.067	3/16	1/8	0.096 (#41)	CET-6F
EY-106-15	CE 66F	0.090	0.150	0.067	7/32	5/32	0.096 (#41)	CET-6F

EY-106

REVISIONS					
SYM	DESCRIPTION	DATE	E.M.N. NO.	DRAFT	CHKD APPD

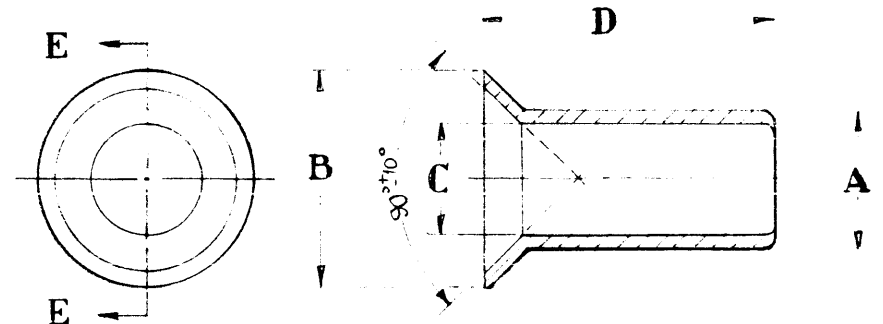

SECTION E - E

T M C PART NUMBER WILL BE IN THE FOLLOWING FORM:

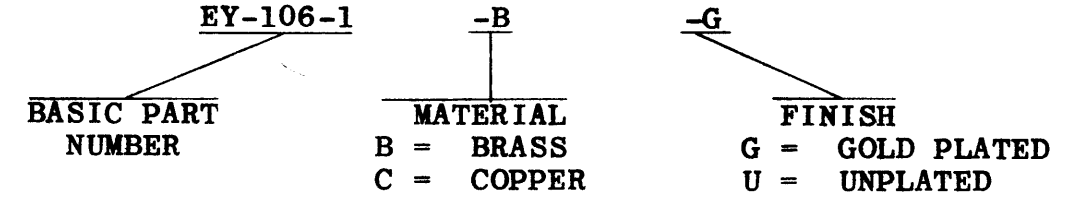

*MATERIAL ON ALL FUNELET'S IS GOLD PLATED BRASS.
 ASTERISKED ITEMS (*) ALSO SUPPLIED IN UNPLATED COPPER.

TOLERANCES:
 DECIMAL DIMENSIONS: +0.007 (EXCEPT BARREL O.D. WHICH IS +0.003).
 FRACTIONAL DIMENSIONS: +1/64.

REF: CIRCON COMPONENT CORP

Q'TY./UNIT	MODEL USED ON	ASS'Y. NO.
SCALE	CODE	

AFC-3 7-26-62

NOTES

THE CONTENTS OF THIS DRAWING ARE THE EXCLUSIVE PROPERTY OF THE TECHNICAL MATERIEL CORP. ITS UNAUTHORIZED USE OR REPRODUCTION IN WHOLE OR IN PART IS STRICTLY FORBIDDEN.

REQ'D.	ITEM	PART NUMBER	DESCRIPTION	SYMBOL
LIST OF MATERIAL				
MATERIAL		THE TECHNICAL MATERIEL CORP. MAMARONECK, NEW YORK		
FINISH		EYELET, FUNNEL FLANGE		
UNLESS OTHERWISE SPECIFIED DIMENSIONS ARE IN INCHES AND INCLUDE CHEMICALLY APPLIED OR PLATED FINISHES		DRAWN <i>D. J. Mann</i>	DATE 5/25/62	FINAL APPROVAL <i>BP</i>
		CHECKED <i>J. De</i>	DATE 5/31/62	
		ELECT. DES. <i>J. De</i>	DATE	EY-106
		MECH. DES.	DATE	SHEET
		DECIMALS .X ± .05 .XX ± .01 .XXX ± .005	TOLERANCES	FRACTIONS ± 1/64 ANGLES ± 0° 30'
				REV. LTR.