

EY 10006

ISSUE	ITEM	CHANGED FROM	DATE	CN. NO.	DRAFTS	CHECKER	ENG. APP.	REQ.	ITEM	PART NO.	DESCRIPTION	SYMBOL
φ		REL. TO PROD.	9/4/68		S.B.	<i>[Signature]</i>	<i>[Signature]</i>					

TMC PART #	MFGR. PART #	DIMENSIONS			D
		A	B	C	
EY10006-1	A 1280	.062	.115	.110	.008

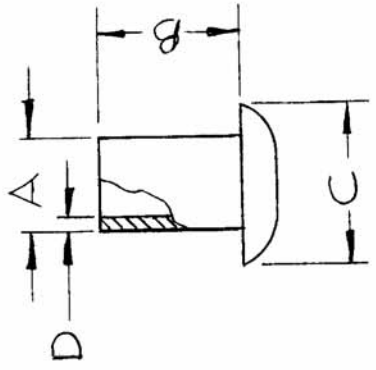

STANDARD DRAWING

MFGR. # S10045-67

MODEL		PROJECT NO.	ASSY. NO.	DATE
				9/4/68
USED ON				
MAXIMUM ALLOWABLE TOLERANCES HAVE BEEN DETERMINED AND DEVIATIONS WILL BE CAUSE FOR REJECTION. REMOVE ALL BURRS AND SHARP EDGES.		IF IT IS FOUND DESIRABLE TO CHANGE ANY TOLERANCE OR OTHER DETAIL SPECIFIED ON THIS DRAWING NOTIFY THE PURCHASER PROMPTLY.		
DEC. DIM. ± FRAC. DIM. ± ANGULAR DIM. ±		DIMENSIONS IN INCHES UNLESS OTHERWISE SPECIFIED DRILL, PUNCH, COMMERCIAL STOCK SIZES AND MANUFACTURERS TOLERANCES ARE NOT INCLUDED.		
TOLERANCES		STOCK SIZE BRASS		
MATERIAL BRASS		WEIGHT PER PC.		
TYPE & TEMPER		HEAT TREAT. SPEC.		
DRAWN <i>[Signature]</i> RPL		CHECKED RPL		
ELEC. DES. APP. MECH. DES. APP.		FINAL APPROVAL EY10006-φ		
TMC (Canada) LIMITED OTTAWA ONTARIO		EYELET, RIVET TYPE.		