

EY 10006

ISSUE	ITEM	CHANGED FROM	DATE	CN. NO.	DRAFTS	CHECKER	ENG. APP.	REQ.	ITEM	PART NO.	DESCRIPTION	SYMBOL
φ		REL. TO PROD.	9/4/68		S.B.	<i>[Signature]</i>	<i>[Signature]</i>					

TMC PART #	MFGR. PART #	DIMENSIONS			D
		A	B	C	
EY10006-1	A 1280	.062	.115	.110	.008

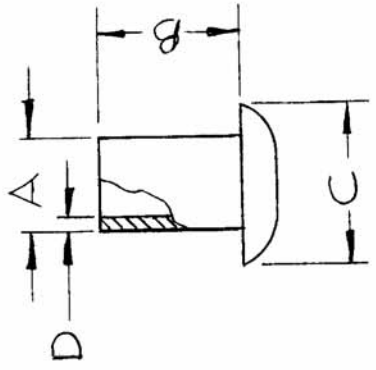

STANDARD DRAWING

MFGR. # S10045-67

MODEL		PROJECT NO.	ASSY. NO.	DATE	USED ON	
				9/4/68		
<p>MAXIMUM ALLOWABLE TOLERANCES HAVE BEEN DETERMINED AND DEVIATIONS WILL BE CAUSE FOR REJECTION. REMOVE ALL BURRS AND SHARP EDGES</p>			<p>IF IT IS FOUND DESIRABLE TO CHANGE ANY TOLERANCE OR OTHER DETAIL SPECIFIED ON THIS DRAWING NOTIFY THE PURCHASER PROMPTLY.</p>			
<p>TOLERANCES</p> <p>DEC. DIM. ±</p> <p>FRAC. DIM. ±</p> <p>ANGULAR DIM. ±</p>			<p>SCALE</p> <p>DIMENSIONS IN INCHES UNLESS OTHERWISE SPECIFIED</p> <p>DRILL, PUNCH, COMMERCIAL STOCK SIZES AND MANUFACTURERS TOLERANCES ARE NOT INCLUDED.</p>			
STOCK SIZE		MATERIAL		WEIGHT PER PC.		
BRASS		BRASS				
TYPE & TEMPER		HEAT TREAT. SPEC.		FINISH & SPEC. NO.		
DRAWN		CHECKED		FINAL APPROVAL		
<i>[Signature]</i>		RPL		<i>[Signature]</i>		
ELEC. DES. APP.		MECH. DES. APP.				
TMC (Canada) LIMITED OTTAWA ONTARIO			EYELET, RIVET TYPE.			
			EY10006-φ			