

REVISIONS							
E.M.N. NO.	DRAFT	CHKD	ZONE	LTR	DESCRIPTION	DATE	APPROVED
	PH			X1		12-14-77	
	PH			X2	REV SPECIFICATIONS	1-4-78	
	G.D.C.			X3	REVISED & UPDATED	3-16-78	
	G.D.C.	W.B.		Ø	ORIGINAL RELEASE FOR PRODUCTION	6-5-78	*

EQ297  
3 KHz LOWER  
SIDE BAND FILTER

TERMINAL  
(4 REQ'D)

STUD & TAP 4-40THD

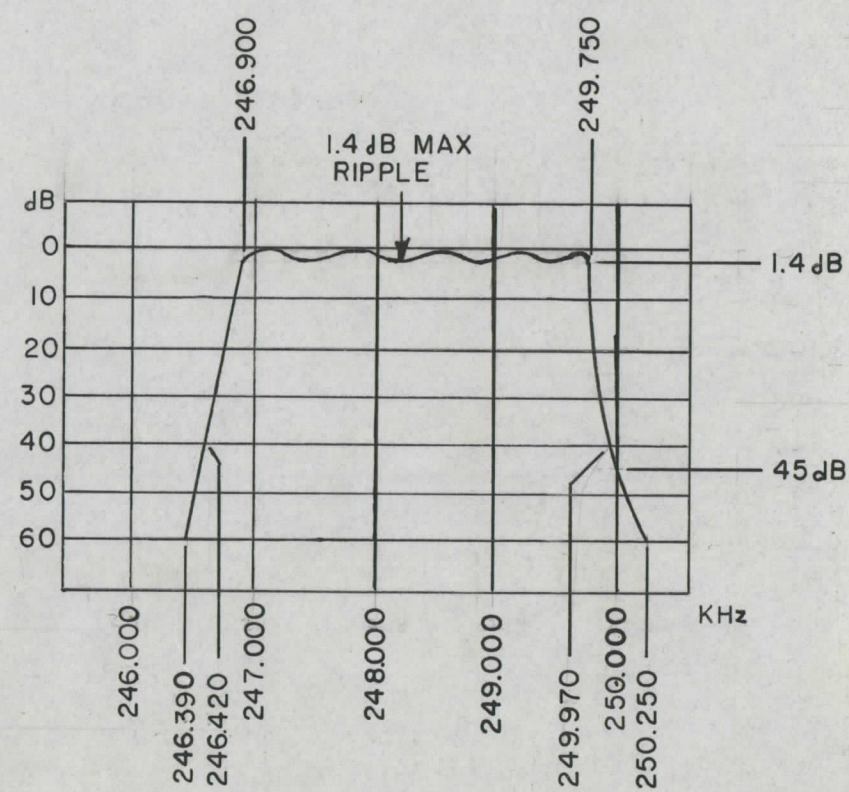

SPECIFICATIONS

ELECTRICAL

TYPE: LOWER SIDEBAND  
 CARRIER FREQUENCY: 250 KHz  
 CARRIER SUPPRESSION: -45 dB OR GREATER  
 -1.4 dB POINTS: 249.750 KHz MIN. , 246.900 KHz MAX.  
 UNWANTED SIDEBAND ATTENUATION: GREATER THAN -60 dB  
 INCLUDING ALL RETURN LOSSES AND SPURIOUS.  
 MAXIMUM PASSBAND RIPPLE: 1.4 dB  
 INSERTION LOSS: 10 dB MAX.  
 INPUT AND OUTPUT IMPEDANCE: 1.0K UNBALANCED  
 TEMPERATURE RANGE: 0° C TO +70° C  
 ENVELOPE DELAY DIST. LESS THAN:  
 8 ms WITHIN 300 Hz AND 3020 Hz ( ABSOLUTE DELAY )  
 1000 µs WITHIN 400 Hz AND 3000 Hz  
 500 µs WITHIN 600 Hz AND 2900 Hz  
 150 µs WITHIN ANY 100 Hz STEP FROM 480 Hz TO 3050 Hz  
 1000 µs WITHIN 300 Hz AND 400 Hz  
 200 µs WITHIN 3050 Hz AND 3150 Hz

MECHANICAL

CASE: STEEL, HERMETICALLY SEALED  
 FINISH: BRUSHED NICKEL OR POWDER BLASTED BRIGHT NICKEL  
 MOUNTING: 4-40X .280 STUDS ( 4 REQ. )  
 TERMINAL: .040 DIA PIN TYPE. BRASS, SILVER PLATED, BEAD INS.

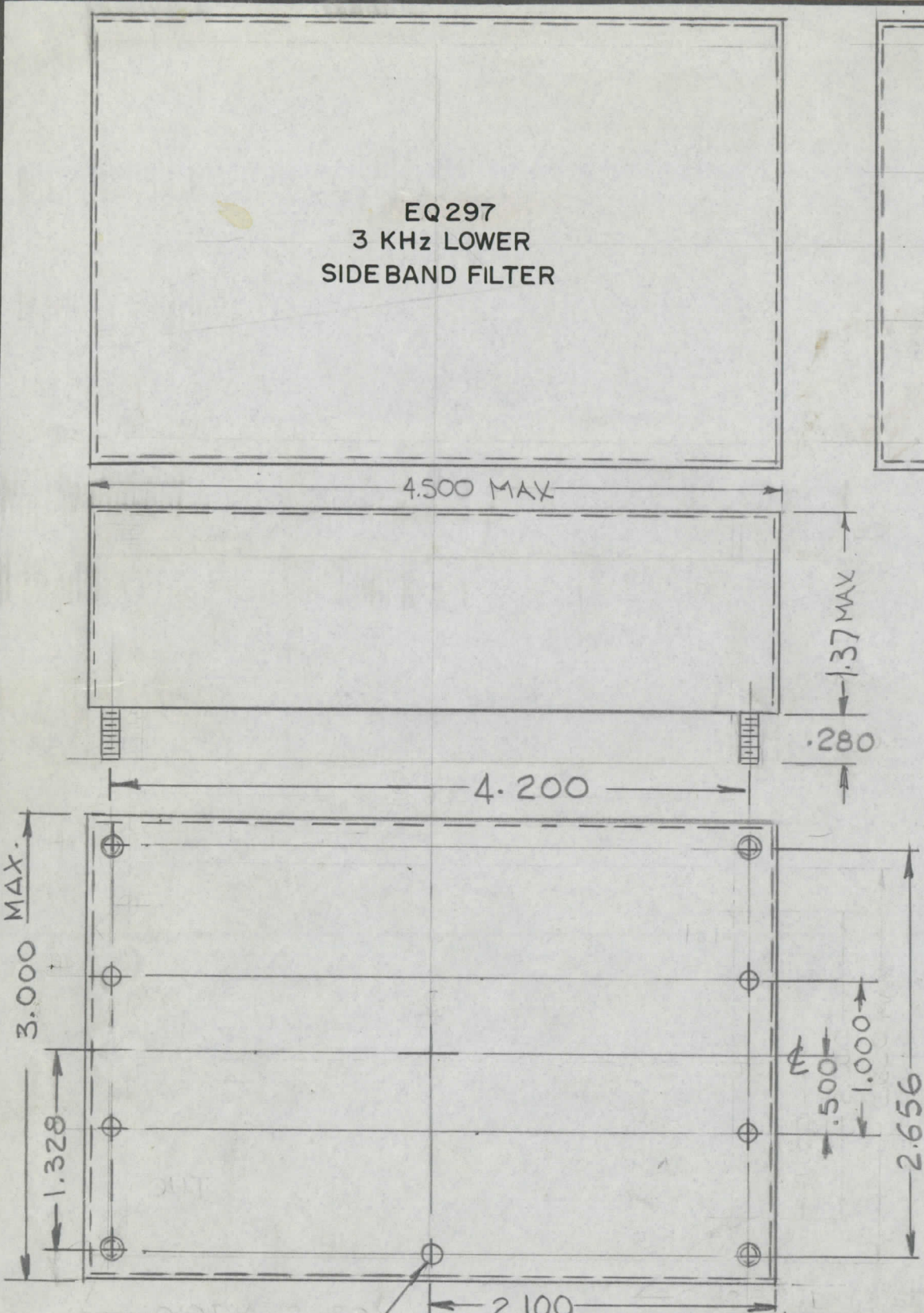

REQ'D	ITEM	PART NUMBER	DESCRIPTION	SYM.
LIST OF MATERIAL				

QTY / UNIT	MODEL USED ON	ASS'Y NO.
1	MMX	
APPLICATION		
5401-527	CODE	

UNLESS OTHERWISE SPECIFIED  
 DIMENSIONS ARE IN INCHES  
 AND INCLUDE CHEMICALLY APPLIED  
 OR PLATED FINISHES

DECIMALS .X ± .05  
 .XX ± .01  
 .XXX ± .005

FRACTIONS 1/64  
 TOLS. ANGLES  
 0° .30'

MATERIAL

FINISH

FINAL APPROVAL	DATE
M.E.H.	6/2/78
ELECT. DES.	DATE
CHECKED	DATE
DRAWN	DATE
PH	11-10-77

THE TECHNICAL MATERIEL CORP. MAMARONECK, NEW YORK			
LOWER SIDEBAND FILTER BANDPASS 3KHz (EQUALIZED)			
SIZE	CODE IDENT. NO.	DWG NO.	ISSUE
B	82679	EQ297	Ø
SCALE FULL		SHEET OF	

NOTICE TO PERSONS RECEIVING THIS DRAWING  
 THE TECHNICAL MATERIEL CORPORATION claims proprietary right in the material disclosed hereon. This drawing is issued in confidence for engineering information only and may not be reproduced or used to manufacture anything shown hereon without permission from THE TECHNICAL MATERIEL CORPORATION to the user. This drawing is loaned for mutual assistance and is subject to recall at any time.