

IF IT IS FOUND DESIRABLE TO CHANGE ANY TOLERANCE OR OTHER DETAIL SPECIFIED ON THIS DRAWING NOTIFY THE PURCHASER PROMPTLY.

DIMENSIONS IN INCHES UNLESS OTHERWISE SPECIFIED

MAXIMUM ALLOWABLE TOLERANCES HAVE BEEN DETERMINED AND DEVIATIONS WILL BE CAUSE FOR REJECTION. REMOVE ALL BURRS AND SHARP EDGES.

ISSUE	ITEM	CHANGED FROM	DATE	CN. NO.	DRAFTS	CHECKER	ENG. APP.
Ø		PROD RELEASE	22 AUG 70		<i>[Signature]</i>		<i>NA</i>

REQ	ITEM	PART NO.	DESCRIPTION	SYMBOL
-----	------	----------	-------------	--------

CL10043-2
- RCA

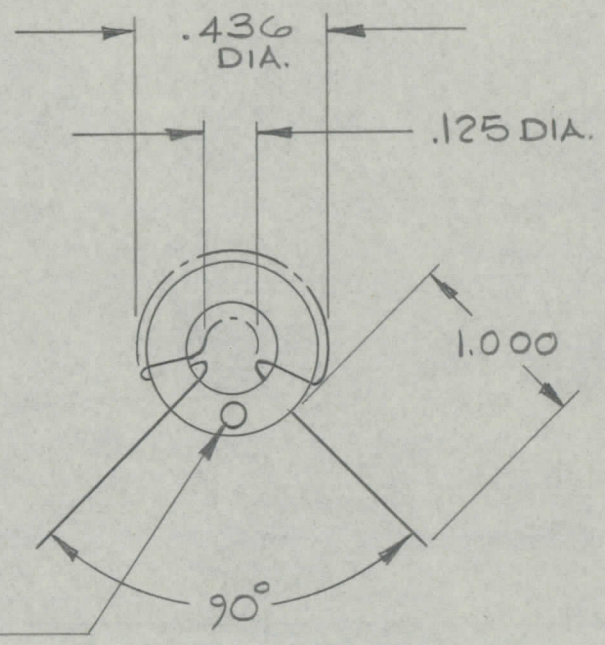

INDUCTANCE 0.306 μ H \pm 1%
TYP SELF CAP 0.5 pF

IDENTIFICATION DOT
COLOUR RED

STOCK SIZE		TMC (Canada) LIMITED OTTAWA ONTARIO		
MATERIAL				
WEIGHT PER PC.				
TYPE & TEMPER		<i>SIMPSON</i>	<i>NA</i>	<i>[Signature]</i>
HEAT TREAT. SPEC.		DRAWN	ELEC. DES. APP.	MECH. DES. APP.
FINISH & SPEC. NO.		CHECKED	FINAL APPROVAL	
		CL10043-2-RCA Ø		

TOLERANCES UNLESS OTHERWISE SPECIFIED	SCALE: 2:1
ALL OTHERS	DRILL, PUNCH, COMMERCIAL STOCK SIZES AND MANUFACTURERS TOLERANCES ARE NOT INCLUDED.
DEC. DIM. \pm .015 FRAC. DIM. \pm 1/64 ANGULAR DIM. \pm 5°	.X = .05 .XX = .01 .XXX = .005

AMC 8	074/70		22 AUG 70
MODEL	PROJECT NO.	ASS Y. NO.	DATE
USED ON			