

REVISIONS							
E.M.N.O.	DRAFT	CHKD	ZONE	LTR	DESCRIPTION	DATE	APPROVED
	D.V.			Ø	ORIGINAL RELEASE FOR PRODUCTION	11/2/73	
21136	CL			A	R205 WAS 5Ω	4/11/74	
21192	GDL	CL		B	ADD R209, CR203. REVD STAND BY SW, VALUE OF R204 WAS 20Ω	1-3-74	
21025	GDL	CL		C	ON TB201 CONNECTION TO TERMINAL 6 REMOVED - NOTE FOR 12VDC & 24VDC ADDED	3-24-75	
21248	GDL	CL		D	ADDED C206 & R210-R213	5-20-75	
21491	GDL			E	T201 MODIFIED - R203 WAS 2W	9-1-76	
21533	GDL			F	R214, C207 & C208 ADD.	4-11-77	FB

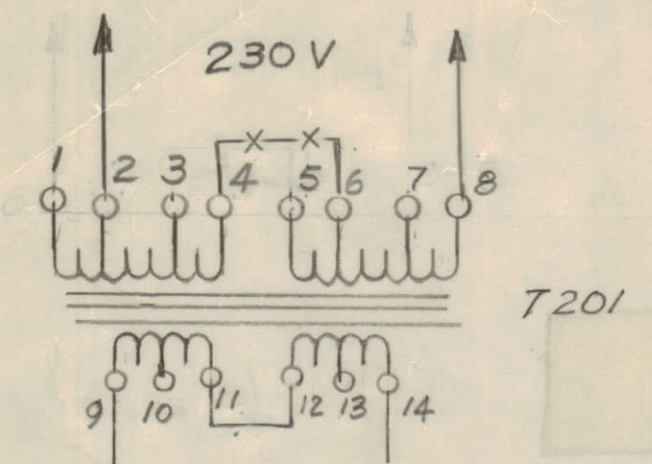

FOR 230V OPERATION REMOVE JUMPER FROM PIN 2 & 6 - PIN 4 & 8 AND ADD JUMPER TO PIN 4 & 6

HOOK UP FOR BATT OPER

REMOVE JUMPERS ON LUGS 4 & 5, AND SWITCH FRONT PANEL INPUTS FROM LUGS 2 & 3 TO 4 & 5. ADD WIRE ACROSS R205 AS SHOWN IN SCHEMATIC FOR +12VDC OPERATION. JUMPER ACROSS R205 IS REMOVED FOR +24VDC OPERATION.

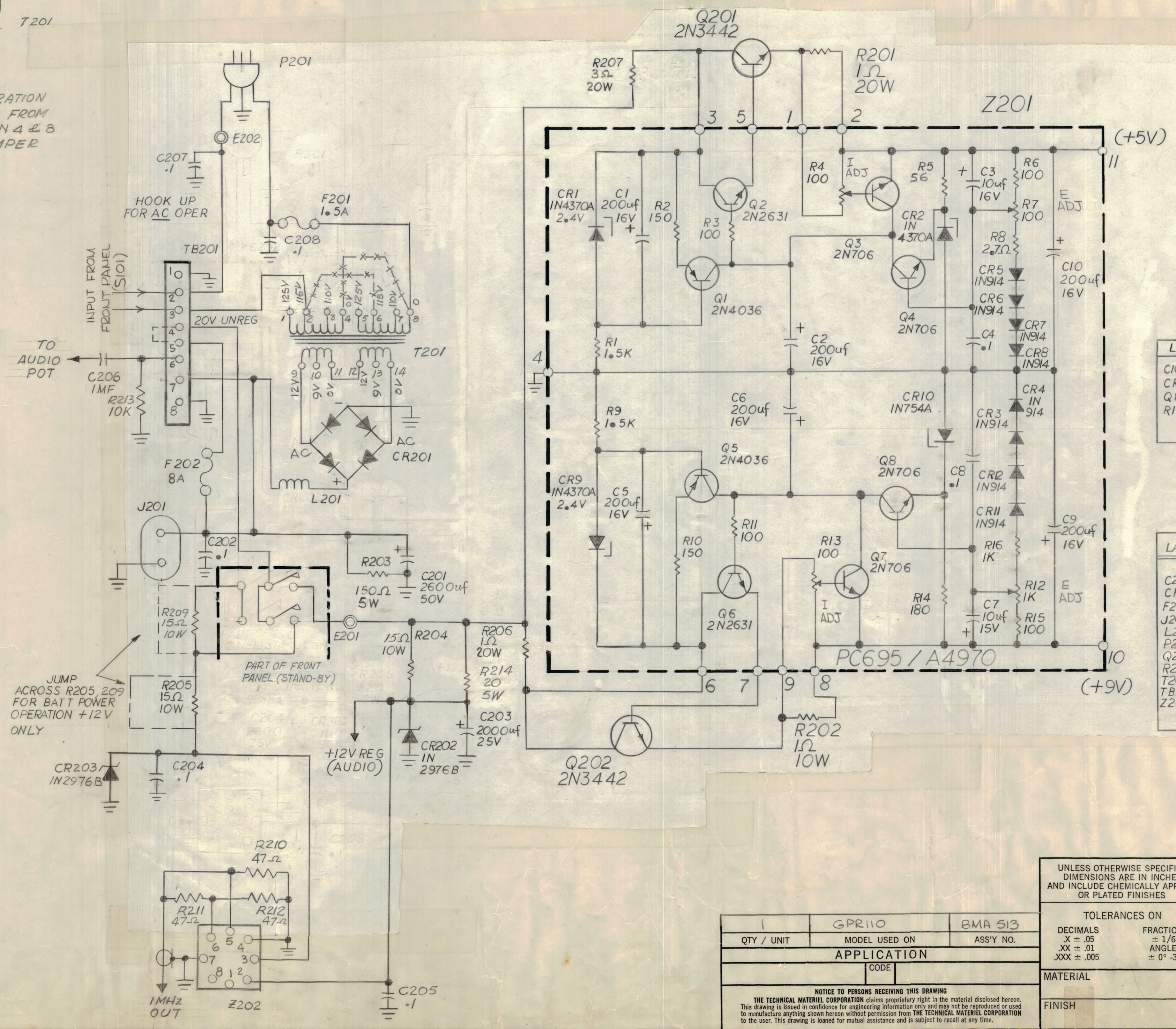

A201

LAST	MISSING
C10	
CR12	
Q8	
R16	

LAST	MISSING
C208	
CR203	
F202	
J201	
L201	
P201	
Q202	
R214	
T201	
TB201	
Z202	

UNLESS OTHERWISE SPECIFIED  
 1. ALL RESISTANCE VALUES ARE IN OHMS, 1/4W.  
 2. ALL DECIMAL CAPACITANCE VALUES ARE IN MICROFARADS.

QTY / UNIT	GPR110	BMA 513
MODEL USED ON		
APPLICATION		
CODE		
NOTICE TO PERSONS RECEIVING THIS DRAWING THE TECHNICAL MATERIEL CORPORATION claims proprietary right in the material disclosed hereon. This drawing is issued in confidence for engineering information only and may not be reproduced or used to manufacture anything shown hereon without permission from THE TECHNICAL MATERIEL CORPORATION to the user. This drawing is loaned for mutual assistance and is subject to recall at any time.		

QTY. REQ.	ITEM	PART NO.	DESCRIPTION	SYMBOL
LIST OF MATERIAL				
FINAL APPROVAL		DATE		THE TECHNICAL MATERIEL CORP. MAMARONECK, NEW YORK
MECH. DES.		DATE		
ELECT. DES.		DATE		
TOLERANCES ON		DATE		SCHEMATIC DIAGRAM, POWER SUPPLY GPR110
DECIMALS		DATE		
FRACTIONS		DATE		
MATERIAL		DATE		SIZE CODE IDENT NO. DWG NO.
FINISH		DATE		
		D 82679		CK2059
		SCALE		SHEET OF