

REQ. PER. UNIT	MODEL	USED ON
		ASSY. NO.
		DATE
		10-24-60
CF-131		

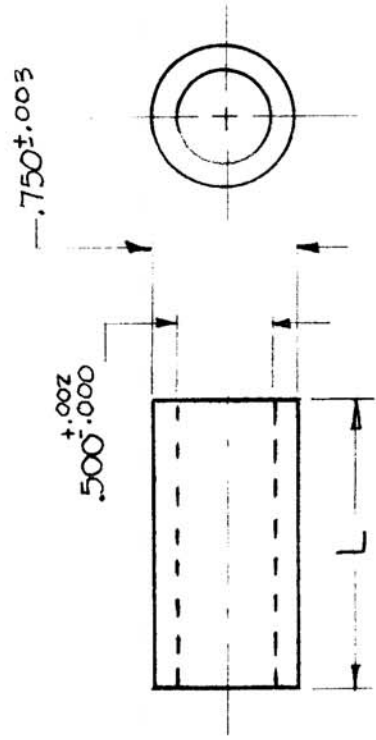

CF-131 - 1.375
 TMC PARTS, LENGTH IN INCHES
 Example = $1.375 = 1 \frac{3}{8}$

REG. ITEM	PART NO.	DESCRIPTION	SYMBOL
		THE TECHNICAL MATERIEL CORP.	
		MAMARONECK, NEW YORK	
		COIL FORM	
		(3/4 O.D. x 1/2 I.D.)	
		DRAWN <i>DG</i>	FINAL APPROVAL <i>CP</i>
		CHECKED <i>AM</i>	CF-131
		ELEC. DES. APP. MECH. DES. APP.	
ISSUE ITEM	CHANGED FROM	TOLERANCES	
DATE	CH. NO.	MAXIMUM ALLOWABLE TOLERANCES HAVE BEEN DETERMINED AND ANY DEVIATIONS WILL BE CAUSE FOR REJECTION. REMOVE ALL BURRS AND SHARP EDGES	
	DRAFTS	SCALE:	
	CHECKER	ENG. APP.	
		FINISH & SPEC. NO.	
		STOCK SIZE	
		PHENOLIC	
		MATERIAL	
		XXXP LAMINATE	
		TYPE & TEMPER HEAT TREAT. SPEC.	