

IF IT IS FOUND DESIRABLE TO CHANGE ANY TOLERANCE OR OTHER DETAIL SPECIFIED ON THIS DRAWING NOTIFY THE PURCHASER PROMPTLY.
 MAXIMUM ALLOWABLE TOLERANCES HAVE BEEN DETERMINED AND DEVIATIONS WILL BE CAUSE FOR REJECTION. REMOVE ALL BURRS AND SHARP EDGES

NOTICE TO PERSONS RECEIVING THIS DRAWING

THE TECHNICAL MATERIEL CORPORATION claims proprietary right in the material disclosed hereon. This drawing is issued in confidence for engineering information only and may not be re-used or used to manufacture anything shown hereon without permission from THE TECHNICAL MATERIEL CORPORATION to the user. This drawing is loaned for mutual assistance and is subject to recall at any time.

Property of:
 THE TECHNICAL MATERIEL CORPORATION
 MAMARONECK, NEW YORK

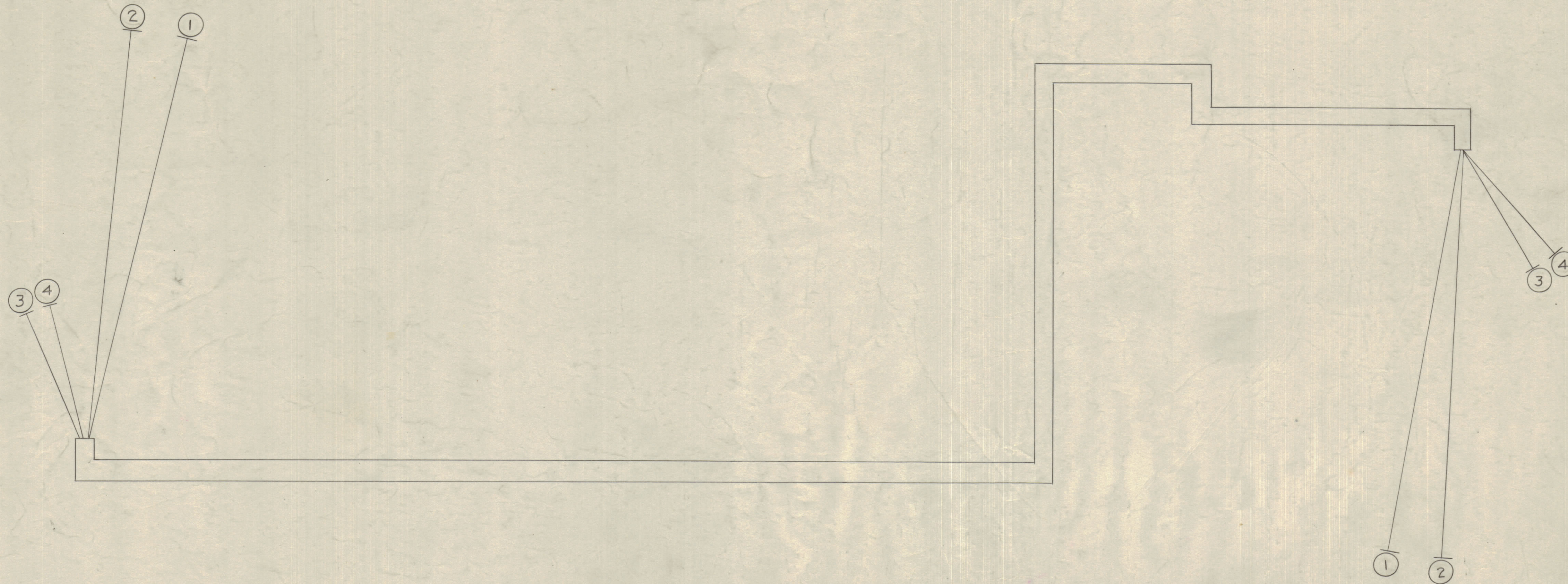

NOTE
 ALLOW 1/2" EACH END FOR TINNING & STRIPPING

RUNNING LIST

ITEM NO.	COLOR	FROM ---	TO ---
1	RED	10, S12	R 93
2	WH/RED	9 & 11, S12	R 87
3	BRN.	4, V17	C 107
4	WH/BRN	3, V17	C 119

CA-353 A

X 5	CD-101-1 MW	CORD LACING, NYLON	
X 4	MWC 22(7)U91	CABLE, INSULATED	WH, BRN.
X 3	MWC 22(7)U1		BRN.
X 2	MWC 22(7)U92		WH, RED
X 1	MWC 22(7)U2		RED
REQ. ITEM	PART NO.	DESCRIPTION	SYMBOL
—	—	THE TECHNICAL MATERIEL CORP.	
		MAMARONECK, NEW YORK	
—	—	CABLE, AMP XTAL OSC.	
MATERIAL	WEIGHT PER FC.	GPR-90-RX	
—	—	9.4.57	
TYPE & TEMPER	DRAWN	ELEC. DES. APP.	MECH. DES. APP.
—	—		
HEAT TREAT. SPEC.	CHECKED	FINAL APPROVAL	
—	—		
FINISH & SPEC. NO.	CA-353 A		

A	IT.5 WAS CD-101-5-MW	17092	RME	
ISSUE	ITEM	CHANGED FROM	DATE	CN. NO. DRAFTS CHECKER ENG. APP.
TOLERANCES		SCALE: Full		
ALL OTHERS	DEC. DIM. ± FRAC. DIM. ± ANGULAR DIM. ±	DRILL, PUNCH, COMMERCIAL STOCK SIZES AND MANUFACTURERS TOLERANCES ARE NOT INCLUDED.		

1	GPR 90 RX	PROJECT NO.	ASSY. NO.	9.4.57	DATE
REQ. PER UNIT	MODEL	USED ON			