

TMC PART NUMBER	ITEM PART NUMBERS							CABLE REMARKS
	ITEM 7	ITEM 8	ITEM 9	ITEM 11	ITEM 12	ITEM 13		
AX-421-1	JJ-288	NONE	NONE	NONE	NONE	A-876	RG-211A/U	
AX-421-2	JJ-288	NONE	PL-236	NONE	NONE	A-876	RG-211A/U	
AX-421-3	JJ-288	NONE	PL-235	NONE	NONE	A-876	RG-211A/U	

A
AX-421

REVISIONS						
SYM	DESCRIPTION	DATE	E.M.N. NO.	DRAFT	CHKD	APPD
A	ON TMC P/N CHART (-1) IT.9 WAS PL-236, (-2) IT.9 WAS PL-235 ON (-3) IT.9 PL-235 ADD. ON MAT'L & FINISH CHART IT.13 FINISH WAS CADMIUM PLATE	8.17.64	12154	hbs	@	jc

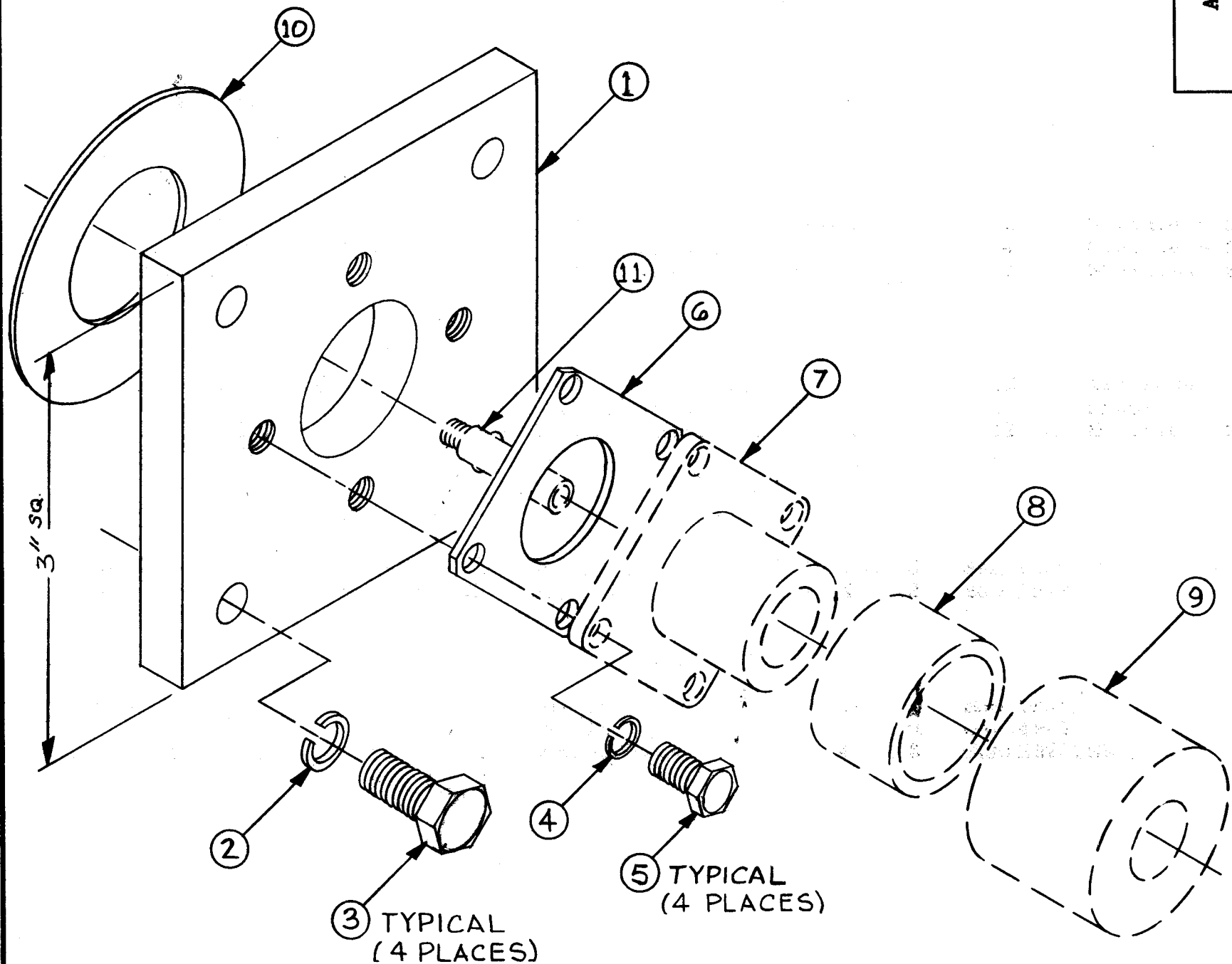

MATERIALS AND FINISHES		
ITEM NO.	MATERIAL	FINISH
1	Aluminum	Iridite
2	Stainless Steel	Passivate
3	Stainless Steel	Passivate
4	Stainless Steel	Passivate
5	Stainless Steel	Passivate
6	Neoprene	Natural
7	See Connector Drawing	
8	See Adapter Drawing	
9	See Connector Drawing	
10	Neoprene	Natural
11	Brass	Silver Plate
12	Stainless Steel	Passivate
13	Copper	Silver Plate

Note: Item 13 supplied as loose item with "RAC" series only.

REQ'D.	ITEM	PART NUMBER	DESCRIPTION	SYMBOL
1	13	See Chart	Connector Assembly, Coax.	
X	12	See Chart	Lockwasher, Split	
1	11	See Chart	Center Conductor	
1	10	GA-102	Gasket, Neoprene	
1	9	See Chart	Connector, Plug	
1	8	See Chart	Adapter, Connector	
1	7	See Chart	Connector, Receptacle	
1	6	GA-149-7	Gasket, Square and Rectangular	
4	5	SCH2520SS8	Screw, Machine, Hex Head	
4	4	LWS25MS5	Lockwasher, Spring Type	
4	3	SCH2520SS12	Screw, Machine, Hex Head	
4	2	LWS25MS5	Lockwasher, Spring Type	
1	1	PM-403	Plate, Mounting	

LIST OF MATERIAL				
MATERIAL	THE TECHNICAL MATERIEL CORP. MAMARONECK, NEW YORK			
FINISH	TITLE MOUNTING PLATE CONNECTOR ASSEMBLY SERIES LC(10)			
UNLESS OTHERWISE SPECIFIED DIMENSIONS ARE IN INCHES AND INCLUDE CHEMICALLY APPLIED OR PLATED FINISHES	DRAWN M.J. TANTILLO	DATE 6-18-63	FINAL APPROVAL JFH	DATE 6-18-63
DECIMALS .X ± .05 .XX ± .01 .XXX ± .005	CHECKED hbs	DATE 6-18-63	ELECT. DES. hbs	DATE 6/18/63
FRACTIONS ± 1/64 ANGLES ± 0° 30'	TOLERANCES	MECH. DES.	DATE	
NOTES			AX-421	A
THE CONTENTS OF THIS DRAWING ARE THE EXCLUSIVE PROPERTY OF THE TECHNICAL MATERIEL CORP. ITS UNAUTHORIZED USE OR REPRODUCTION IN WHOLE OR IN PART IS STRICTLY FORBIDDEN.			SHEET	REV. LTR.