

AR-129

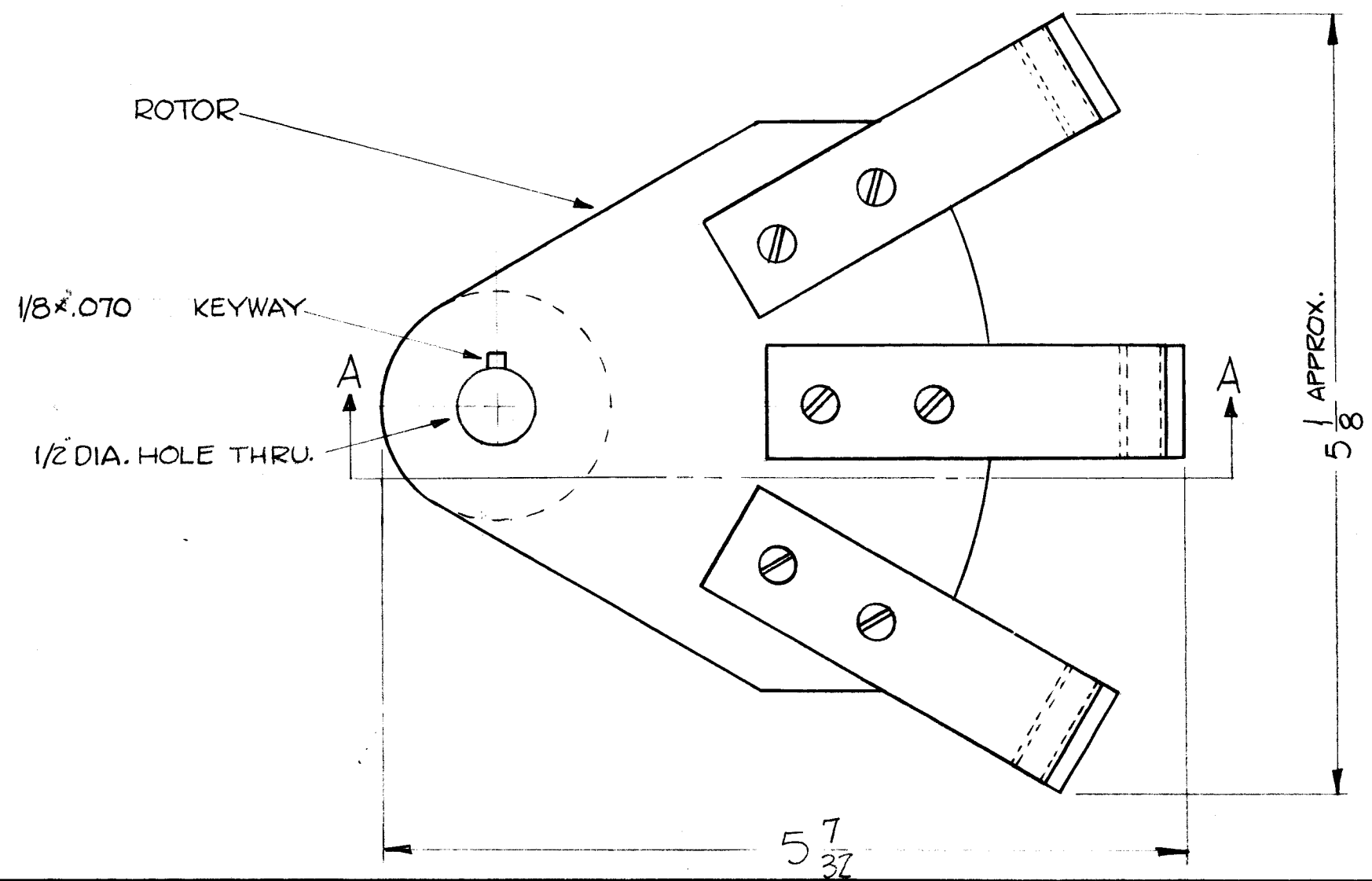

ASSY CONSISTS OF (3) SHOE CONTACT ASSYS
 (1) ROTOR, (6) NO. 8 LOCKWASHERS, (6) 8-32 BINDER HEAD SCREWS.

MATERIALS
 ROTOR - BRASS, SILVER PLATED .0003
 CONTACT LEAFS - BERYLLIUM COPPER, RHODIUM PLATE .000025

SHOE - BRASS - RHODIUM PLATE .000025
 HARDWARE - BRASS, NICKEL PLATE

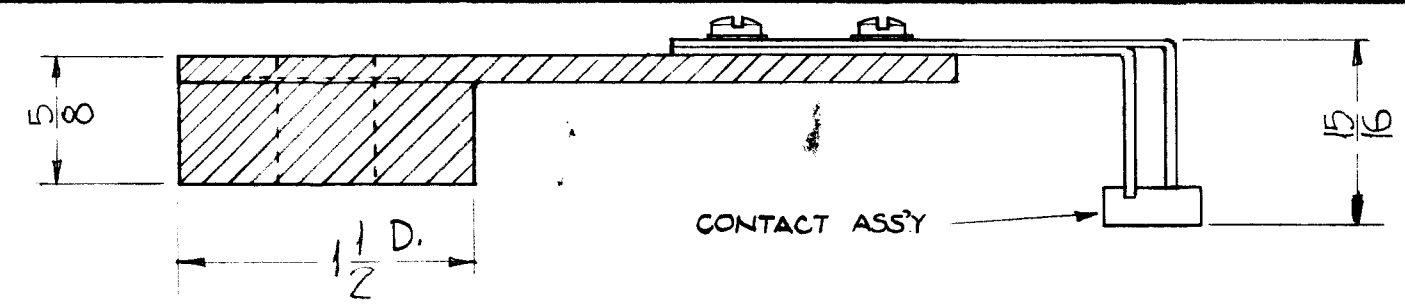

SECTION A-A

SYM	DESCRIPTION	DATE	CH. NO.	DRAFTS	CHECKER	ENG. APP.
	UNLESS OTHERWISE SPECIFIED: DIMENSIONS ARE IN INCHES TOLERANCES ON FRACTIONS ± 1/64 DECIMALS ± .005 ANGLES ± 1/2°					
	SCALE: A-1976 MAXIMUM ALLOWABLE TOLERANCES HAVE BEEN DETERMINED AND ANY DEVIATIONS WILL BE CAUSE FOR REJECTION. REMOVE ALL BURRS AND SHARP EDGES					

REQ. PER UNIT	MODEL	SECTION	ASSY. NO.	DATE
1	ACU			10-19-60
USED ON				

REQ. ITEM	PART NO.	DESCRIPTION	SYMBOL
		THE TECHNICAL MATERIEL CORP. MAMARONECK, NEW YORK	
STOCK SIZE		ROTOR ASSY., UNBAL BAND	
MATERIAL			
TYPE & TEMPER	HEAT TREAT. SPEC.	DRAWN	CHECKER
		aa	803
FINISH & SPEC. NO.		ELEC. DES. APP.	MECH. DES. APP.
			AR-129