

IF IT IS FOUND DESIRABLE TO CHANGE ANY TOLERANCE OR OTHER DETAIL SPECIFIED ON THIS DRAWING NOTIFY THE PURCHASER PROMPTLY.
 MAXIMUM ALLOWABLE TOLERANCES HAVE BEEN DETERMINED AND DEVIATIONS WILL BE CAUSE FOR REJECTION. REMOVE ALL BURNS AND SHARP EDGES

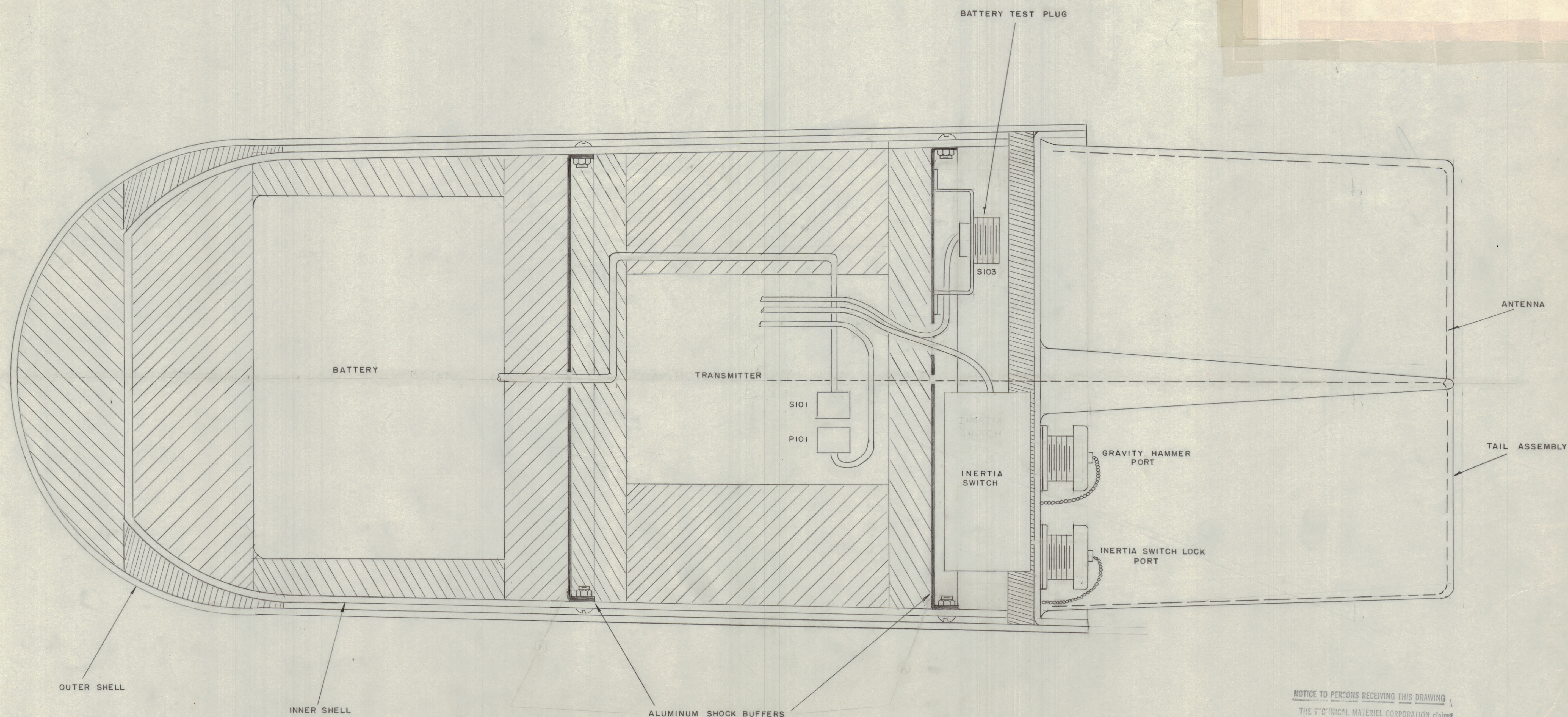

BOTH SHELLS ARE COMPOSED OF POLYESTER FIBERGLAS LAMINATE

NOTICE TO PERSONS RECEIVING THIS DRAWING
 THE TECHNICAL MATERIEL CORPORATION claims proprietary right in the material disclosed hereon. This drawing is issued in confidence for engineering information only and may not be reproduced or used to manufacture anything shown hereon without permission in writing from THE TECHNICAL MATERIEL CORPORATION. This drawing is loaned for mutual assistance and is subject to recall at any time.
 Property of:
 THE TECHNICAL MATERIEL CORPORATION
 MAMARONECK, NEW YORK

SYMBOL LEGEND

- SHOCK ABSORBING MATERIAL
- ANTENNA

Handwritten notes:
 DIMENSIONS
 OUTER CASE 2 1/2" DIA. x 1 1/2" THICK
 95% OF DIA. 90% DIA.
 INNER CASE 1 7/8" DIA. x 3/4" THICK
 95% OF DIA. 90% DIA.
 FINISH 75% DIA.
 95% DIA.

ISSUE	ITEM	CHANGED FROM	DATE	CN. NO.	DRAFTS	CHECKER	ENG. APP.
TOLERANCES							
ALL DEC. DIM. ±			DRILL, PUNCH, COMMERCIAL STOCK			SIZES AND MANUFACTURERS	
OTHERS FRAC. DIM. ±			TOLERANCES ARE NOT INCLUDED.				
ANGULAR DIM. ±							

CPI-3	320		12-8-54
MODEL	PROJECT NO.	ASSY. NO.	DATE
USED ON			

REQ. ITEM	PART NO.	DESCRIPTION	SYMBOL
THE TECHNICAL MATERIEL CORP., MAMARONECK, NEW YORK			
CROSS SECTION DETAIL ASSEMBLY			
MODEL CPI-3			
STOCK SIZE			
MATERIAL		WEIGHT PER PC.	
TYPE & TEMPER		DRAWN	
HEAT TREAT. SPEC.		ELEC. DES. APP. MECH. DES. APP.	
FINISH & SPEC. NO.		CHECKED	
		FINAL APPROVAL	
		A-893	

A-893