

REQ. PER UNIT: 1
 MODEL: GPT-200K
 USED ON: AX-396
 ASSY. NO.: 1-18-64
 DATE: 1-18-64
 A-3468 A

* WHEN MTG. ITEM NO. 10, BEND AROUND TERMINAL OF ITEM NO. 5 AS SHOWN AND CUT EXCESS IF NECESSARY.
 + SOLDER AT JUNCTION OF ITEMS 2, 3, 4 AND ALSO OTHER END OF ITEM NO. 4 MOUNTING TO TERMINAL OF ITEM NO. 5, ONLY.

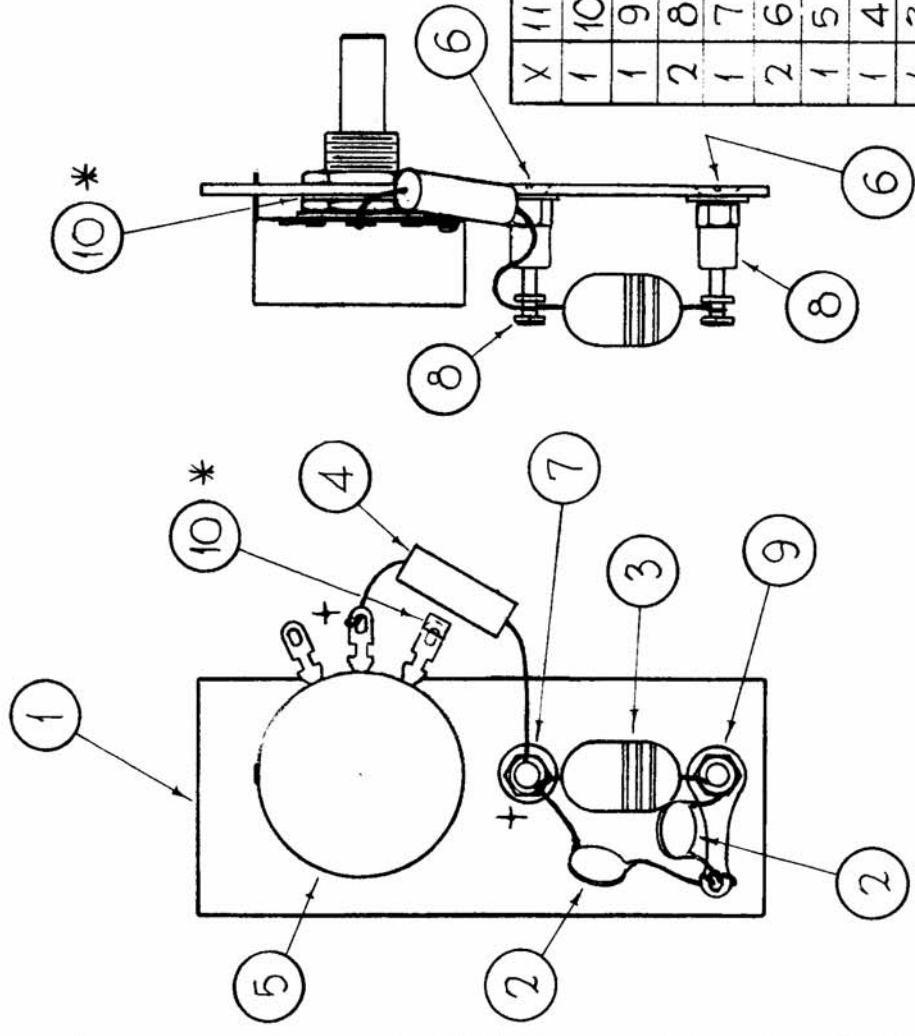

REQ. ITEM	PART NO.	DESCRIPTION	SYMBOL
X 11	BS-100	SOLDER, SOFT	
1	TE-111-2	TERMINAL, LUG	
1	TE-104-1	TERMINAL, LUG	
2	TE-102-2	TERMINAL, STUD, INSUL	
1	LWI04MRN	LOCKWASHER, INTERNAL TOOTH	
2	SCFP0440BNA	SCREW, MACHINE	
1	RV4NAYS253A	RESISTOR, VARIABLE, COMP.	R5402
1	RC42GF182K	RESISTOR, FIXED, COMPOSITION	R5403
1	CL-140-1	COIL, R.F. FIXED	L5401
2	CC-100-29	CAPACITOR, FIXED, CERAMIC DISC	C5401 C5402
1	LD-1263/MS 3493	PLATE, COMPONENT MTG.	
		F. BUDETTI	

THE TECHNICAL MATERIEL CORP. MAMARONECK, NEW YORK	
OUTPUT CONTROL RESISTOR ASSEMBLY	
John C. Biele	John C. Biele
9/8	9/8
CHECKED	FINAL APPROVAL
8.8	8.8
8.8	8.8
ELEC. DES. APP.	MECH. DES. APP.
FINISH & SPEC. NO. A-3468 A	

IT. (S) WAS RV44TRD253A	DATE: 7-26-64	CH. NO.: 11954	SCALE:
IT. (4) WAS RC32GF182K	DATE: 3-26-64	CH. NO.:	SCALE:
ORIGINAL RELEASE FOR PRODUCTION			
SYM	DESCRIPTION	DRAFTS	CHECKER
A	UNLESS OTHERWISE SPECIFIED DIMENSIONS ARE IN INCHES AND INCLUDE CHEMICALLY APPLIED OR PLATED FINISHES		
O	TOLERANCES		
	DECIMALS		
	FRACTIONS		
	± .05		
	± .01		
	± .005		
	± 1/64 ANGLES		
	± 0° 30'		