

REVISIONS							
ZONE	SYM	DESCRIPTION	DATE	E.M.N. NO.	DRAFT	CHKD	APPD
	A	ITEM(1) WAS PX-660 (LD-1091) ASSY NO. CHART ADDED	4-1-62	11172		<i>John @</i>	<i>Janger</i>

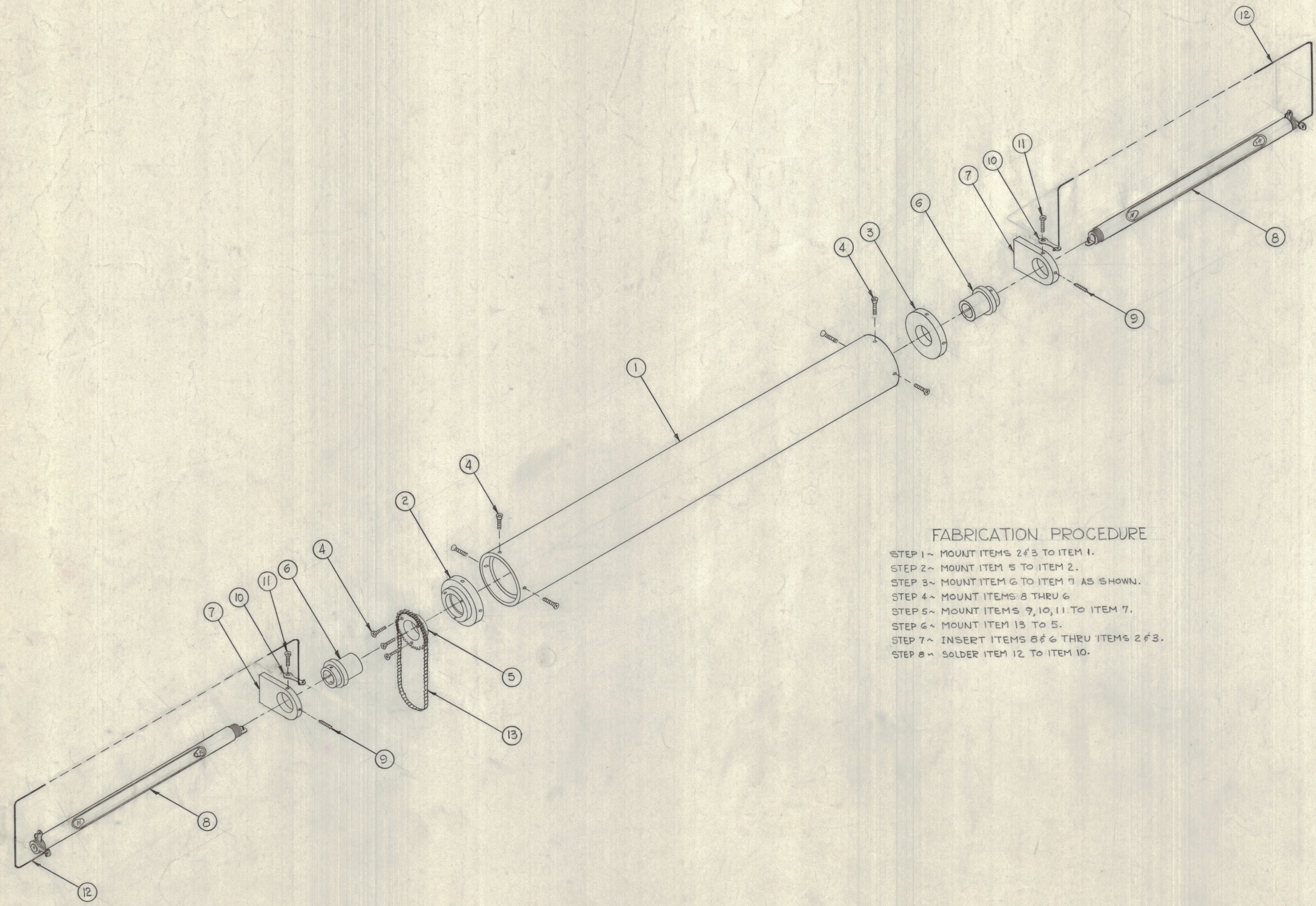

**FABRICATION PROCEDURE**

STEP 1 ~ MOUNT ITEMS 2 & 3 TO ITEM 1.  
 STEP 2 ~ MOUNT ITEM 5 TO ITEM 2.  
 STEP 3 ~ MOUNT ITEM 6 TO ITEM 7 AS SHOWN.  
 STEP 4 ~ MOUNT ITEMS 8 THRU 6  
 STEP 5 ~ MOUNT ITEMS 9, 10, 11 TO ITEM 7.  
 STEP 6 ~ MOUNT ITEM 13 TO 5.  
 STEP 7 ~ INSERT ITEMS 8 & 6 THRU ITEMS 2 & 3.  
 STEP 8 ~ SOLDER ITEM 12 TO ITEM 10.

ASS'Y No	ITEM 1
A-3575-1	LD-1091/PX-660
A-3575-2	LD-1449/PX-660

A-3075-A

REQ'D.	ITEM	PART NUMBER	DESCRIPTION	SYMBOL
	13	CJ-103-53	CHAIN, LADDER	
X	12	WL-100-4	WIRE, BUSS BAR TINNED	
2	11	SCBP0440SS6	SCREW, MACHINE	
2	10	TE-104-1	TERMINAL, LOCKING	
2	9	SLHV0440SS6	SCREW, SET (4-40)	
2	8	AX-359	INDICATOR, LIGHT ASSY	
2	7	PM-778	BRACKET, DIAL MOUNTING	
2	6	PX-663	BUSHING, MOUNTING CYLINDER	
1	5	GR-184	SPROCKET, WHEEL	
9	4	SCFP0256SS8	SCREW, MACHINE	
1	3	PM-784	BUSHING, CYLINDER MOUNTING	
1	2	PM-795	BUSHING, CYLINDER MOUNTING	
1	1	SEE CHART	DRUM CYLINDER	

MATERIAL		THE TECHNICAL MATERIEL CORP. MAMARONECK, NEW YORK	
FINISH		TITLE TUNER DIAL ASSEMBLY	
QTY/UNIT	MODEL USED ON	SCALE	CODE
1	HFR-1A/T	1	A-3074-2
1	HFR-1/T	1	A-3074-1
UNLESS OTHERWISE SPECIFIED DIMENSIONS ARE IN INCHES AND INCLUDE CHEMICALLY APPLIED OR PLATED FINISHES		DRAWN	DATE
DECIMALS .X ± .05		M. TANTILLO	5-16-62
FRACTIONS XX ± .01		CHECKED	DATE
ANGLES .XX ± .005		<i>File</i>	12/2/62
TOLERANCES ± 1/64		ELECT. DES.	DATE
± 0° 30'		<i>T. King</i>	
NOTES		MECH. DES.	DATE
THE CONTENTS OF THIS DRAWING ARE THE EXCLUSIVE PROPERTY OF THE TECHNICAL MATERIEL CORP. ITS UNAUTHORIZED USE OR REPRODUCTION IN WHOLE OR IN PART IS STRICTLY FORBIDDEN.		DATE	
		SHEET	1
		REV. LTR.	A