

A-2226

\* NOTE:

ITEMS 20 & 22 TO BE PUT ON ASSEMBLY ONLY IF ASSEMBLY IS REQUIRED FOR KIT-127. FOR STANDARD PRODUCTION, REMOVE ITEMS 20 & 22.

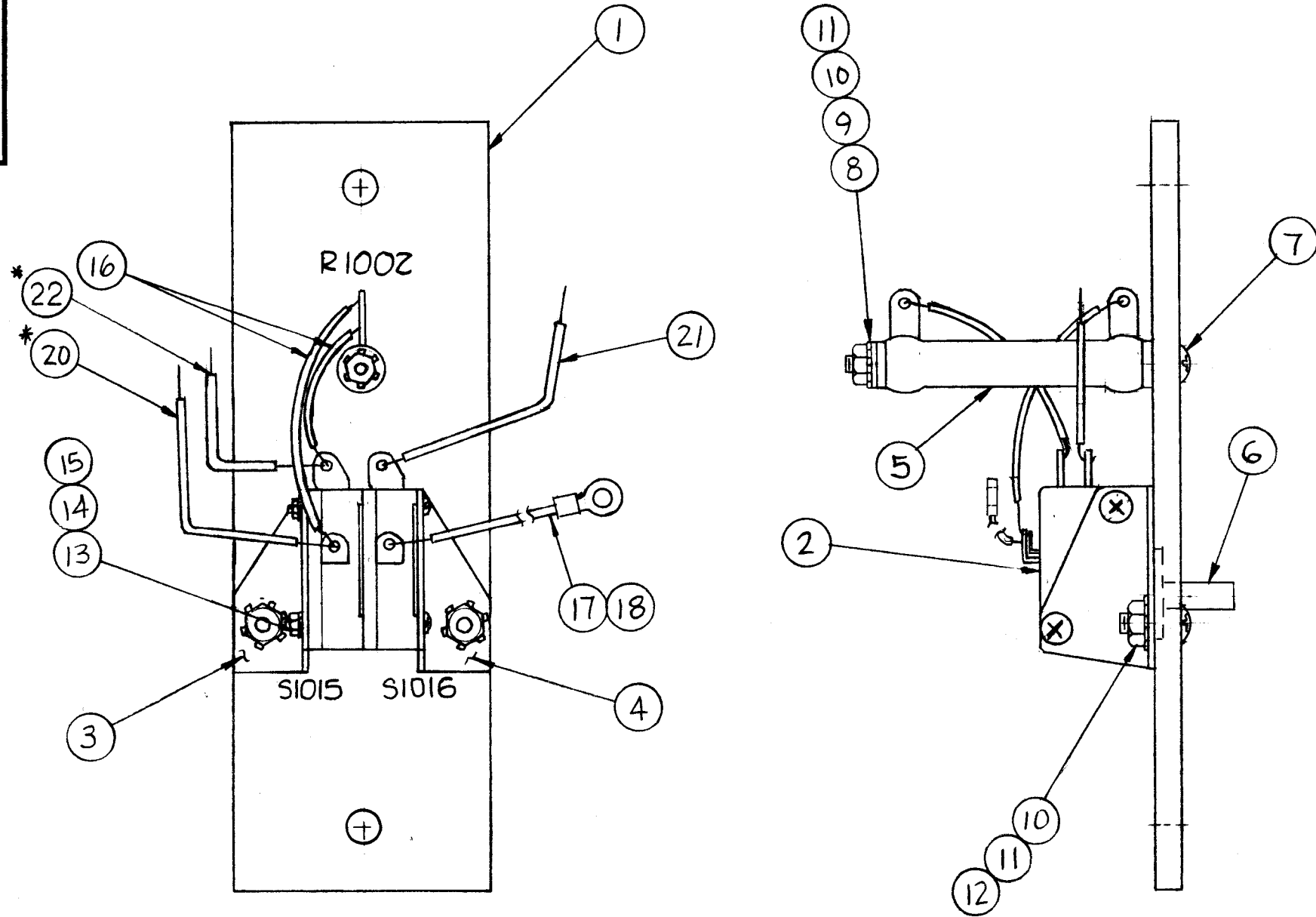

NOTICE TO PERSONS RECEIVING THIS DRAWING

THE TECHNICAL MATERIEL CORPORATION claims proprietary right in the intellectual disclosure herein. This drawing is issued in confidence for engineering information only and may not be reproduced or used to manufacture anything of our own design without permission from THE TECHNICAL MATERIEL CORPORATION to the user. This drawing is loaned for mutual assistance and is subject to recall at any time.

Property of:  
THE TECHNICAL MATERIEL CORPORATION  
MAMARONECK, NEW YORK

* 12"	22	MWC 22(7)U92	WIRE, ELECTRIC	WH/RED
8"	21	MWC 22(7)U2	WIRE, ELECTRIC	RED
* 12"	20	MWC 22(7)U92	WIRE, ELECTRIC	WH/RED
X	19	BS-100	SOLDER, SOFT	
1	18	TE-159-32960	TERMINAL, LUG #10	
3"	17	MWC 22(7)U2	WIRE, ELECTRIC	RED
4 <sup>3</sup> / <sub>4</sub>	16	MWC 22(7)U92	WIRE, ELECTRIC	WH/RED
2	15	NTH0440BN6	NUT, HEX	
2	14	LWE04MRN	WASHER, LOCK, EXTERNAL	
2	13	SCBP0440BN16	SCREW, MACHINE	
2	12	SCBP0632BN7	SCREW, MACHINE	
3	11	NTH0632BN8	NUT, HEX	
3	10	LWE06MRN	WASHER, LOCK, EXTERNAL	
1	9	FW06HBN	WASHER, FLAT	
2	8	WA-102-4	WASHER, FIBER, SHOLDER	
1	7	SCBP0632BN36	SCREW, MACHINE	
1	6	PM-729	PLUNGER, SWITCH ACTUATOR	
1	5	RW-109-42	RESISTOR, FIXED, WW	R100Z
1	4	MS-987	BRACKET, SWITCH MTG.	
1	3	MS-986	BRACKET, SWITCH MTG.	
2	2	SW-189	SWITCH, SENSITIVE	S1015 S1016
1	1	PX-638 (LD-1006)	BOARD SWITCH MTG.	

REQ. ITEM	PART NO.	DESCRIPTION	SYMBOL
		THE TECHNICAL MATERIEL CORP. MAMARONECK, NEW YORK	
STOCK SIZE		CIRCUIT BREAKER MICROSWITCH BOARD ASS'Y	
MATERIAL		AB	R100Z
TYPE & TEMPER		HEAT TREAT. SPEC.	DRAWN
			CHECKER
			FINAL APPROVAL
FINISH & SPEC. NO.		ELEC. DES. APP.	MECH. DES. APP.

SYM	DESCRIPTION	DATE	CH. NO.	DRAFTS	CHECKER	ENG. APP.
A	NOTE REVISED Item 22 Added, Item 21 Was 6 Req.	12-8-61	6000	EF	EF	EF

UNLESS OTHERWISE SPECIFIED:  
DIMENSIONS ARE IN INCHES  
TOLERANCES ON FRACTIONS ± 1/64 DECIMALS ± .005 ANGLES ± 1/2°

SCALE: Do Not Scale  
MAXIMUM ALLOWABLE TOLERANCES HAVE BEEN DETERMINED AND ANY DEVIATIONS WILL BE CAUSE FOR REJECTION.  
REMOVE ALL BURRS AND SHARP EDGES

REQ. PER UNIT	MODEL	SECTION	ASS'Y. NO.	DATE
1	GPT-10 K		AX-113	11-9-61
1	GPT-40R		AX-113	11-9-61

USED ON