

A-2160 D

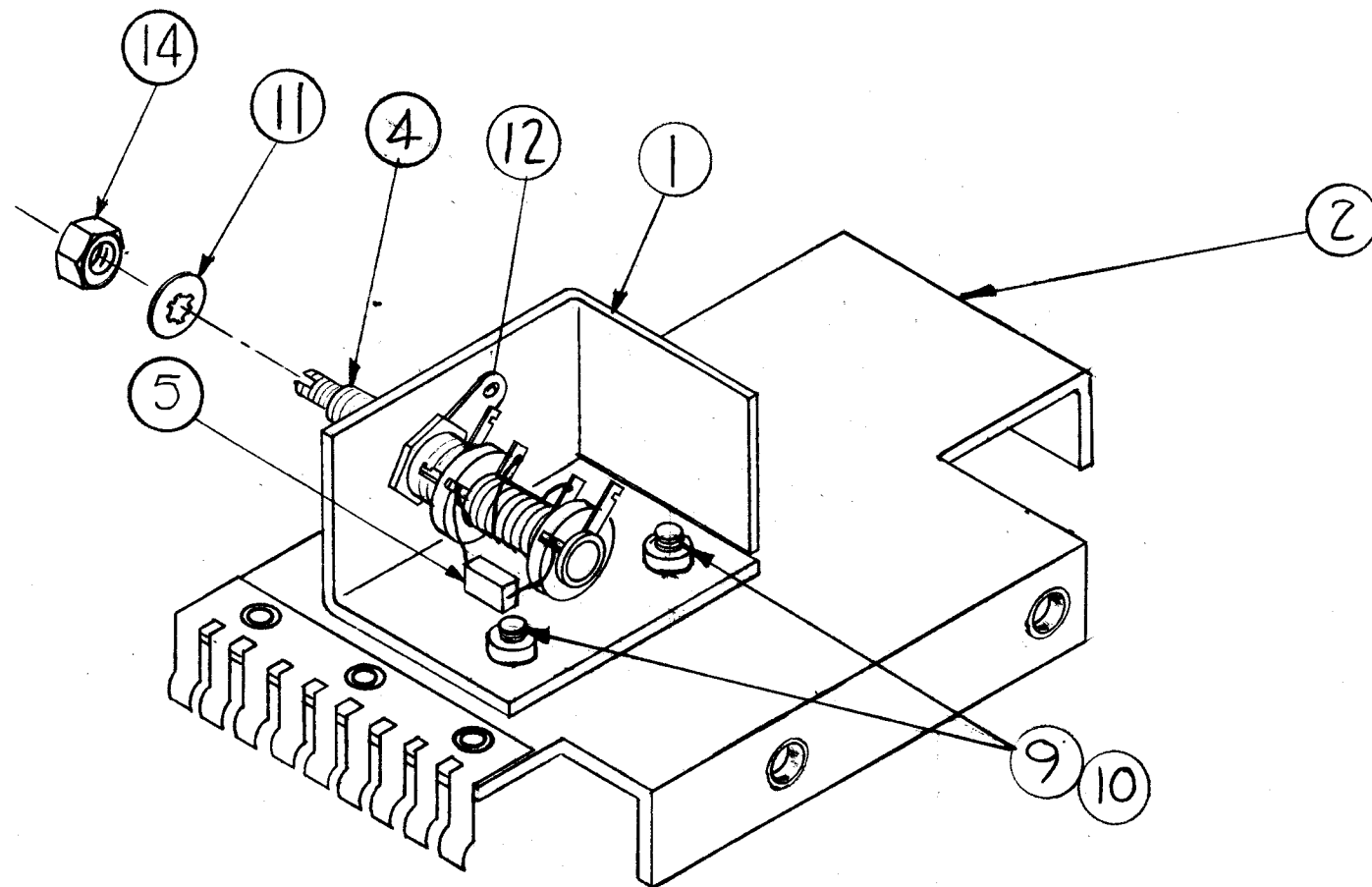

NOTICE TO PERSONS RECEIVING THIS DRAWING

THE TECHNICAL MATERIEL CORPORATION claims proprietary right in the material disclosed hereon. This drawing is issued in confidence for engineering information only and may not be reproduced or used to manufacture anything shown hereon without permission from THE TECHNICAL MATERIEL CORPORATION to the user. This drawing is loaned for mutual assistance and is subject to recall at any time.

Property of:
THE TECHNICAL MATERIEL CORPORATION
MAMARONECK, NEW YORK

| | | | | |
|-------------------|----------|----------------|--|---------------------------------|
| 1 | 14 | NTH0832BN8 | NUT, HEX, DOUBLE CHAMFER | |
| | 13 | --- | DELETED | |
| 1 | 12 | TE-104-3 | TERMINAL, LOCKING | |
| 1 | 11 | LW108MRN | LOCKWASHER, INTERNAL TOOTH | |
| 2 | 10 | SCFD0440BN4 | SCREW, MACHINE | |
| 2 | 9 | LW104MRN | LOCKWASHER, INTERNAL TOOTH | |
| # | 8 | --- | DELETED | |
| # | 7 | --- | DELETED | |
| # | 6 | --- | DELETED | |
| 1 | 5 | CM108821F | CAPACITOR, FIXED MICA | C210 |
| 1 | 4 | A-3106 | TT-188 ASSEMBLY | T129 |
| | 3 | --- | DELETED | |
| 1 | 2 | MS-2642 | SHIELD, IFO | |
| 1 | 1 | MS-2641 | BRACKET, COIL M.C. | |
| REQ. ITEM | PART NO. | | GELLMAN DESCRIPTION | SYMBOL |
| STOCK SIZE | | | THE TECHNICAL MATERIEL CORP. MAMARONECK, NEW YORK | |
| MATERIAL | | | IFO, SHIELD ASSY | |
| TYPE & TEMPER | | | DRAWN | CHECKER |
| HEAT TREAT. SPEC. | | | FINISH & SPEC. NO. | ELEC. DES. APP. MECH. DES. APP. |
| USED ON | | | A-2160 D | |

| | | | | | | |
|-----|--|----------|---------|--------|---------|-----------|
| D | T129 & C210 ADDED TO BUILDUP | 11-22-63 | 10466 | | | |
| C | IN PICT. ITEMS 9&10 CORRECTED | 9-6-63 | 9905 | AR | YAB | |
| B | ITEM(3) WAS FP-190, ITEM(13) WAS EY-100-1 | 8-7-63 | 9728 | AIC. | YAY | |
| A | ITEMS(9) & (10) WERE 1 REQ'D. PICTORIAL CLARIFIED ITEM(7) WAS TE-104-5, (8) WAS NTH2528BN14 ITEM(5) WAS CM108610001G, (6) WAS CR70A102M ITEM(1) & (2) REF. DELETED; (4) WAS AC-136 | 3-6-63 | 8366 | | | |
| SYM | DESCRIPTION | DATE | CH. NO. | DRAFTS | CHECKER | ENG. APP. |

UNLESS OTHERWISE SPECIFIED:
DIMENSIONS ARE IN INCHES
TOLERANCES ON FRACTIONS ± 1/64 DECIMALS ± .005 ANGLES ± 1/2°

SCALE:
MAXIMUM ALLOWABLE TOLERANCES HAVE BEEN DETERMINED AND ANY DEVIATIONS WILL BE CAUSE FOR REJECTION.
REMOVE ALL BURRS AND SHARP EDGES

| | | | |
|---------------|--------|---------|----------------|
| 1 | GPR-92 | IF | 8-30-61 |
| REQ. PER UNIT | MODEL | SECTION | ASSY. NO. DATE |