

A-1630 G

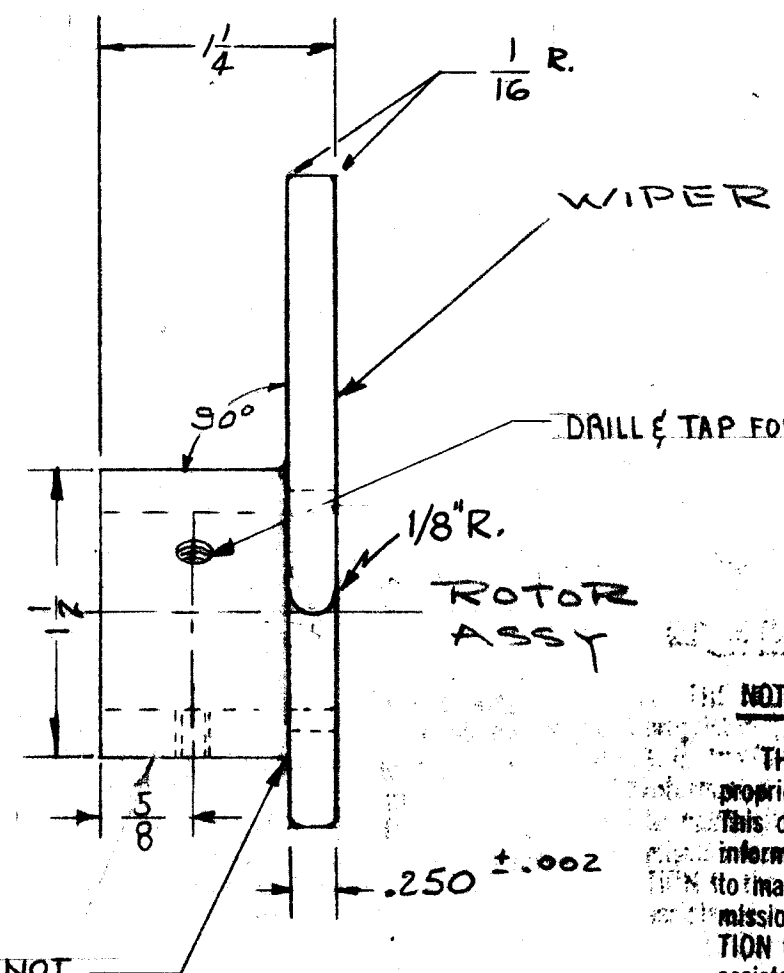
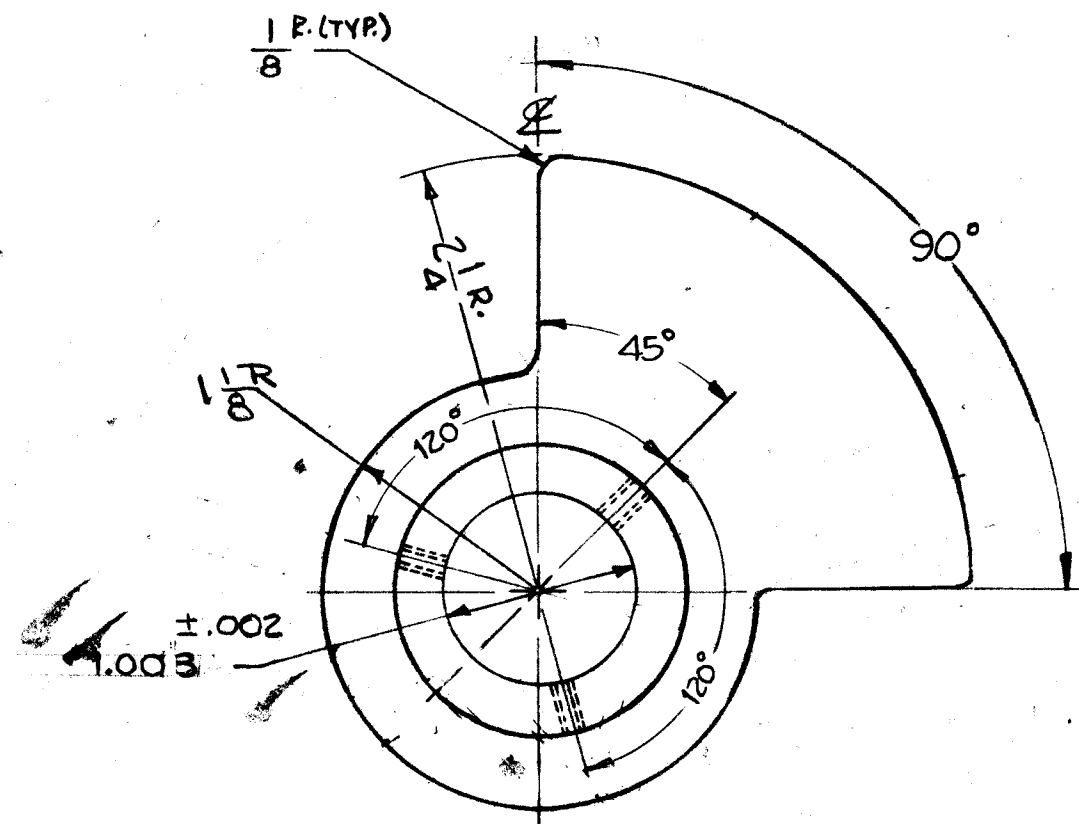

TYP. FILLET SHALL NOT EXCEED 1/32

**NOTICE TO PERSONS RECEIVING THIS DRAWING**  
 THE TECHNICAL MATERIEL CORPORATION claims proprietary right in the material disclosed hereon. This drawing is issued in confidence for engineering information only and may not be reproduced or used to manufacture anything shown hereon without permission from THE TECHNICAL MATERIEL CORPORATION to the user. This drawing is loaned for mutual assistance and is subject to recall at any time.

Property of:  
 THE TECHNICAL MATERIEL CORPORATION  
 MAMARONECK, NEW YORK

G	1	ADDED FILLET NOTE	6/22/64	11635	A.M.		
F	1	±.003 ±.002 WAS 1"	1/20/64	10767			
E	2	KEYWAY DELETED; 1/16" VIL R. ADDED	10-24-62	7469			
	1	±.003 ±.002 DIM WAS 1/4					
D	1	COMPLETELY REDESIGN	6-23-60	2545			
C	2	DRILL & TAP FOR 10-32 (3 REG) ADDED	1-28-60	1816			
	1	DIM. 5/8 ADDED					
B	1	Hub & Wiper Combined make 1 pc.	9/21/59	PR/21			
A		ADDED RADIUS CUT	4/17/50	820			
ISSUE	ITEM	CHANGED FROM	DATE	CH. NO.	DRAFTS	CHECKER	ENG. APP.
TOLERANCES		SCALE: <i>1/4"</i>					
DIM. ± 1/4 AS NOTED		MAXIMUM ALLOWABLE TOLERANCES HAVE BEEN DETERMINED AND ANY DEVIATIONS WILL BE CAUSE FOR REJECTION: REMOVE ALL BURRS AND SHARP EDGES					
DIM. ± 1/64							
AR DIM. ± 0.5°							

REQ. PER UNIT	1	MODEL	GPT-10K	PROJECT NO.	AS-119	ASSY. NO.	A-2178	DATE	2-6-53
USED ON									

REQ.	ITEM	PART NO.	DESCRIPTION	SYMBOL
			THE TECHNICAL MATERIEL CORP. MAMARONECK, NEW YORK	
		STOCK SIZE		
		BRASS	AX-15B ASSY.	
		MATERIAL	(PABANDSWITCH ROTOR ASSY.)	
			acc	
			J.D.	
			Alb	
		TYPE & TEMPER	HEAT TREAT. SPEC.	DRAWN
		BRASS		CHECKED
		FINISH & SPEC. NO.		FINAL APPROV.
				28
				A-1630 G
			ELEC. DES. APP	MECH. DES. APP

A-1639 G

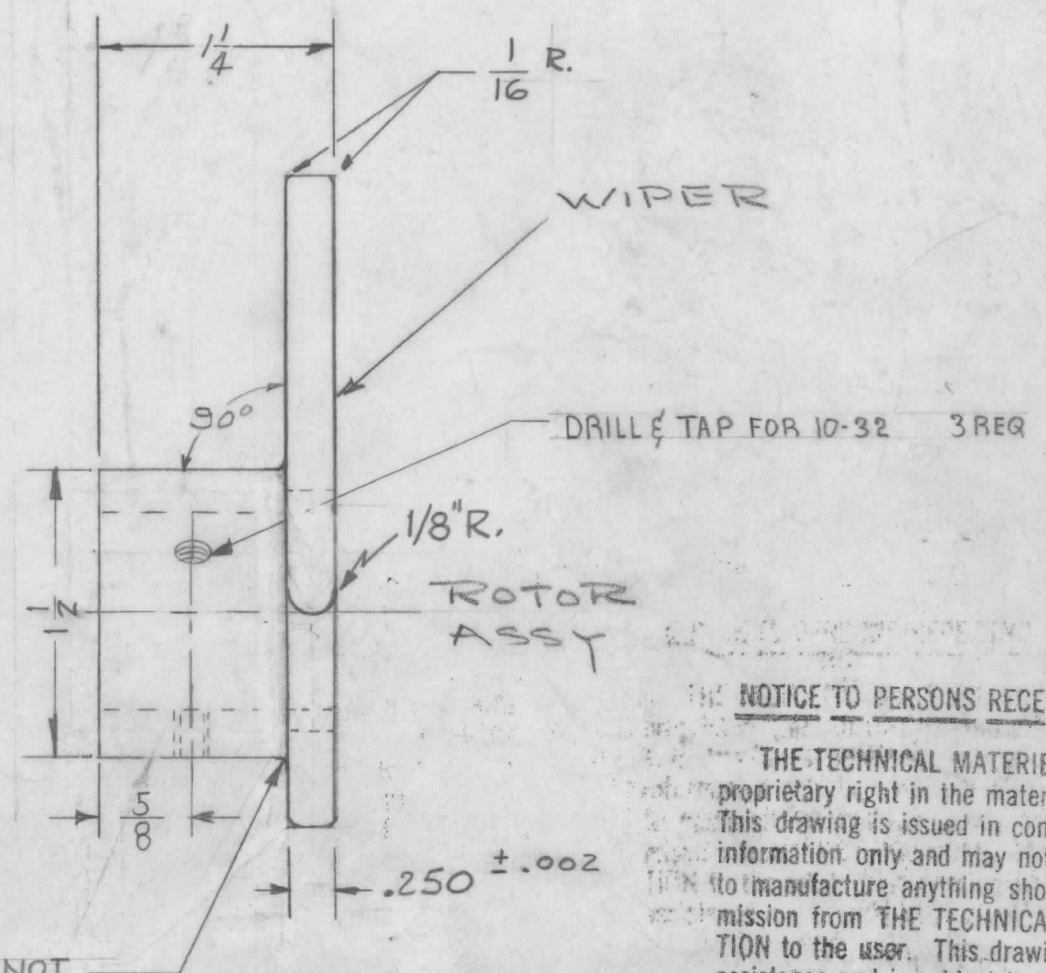
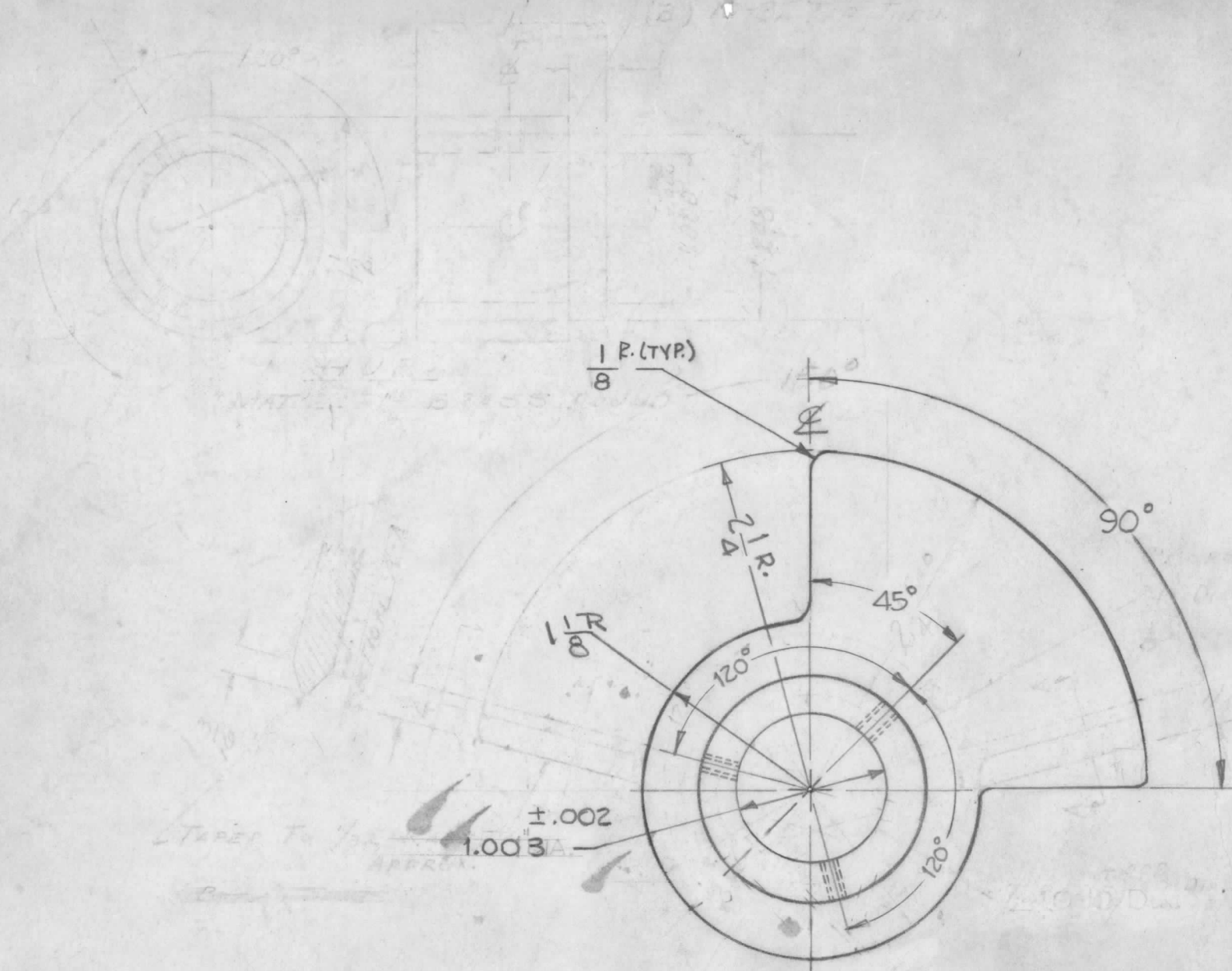

NOTICE TO PERSONS RECEIVING THIS DRAWING  
 THE TECHNICAL MATERIEL CORPORATION claims proprietary right in the material disclosed herein. This drawing is issued in confidence for engineering information only and may not be reproduced or used to manufacture anything shown hereon without permission from THE TECHNICAL MATERIEL CORPORATION to the user. This drawing is loaned for mutual assistance and is subject to recall at any time.

Property of:  
 THE TECHNICAL MATERIEL CORPORATION  
 MAMARONECK, NEW YORK

G	1	ADDED FILLET NOTE	6/22/64	11635	A.M.	asc	asc
F	1	1.003 ± .002 WAS 1"	1/20/64	10767	DM	asc	asc
E	2	KEYWAY DELETED; 1/8" VILR. ADDED	10-24-62	7469	DM	asc	asc
	1	.750 ± .002 DIM WAS V4					
D	1	COMPLETELY REDESIGN	6-23-60	2545	DM	asc	asc
C	2	DRILL & TAP FOR 10-32 (3REQ) ADDED	1-28-60	1816	DM	asc	asc
	1	DIM. 5/8 ADDED					
B	1	Hub & Wiper Combined make 1pc.	9/21/59	PR/21	DM	asc	asc
A		ADDED RADIUS CUT	2/19/59	820	DM	asc	asc

ISSUE ITEM		CHANGED FROM	DATE	CH. NO.	DRAFTS	CHECKER	ENG. APP.
TOLERANCES		SCALE: <i>1/4"</i>					
DIM. ± .0002		MAXIMUM ALLOWABLE TOLERANCES HAVE BEEN DETERMINED AND ANY DEVIATIONS WILL BE CAUSE FOR REJECTION:					
DIM. ± 1/64		REMOVE ALL BURRS AND SHARP EDGES					
AR DIM. ± 0.5°							

REQ. PER UNIT	1	MODEL	GPT-10K	PROJECT NO.	AS-119 - EK	ASSY. NO.	A-2178	DATE	2-6-59
USED ON									

REQ. ITEM	PART NO.	DESCRIPTION	SYMBOL
		THE TECHNICAL MATERIEL CORP.	
		MAMARONECK, NEW YORK	
STOCK SIZE			
BRASS		MAX-158 ASSY.	
MATERIAL		(PABANDSWITCH ROTOR ASSY.)	
		asc	asc
TYPE & TEMPER		HEAT TREAT. SPEC.	DRAWN
RHODIUM .000025			CHECKED
FINISH & SPEC. NO.		ELEC. DES. APP.	MECH. DES. APP.
		2B	A-1639 G