

IF IT IS FOUND DESIRABLE TO CHANGE ANY TOLERANCE OR OTHER DETAIL SPECIFIED ON THIS DRAWING NOTIFY THE PURCHASER PROMPTLY.  
 MAXIMUM ALLOWABLE TOLERANCES HAVE BEEN DETERMINED AND DEVIATIONS WILL BE CAUSE FOR REJECTION. REMOVE ALL BURRS AND SHARP EDGES

**NOTICE TO PERSONS RECEIVING THIS DRAWING**

THE TECHNICAL MATERIEL CORPORATION claims proprietary right in the mechanical disclosed herein. This drawing is issued in confidence and is for information only and may not be reproduced or used to manufacture any part shown herein without permission from THE TECHNICAL MATERIEL CORPORATION to the user. This drawing is loaned for mutual assistance and is subject to recall at any time.

Property of:  
 THE TECHNICAL MATERIEL CORPORATION  
 MAMARONECK, NEW YORK

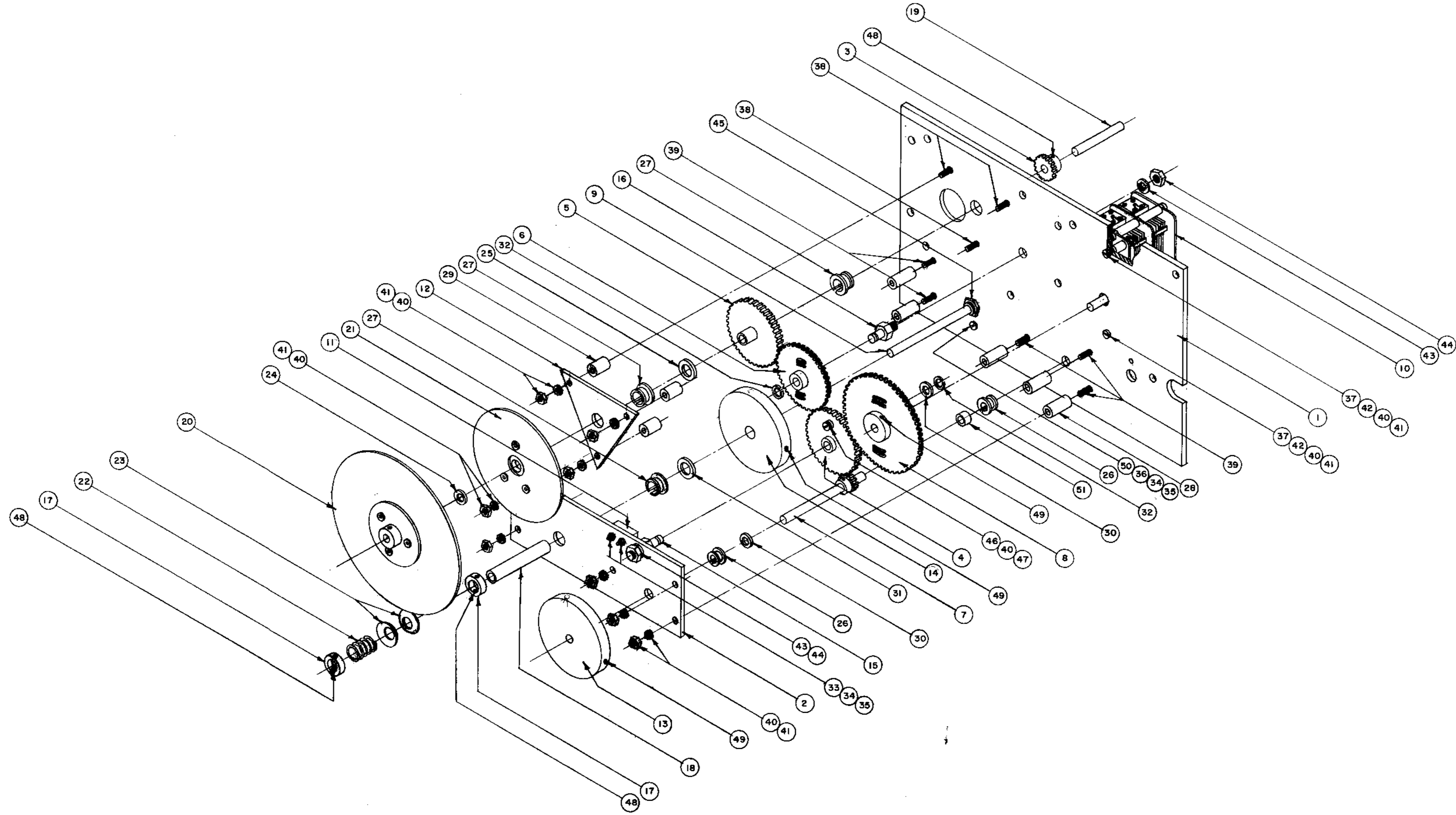

REQ. ITEM	PART NO.	DESCRIPTION	BYMBOL
1	51	PM-454-21 SHAFT, HOLLOW	
1	50	SCBS0440BC8 SCREW, MACHINE	
6	49	AN56506-H3 SCREW, HEADLESS SET	
6	48	AN56506-H2 SCREW, HEADLESS SET	
1	47	TE-117-25 STAND-OFF SPACER (5/32 LG.)	
1	46	SCBS0632BC6 SCREW, MACHINE	
1	45	NTH3732BC16 NUT, HEX.	
2	44	NTH2528BC14 NUT, HEX.	
2	43	LW125MRC LOCKWASHER, INT.	
2	42	TE-117-2 STAND-OFF SPACER (3/8 LG.)	
10	41	NTH0632BC NUT, HEX.	
11	40	LWEO6MRC LOCKWASHER, EXT.	
5	39	SCFS0632BC17 SCREW, MACHINE	
3	38	SCFS0632BC14 SCREW, MACHINE	
2	37	SCBS0632BC12 SCREW, MACHINE	
1	36	TE-117-22 STAND-OFF SPACER (1/8 LG.)	
3	35	NTH0440BC8 NUT, HEX.	
3	34	LWEO4MRC LOCKWASHER, EXT.	
2	33	SCFS0440BC8 SCREW, MACHINE	
2	32	WA-112 RING, RETAINING	
1	31	FW37LBC WASHER, FLAT (.062 THK.)	
2	30	FW25LBC WASHER, FLAT (.031 THK.)	
3	29	TE-117-13 STAND-OFF SPACER (1/2 LG.)	
5	28	TE-117-24 STAND-OFF SPACER (1/16 LG.)	
3	27	BB-117-10 PANEL BEARING, NYLON (3/8 I.D.)	
2	26	BB-117-6 PANEL BEARING, NYLON (1/4 I.D.)	
1	25	BB-106-3 BEARING, THRUST (1/32 THK.)	
1	24	BB-106-1 BEARING, THRUST (1/16 THK.)	
2	23	WA-129 WASHER, FRICTION	
1	22	SP-128 SPRING, FRICTION DRIVE	
1	21	A-1442 MF DIAL ASS'Y.	
1	20	A-1439 RF DIAL ASS'Y.	
1	19	PM-691 RF I.BIB SHAFT, .250 D.	
1	18	PM-454-2.18 SHAFT, HOLLOW	
2	17	PM-457-1 COLLAR, FRICTION DRIVE	
1	16	PM-470 SHAFT, GEAR (GR-133)	
1	15	PM-452-1 SHAFT, GEAR (GR-131)	
1	14	PM-453 MACHINING, INERTIA WHEEL (3/8 I.D.)	
1	13	PM-416 MACHINING, INERTIA WHEEL (1/4 I.D.)	
1	12	MS-1101 SUPPORT PLATE, GEAR	
1	11	MS-1100 STOP BLOCK, GEAR	
1	10	CB-127 CAPACITOR, VARIABLE C167	
1	9	SW-201 SWITCH INDEX	
1	8	GR-135 GEAR, SPLIT, 3.00" PD.	
1	7	A-1456 MF DIAL SHAFT ASS'Y. (GR-134)	
1	6	GR-133 GEAR, SPLIT, 2.00" PD.	
1	5	GR-132 GEAR, SPUR, 2.00" PD. (SPECIAL HUB)	
1	4	GR-131 GEAR, SPUR, 2.00" PD.	
1	3	GR-129 GEAR, SPUR, .750" PD.	
1	2	MS-1104 GEAR PLATE, SUB	
1	1	MS-1103 GEAR PLATE, MAIN	

A-1487 A

2	17M(19) WAS PM-452	2/14/44	5279	GDL	RLL	PM
1	17M(19) WAS PM-453-1.81B					
ISSUE ITEM	CHANGED FROM	DATE	CH. NO.	DRAWN	CHECKER	ENG. APP.
TOLERANCES						
ALL	DEC. DIM. ±	SCALE: 1/2				
OTHERS	FRACTIONAL DIM. ±	DRILL, PUNCH, COMMERCIAL STOCK				
	ANGULAR DIM. ±	SIZES AND MANUFACTURERS				
		TOLERANCES ARE NOT INCLUDED.				

1	SBE-1	PROJECT NO.	ASBY. NO.	DATE
REQ. PER UNIT	MODEL	USED ON		

THE TECHNICAL MATERIEL CORP. MAMARONECK, NEW YORK	
MAIN GEAR ASSEMBLY	
SBE-1	
LG 11-26-57	
DRAWN	MECH. DES. APP.
CHECKED	FINAL APPROVAL
A-1487 A	