

IF IT IS FOUND DESIRABLE TO CHANGE ANY TOLERANCE OR OTHER DETAIL SPECIFIED ON THIS DRAWING NOTIFY THE PURCHASER PROMPTLY.
 MAXIMUM ALLOWABLE TOLERANCES HAVE BEEN DETERMINED AND DEVIATIONS WILL BE CAUSE FOR REJECTION. REMOVE ALL BURRS AND SHARP EDGES

NOTICE TO PERSONS RECEIVING THIS DRAWING

THE TECHNICAL MATERIEL CORPORATION claims proprietary right in the mechanical disclosed herein. This drawing is issued in confidence and is for information only and may not be reproduced or used to manufacture any part shown herein without permission from THE TECHNICAL MATERIEL CORPORATION to the user. This drawing is loaned for mutual assistance and is subject to recall at any time.

Property of:
 THE TECHNICAL MATERIEL CORPORATION
 MAMARONECK, NEW YORK

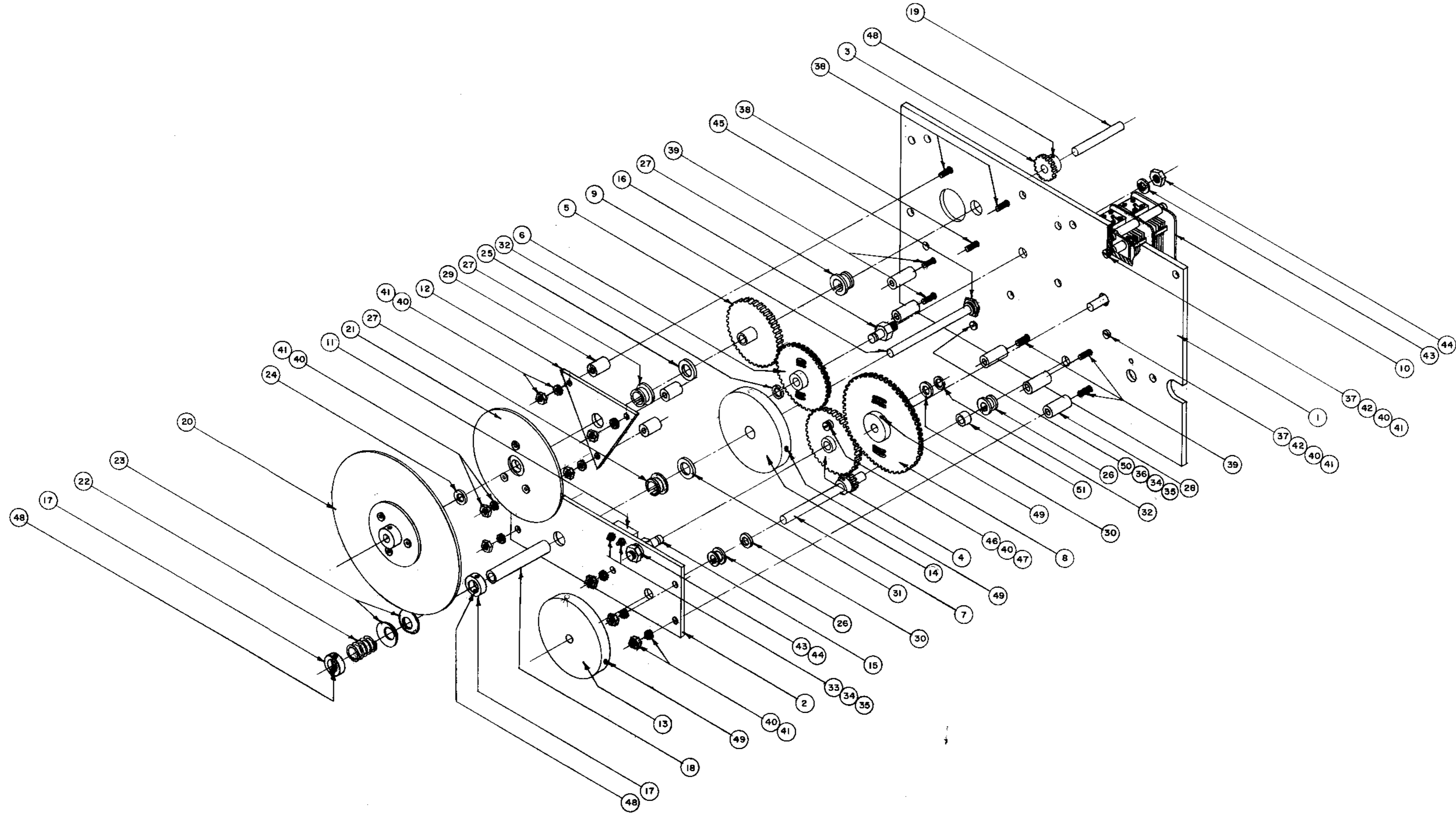

1	51	PM-454-21	SHAFT, HOLLOW	
1	50	SCBS0440BC8	SCREW, MACHINE	
6	49	AN56506-H3	SCREW, HEADLESS SET	
6	48	AN56506-H2	SCREW, HEADLESS SET	
1	47	TE-117-25	STAND-OFF SPACER (5/32 LG.)	
1	46	SCBS0632BC6	SCREW, MACHINE	
1	45	NTH3732BC16	NUT, HEX.	
2	44	NTH2528BC14	NUT, HEX.	
2	43	LW125MRC	LOCKWASHER, INT.	
2	42	TE-117-2	STAND-OFF SPACER (3/8 LG.)	
10	41	NTH0632BC	NUT, HEX.	
11	40	LWEO6MRC	LOCKWASHER, EXT.	
5	39	SCFS0632BC17	SCREW, MACHINE	
3	38	SCFS0632BC14	SCREW, MACHINE	
2	37	SCBS0632BC12	SCREW, MACHINE	
1	36	TE-117-22	STAND-OFF SPACER (1/8 LG.)	
3	35	NTH0440BC8	NUT, HEX.	
3	34	LWEO4MRC	LOCKWASHER, EXT.	
2	33	SCFS0440BC8	SCREW, MACHINE	
2	32	WA-112	RING, RETAINING	
1	31	FW37LBC	WASHER, FLAT (.062 THK.)	
2	30	FW25LBC	WASHER, FLAT (.031 THK.)	
3	29	TE-117-13	STAND-OFF SPACER (1/2 LG.)	
5	28	TE-117-24	STAND-OFF SPACER (1/16 LG.)	
3	27	BB-117-10	PANEL BEARING, NYLON (3/8 I.D.)	
2	26	BB-117-6	PANEL BEARING, NYLON (1/4 I.D.)	
1	25	BB-106-3	BEARING, THRUST (1/32 THK.)	
1	24	BB-106-1	BEARING, THRUST (1/16 THK.)	
2	23	WA-129	WASHER, FRICTION	
1	22	SP-128	SPRING, FRICTION DRIVE	
1	21	A-1442	MF DIAL ASS'Y.	
1	20	A-1439	RF DIAL ASS'Y.	
1	19	PM-691 RF 1.B1B	SHAFT, .250 D.	
1	18	PM-454-2.18	SHAFT, HOLLOW	
2	17	PM-457-1	COLLAR, FRICTION DRIVE	
1	16	PM-470	SHAFT, GEAR (GR-133)	
1	15	PM-452-1	SHAFT, GEAR (GR-131)	
1	14	PM-453	MACHINING, INERTIA WHEEL (3/8 I.D.)	
1	13	PM-416	MACHINING, INERTIA WHEEL (1/4 I.D.)	
1	12	MS-1101	SUPPORT PLATE, GEAR	
1	11	MS-1100	STOP BLOCK, GEAR	
1	10	CB-127	CAPACITOR, VARIABLE	C167
1	9	SW-201	SWITCH INDEX	
1	8	GR-135	GEAR, SPLIT, 3.00" PD.	
1	7	A-1456	MF DIAL SHAFT ASS'Y. (GR-134)	
1	6	GR-133	GEAR, SPLIT, 2.00" PD.	
1	5	GR-132	GEAR, SPUR, 2.00" PD. (SPECIAL HUB)	
1	4	GR-131	GEAR, SPUR, 2.00" PD.	
1	3	GR-129	GEAR, SPUR, .750" PD.	
1	2	MS-1104	GEAR PLATE, SUB	
1	1	MS-1103	GEAR PLATE, MAIN	

A-1487 A

2	17M(19) WAS PM-452	2/19/44	5279	BDL	RLU/PM	
1	17M(19) WAS PM-453-1.81B					
ISSUE ITEM	CHANGED FROM	DATE	CH. NO.	DRAWN	CHECKER	ENG. APP.
TOLERANCES						
ALL	DEC. DIM. ±	SCALE: 1/2				
OTHERS	ANGULAR DIM. ±	DRILL, PUNCH, COMMERCIAL STOCK SIZES AND MANUFACTURERS TOLERANCES ARE NOT INCLUDED.				

1	SBE-1	PROJECT NO.	ASBY. NO.	DATE
REQ. PER UNIT				11-26-57
USED ON				

THE TECHNICAL MATERIEL CORP. MAMARONECK, NEW YORK			
MAIN GEAR ASSEMBLY			
SBE-1			
LG 11-26-57			
DRAWN		MECH. DES. APP.	
CHECKED		FINAL APPROVAL	
HEAT TREAT. SPEC.		FINISH & SPEC. NO.	
A-1487 A			

IF IT IS FOUND DESIRABLE TO CHANGE ANY TOLERANCE OR OTHER DETAIL SPECIFIED ON THIS DRAWING NOTIFY THE PURCHASER PROMPTLY.
 MAXIMUM ALLOWABLE TOLERANCES HAVE BEEN DETERMINED AND DEVIATIONS WILL BE CAUSE FOR REJECTION. REMOVE ALL BURRS AND SHARP EDGES

NOTICE TO PERSONS RECEIVING THIS DRAWING

THE TECHNICAL MATERIEL CORPORATION claims proprietary right in the material disclosed hereon. This drawing is issued in confidence for engineering information only and may not be reproduced or used to manufacture any thing shown hereon without permission from THE TECHNICAL MATERIEL CORPORATION to the user. This drawing is loaned for mutual assistance and is subject to recall at any time.

Property of:
 THE TECHNICAL MATERIEL CORPORATION
 MAMARONECK, NEW YORK

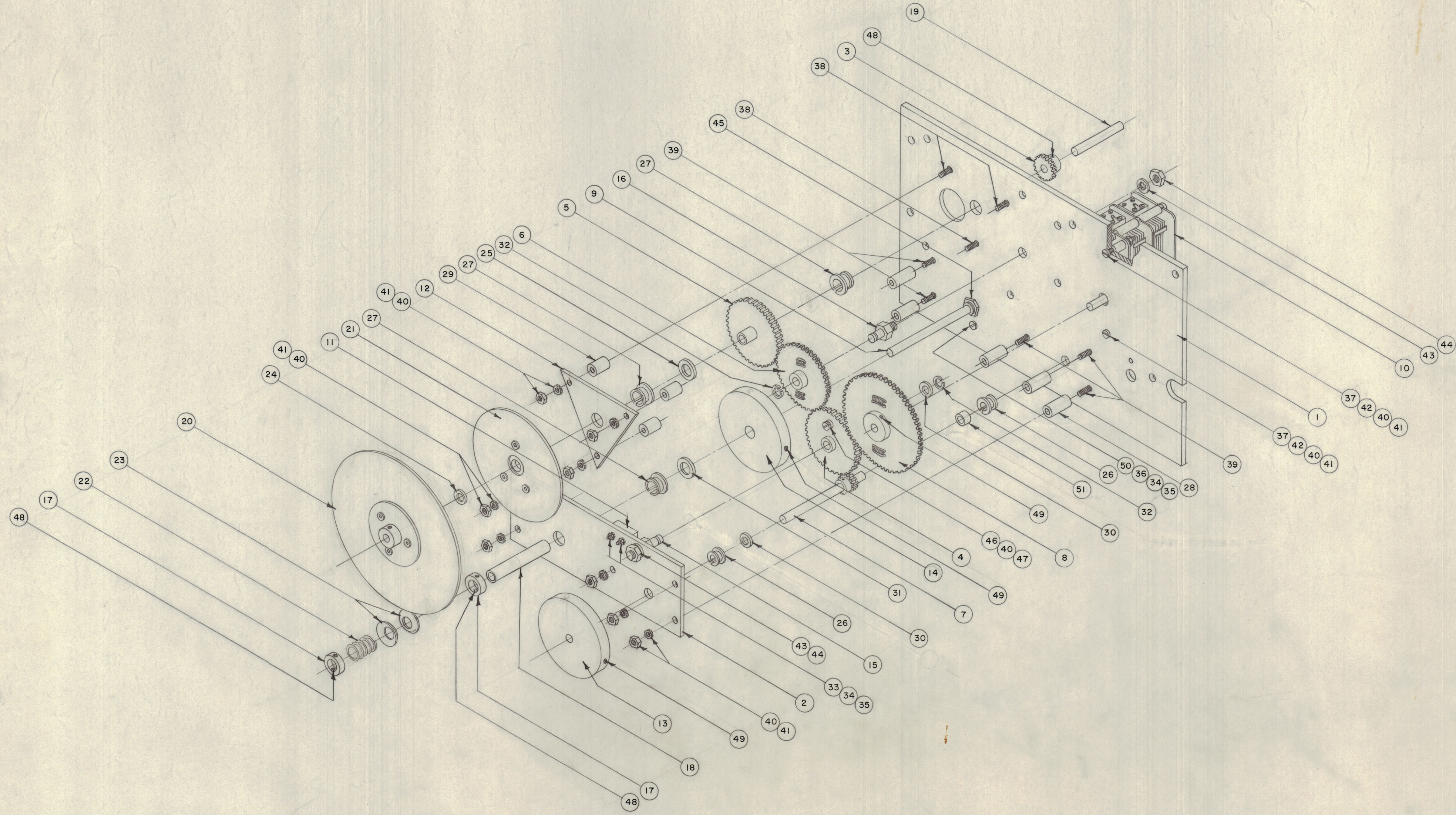

REQ. ITEM	PART NO.	DESCRIPTION	SYMBOL
1	51	PM-454-21 SHAFT, HOLLOW	
1	50	SCBS0440BC8 SCREW, MACHINE	
6	49	AN565D6-H3 SCREW, HEADLESS SET	
6	48	AN565D6-H2 SCREW, HEADLESS SET	
1	47	TE-117-25 STAND-OFF SPACER (5/32 LG.)	
1	46	SCBS0632BC6 SCREW, MACHINE	
1	45	NTH3732BC16 NUT, HEX.	
2	44	NTH2528BC14 NUT, HEX.	
2	43	LW125MRC LOCKWASHER, INT.	
2	42	TE-117-2 STAND-OFF SPACER (3/8 LG.)	
10	41	NTH0632BC NUT, HEX.	
11	40	LWE06MRC LOCKWASHER, EXT.	
5	39	SCFS0632BC17 SCREW, MACHINE	
3	38	SCFS0632BC14 SCREW, MACHINE	
2	37	SCBS0632BC12 SCREW, MACHINE	
1	36	TE-117-22 STAND-OFF SPACER (1/8 LG.)	
3	35	NTH0440BC8 NUT, HEX.	
3	34	LWE04MRC LOCKWASHER, EXT.	
2	33	SCFS0440BC8 SCREW, MACHINE	
2	32	WA-112 RING, RETAINING	
1	31	FW37LBC WASHER, FLAT (.062 THK.)	
2	30	FW25LBC WASHER, FLAT (.031 THK.)	
3	29	TE-117-13 STAND-OFF SPACER (1/2 LG.)	
5	28	TE-117-24 STAND-OFF SPACER (11/16 LG.)	
3	27	BB-117-10 PANEL BEARING, NYLON (3/8 I.D.)	
2	26	BB-117-6 PANEL BEARING, NYLON (1/4 I.D.)	
1	25	BB-106-3 BEARING, THRUST (1/32 THK.)	
1	24	BB-106-1 BEARING, THRUST (1/16 THK.)	
2	23	WA-129 WASHER, FRICTION	
1	22	SP-128 SPRING, FRICTION DRIVE	
1	21	A-1442 MF DIAL ASS'Y.	
1	20	A-1439 RF DIAL ASS'Y.	
1	19	PM-691 RF 1.818 SHAFT, .250 D.	
1	18	PM-454-2.18 SHAFT, HOLLOW	
2	17	PM-457-1 COLLAR, FRICTION DRIVE	
1	16	PM-470 SHAFT, GEAR (GR-133)	
1	15	PM-452-1 SHAFT, GEAR (GR-131)	
1	14	PM-453 MACHINING, INERTIA WHEEL (3/8 I.D.)	
1	13	PM-416 MACHINING, INERTIA WHEEL (1/4 I.D.)	
1	12	MS-1101 SUPPORT PLATE, GEAR	
1	11	MS-1100 STOP BLOCK, GEAR	
1	10	CB-127 CAPACITOR, VARIABLE C167	
1	9	SW-201 SWITCH INDEX	
1	8	GR-135 GEAR, SPLIT, 3.00" PD.	
1	7	A-1456 MF DIAL SHAFT ASS'Y. (GR-134)	
1	6	GR-133 GEAR, SPLIT, 2.00" PD.	
1	5	GR-132 GEAR, SPUR, 2.00" PD. (SPECIAL HUB)	
1	4	GR-131 GEAR, SPUR, 2.00" PD.	
1	3	GR-129 GEAR, SPUR, .750" PD.	
1	2	MS-1104 GEAR PLATE, SUB	
1	1	MS-1103 GEAR PLATE, MAIN	

A-1487 A

ISSUE	ITEM	CHANGED FROM	DATE	CN. NO.	DRAFTS	CHECKER	ENG. APP.
A	2	ITEM (15) WAS PM-452	7-10-44	5279	GDL	RUJ	PM
A	1	ITEM (19) WAS PM-459-1.818					

TOLERANCES: ALL DEC. DIM. ±, FRAC. DIM. ±, ANGULAR DIM. ±. SCALE: 1/2. DRILL PUNCH, COMMERCIAL STOCK SIZES AND MANUFACTURERS TOLERANCES ARE NOT INCLUDED.

1	SBE-1	PROJECT NO.	ASSY. NO.	DATE
				11-26-57

THE TECHNICAL MATERIEL CORP.
 MAMARONECK, NEW YORK
 MAIN GEAR ASSEMBLY
 SBE-1

LG 11-26-57
 DRAWN: [Signature] ELEC. DES. APP. [Signature] MECH. DES. APP. [Signature]
 CHECKED: [Signature] FINAL APPROVAL: [Signature]

FINISH & SPEC. NO. A-1487 A